

DR[®] **WHISPER LITE**[®]

CORDLESS Electric Mower

Safety & Operating Instructions

MODEL: CEM1000



Please read through these Operating Instructions and become familiar with the basic features of the DR[®] WHISPER LITE[®] CORDLESS Electric Mower before operating it.

Important Safety Instructions

▲ WARNING: We want you to enjoy years of safe and productive use from your DR[®] WHISPER LITE[®] CORDLESS Electric Mower. We don't want you to get injured, so please take a few moments to read the following guidelines for safely operating your new machine.

READ THESE INSTRUCTIONS

Protect those around you

- Do not allow children, other bystanders or pets in your work area when the mower is being operated.
- Only adults and teenagers with a thorough understanding of these instructions should operate the mower.

Preparation

- Use safety glasses. Always use a face or dust mask if operating in dusty conditions.
- Dress appropriately. Always wear substantial footwear and long pants. Do not wear loose clothing or jewelry. They can get caught in the moving parts.
- Be thoroughly familiar with the controls and proper use of the DR[®] WHISPER LITE[®].
- Do not operate the mower without the proper side chute or mulch cover in place. Use of accessories not recommended in the manual may increase the risk of injury.
- Never operate the DR[®] WHISPER LITE[®] mower without the proper guards, safety switches or other safety protective devices in place and properly connected. Inspect to determine that these safety devices are properly installed, in good repair, and operate properly. If the condition or operation of these devices is questionable, they must be repaired or replaced before using the mower.
- Objects struck by the lawn mower blade can cause severe injuries. Thoroughly inspect the area where the mower is to be used and remove all stones, sticks, wire, dog bones, pet supplies or lawn toys, and other foreign objects which could be thrown by the mower blade. Also note the location of holes, stumps and other possible hazards.
- Mow only in daylight or in good artificial light.
- Never operate the mower in wet grass or in the rain. Wet conditions can be slippery.

Operation

- The length of time that a battery can hold its charge while mowing a lawn depends upon lawn conditions; tall, thick, or wet grass make the mower work harder and the battery discharge faster.
- Before starting the mower, adjust the cutting height to cut 1" to 2" of grass at a time. Cut thicker grass at a greater cutting height, or cut a narrower swath. Do not force the lawn mower forward in thick grass. The DR[®] WHISPER LITE[®] will do a better and safer job when cutting at a steady rate.
- Stop the blade whenever you leave the operating position (behind the handlebar) for any reason, including clearing grass and making any adjustments, repairs or inspections to the mower.
- Before cleaning, repairing, inspecting, adjusting the height of the cut, or exchanging the mulching cover and side discharge chute, remove the battery pack and make certain the blade has stopped.
- Look behind you before pulling the mower backwards to avoid falling.

(Operation, continued)

- Mow across slopes, never up and down. Exercise caution when changing directions on slopes. Do not mow steep slopes or other areas where stability or traction is in doubt.
- Do not put your hands and feet near or under rotating parts. Keep clear of the discharge area while the motor is running.
- Stop the blade when crossing over loose materials such as gravel drives, walks or roads. Objects discharged by the mower can be hazardous.
- Do not use the DR[®] WHISPER LITE[®] for any job other than those for which it is intended.
- Do not overreach—keep proper footing and balance at all times.
- After striking a foreign object or if mower vibrates abnormally, stop the blade and remove the battery pack. Inspect the mower for any damage and repair the damage before restarting and operating the lawn mower. Vibration is generally a sign of trouble.
- Stay alert and watch what you are doing. Do not operate the lawn mower when you are tired or under the influence of drugs or alcohol.

Maintenance and Storage

- Maintain the lawn mower with care—keep cutting edges sharp and clean for the best and safest performance. Be sure the mower is in safe operating condition. Keep all nuts, bolts and screws tight. Follow the instructions in this manual for changing accessories.
- When not in use, store the lawn mower indoors in a dry place and out of the reach of children.
- Keep mower handlebars dry and free from oil and grease.
- To reduce fire hazard, keep mower free of grass, leaves or excessive grease.
- Use identical replacement blades only. Check the blade and motor mounting bolts at frequent intervals for proper tightness.
- Have your mower inspected and serviced each year by an authorized Briggs & Stratton service center. Please call Country Home Products[®] and we will pre-arrange a visit to an authorized service center. Not all Briggs and Stratton service centers are knowledgeable about this mower. You can also send the mower to the Service Department at Country Home Products[®] for the above mentioned service.
- Factory specified Briggs & Stratton replacement parts should be used to assure adequate protection against injury (available from COUNTRY HOME PRODUCTS[®]).

Battery Safety

- Use only part #CEP1003 replacement battery pack (available from Country Home Products[®]).
- Do not charge the lawn mower battery in the rain or in wet locations.
- Exercise care in handling the batteries in order not to short the battery with conducting materials such as rings, bracelets and keys. The battery or conductor may overheat and cause burns.
- Do not attempt to replace individual batteries inside the battery pack. Mixing fresh and discharged batteries could increase internal cell pressure and rupture the discharged battery. Improper wiring within the battery pack could result in leakage or explosion.
- Batteries that can no longer accept a charge should be returned to an authorized Briggs & Stratton service center or a local recycling center. Do not dispose of batteries in a fire: the battery cells may explode. Do not open or mutilate the batteries. Released electrolyte (battery acid) is corrosive and will cause damage to eyes, skin or clothes. Battery acid is toxic if swallowed or if the fumes are inhaled.

SAVE THESE INSTRUCTIONS

THANK YOU!

And congratulations on your purchase of a new DR[®] WHISPER LITE[®] CORDLESS Electric Mower!

We have done our utmost to ensure that your DR[®] WHISPER LITE[®] will be one of the most trouble-free and satisfying pieces of equipment you have ever owned. Please let us know of any questions or problems you may have. We want to answer or correct them as quickly as possible. (When you do call or write, please have your order number handy—it will speed things up!) We also hope to hear from you on how much you like your new helper.

And, please tell your friends about your new DR[®] WHISPER LITE[®]! Having DR[®] Owners spread the word about our products and our way of doing business is the best advertising we can have, and the best way to help us provide even better service in the years to come.

Thanks once again!



for all of us at..

COUNTRY HOME PRODUCTS[®]

For future reference when dealing with your warranty, please fill out the information below and keep in a safe place.

Name Purchased Under: _____

Order Number: _____

Date of Purchase ____ / ____ / ____ **Important**

Table of Contents

CONTROLS & FEATURES.....	1
SET-UP INSTRUCTIONS.....	2
HOW TO SET-UP YOUR LAWN MOWER	2
OPERATING INSTRUCTIONS.....	3
PRE-START CHECKS.....	3
TO START MOTOR AND ENGAGE BLADE.....	4
TO STOP MOTOR AND BLADE	4
BATTERY CHARGING INSTRUCTIONS.....	5
ELECTRONIC CUT-OUT SWITCHES.....	6
CIRCUIT BREAKER	6
LOW-VOLTAGE CUT-OUT SWITCH.....	6
CUTTING HEIGHT ADJUSTMENT	6
HANDLEBAR HEIGHT ADJUSTMENT	7
OFF-SEASON STORAGE	7
FOLDING THE HANDLEBARS.....	8
LAWN CARE TIPS.....	9
MAINTENANCE	10
SERVICE ASSISTANCE & REPLACEMENT PARTS	10
CLEANING.....	10
CUTTING BLADE	10
TO SHARPEN THE BLADE	11
TO BALANCE THE BLADE.....	11
TROUBLESHOOTING	12
PARTS LIST.....	14
SCHEMATIC DRAWING	15
BRIGGS & STRATTON MOTOR AND BATTERY PACK SYSTEM WARRANTY	BACK COVER

Controls & Features

Make yourself, and any other operators, familiar with the controls, parts and operation of the DR[®] WHISPER LITE[®] CORDLESS Electric Mower before using it.

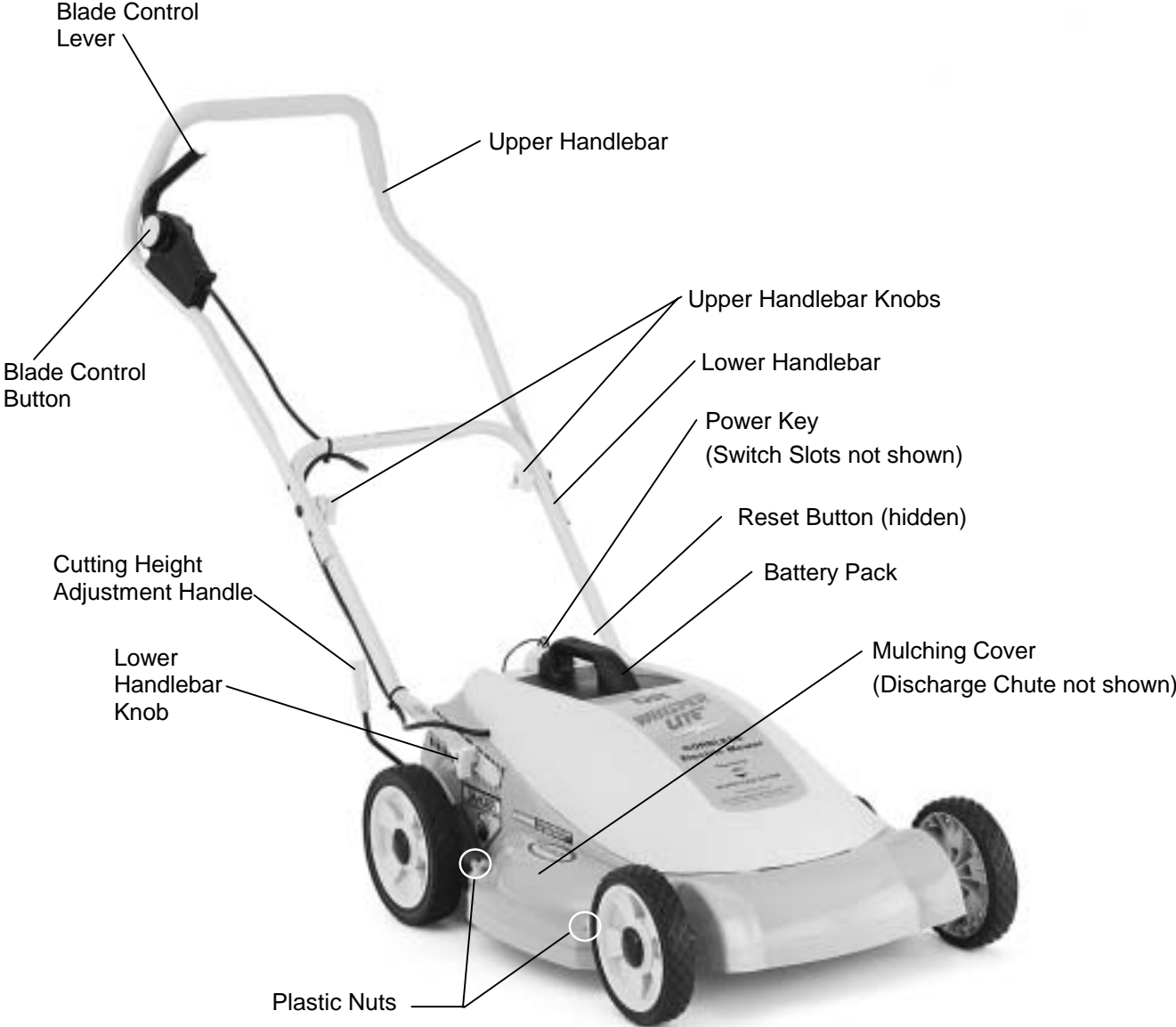

Figure 1

Set-Up Instructions

How To Set-Up Your Lawn Mower

1. Open the top flaps of the carton and remove the inserts. Remove the loose parts, including the side discharge chute, battery pack, battery charger, battery charger lead and power key (*Figure 1, page 1*).
2. Lift the mower from the carton.
3. Pull up and back on the upper handlebar to raise the packing material between the upper and lower handlebars.
4. Tighten the four hand knobs on the sides of the lower and upper handlebars.

Note: Your mower is shipped with the handlebar in the middle height position. To raise or lower the handlebar, refer to page 7.

5. Place the battery pack into the opening provided on top of the mower (*Figure 2*). Push firmly into place; it will fit in only one position.
6. Make certain all nuts, bolts and screws are tightened securely.

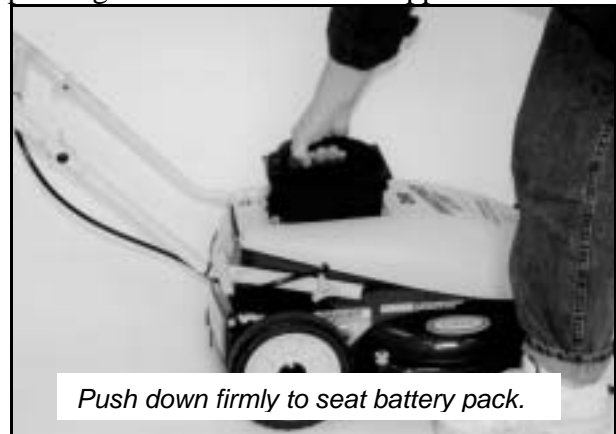

Figure 2

⚠ WARNING: Always remove the power key and battery pack before exchanging the mulching cover and side discharge chute.

7. Your mower has been shipped as a mulcher. To convert your mower from a mulcher to a side discharge mower, remove the two plastic nuts from the right side of the mower (*Figures 3 & 4*). Remove the mulching cover and place the side discharge chute over the two studs. Secure the chute firmly with the two plastic nuts.

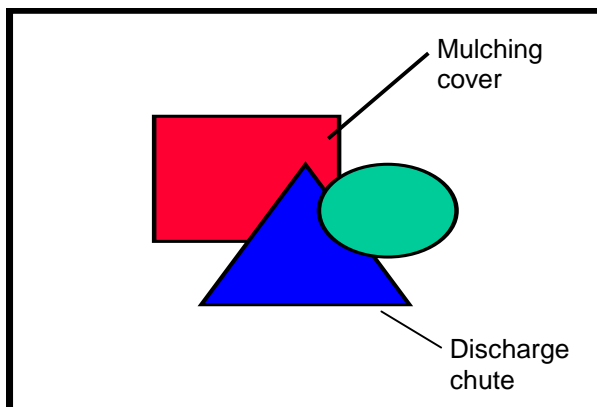

Figure 3



Figure 4

(How to Set Up Your Lawn Mower—continued)

Note: The mower will not operate without the discharge chute or the mulching cover installed because of the magnet built into each (*Figures 5 and 6*). Make sure the magnet is clean and free of debris. Also, make sure these covers are always firmly screwed down on the machine, or the lawn mower will not operate.

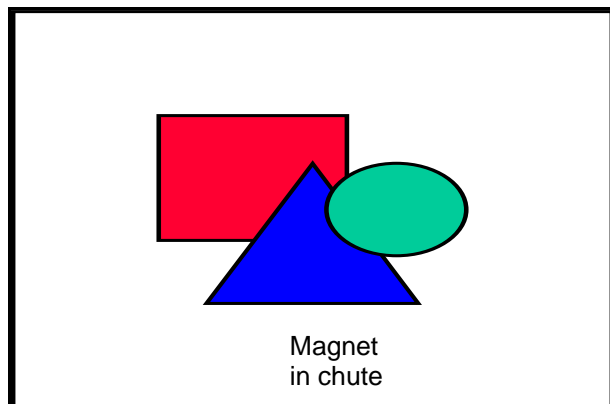

Figure 5

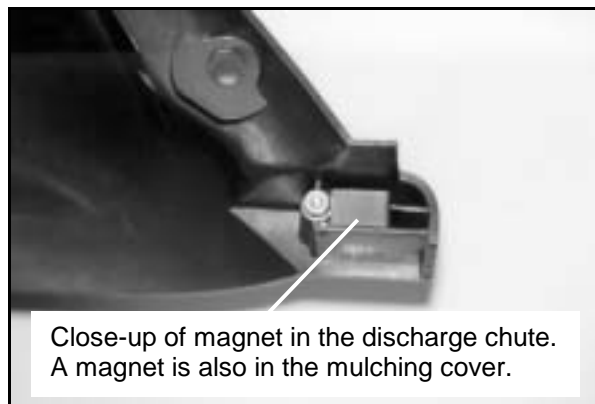

Figure 6

Important: Make sure your battery is fully charged before operating your mower. Refer to the charging instructions on page 4.

Operating Instructions

Pre-Start Checks

- ⇒ Check to make sure the mulching cover or side discharge chute is in its proper place and securely tightened. The mower will not operate unless the mulching cover or side discharge chute is installed.
- ⇒ Check the external surfaces of the mower and remove any accumulation of dirt, dust or dried grass clippings.
- ⇒ Cut 1" to 2" of grass at a time. Check the cutting height and readjust to the desired height before starting the lawn mower. Use a greater height for cutting tall grass. Refer to Cutting Height Adjustment on page 6 for instructions.

Note: The lawn mower battery pack has been fully charged at the factory. However, since batteries self-discharge over time, you must recharge the battery pack to a full charge before using your mower for the first time.

- ◆ **Reminder:** To reduce the risk of injury, the mower **will not run** unless the discharge chute or the mulching cover is installed. The magnet on the discharge chute or the mulching cover must have clean contact with the mower.
- ◆ **Reminder:** The length of time that a battery can hold its charge while mowing a lawn depends upon lawn conditions; tall, thick, or wet grass make the mower work harder and cause the battery to discharge faster.

To Start Motor and Engage Blade

1. To start, insert the power key into the switch slots located behind the battery pack (*Figure 7*).
2. Depress the button on the blade control switch (*Figure 8*) and pull the blade control lever firmly to the handlebar (*Figure 9*). Release the push button.

⚠ WARNING: This blade control is a safety device. Do not tamper with or bypass.

To Stop Motor and Blade

1. To stop, release the blade control lever (*Figure 8*).

⚠ WARNING: The blade continues to rotate for a few seconds after the motor is shut off.

- ⇒ Remove the power key when the equipment is unattended and the motor is shut off.
- ⇒ For easier starting, move the mower to an area where the grass is short enough not to interfere with the rotation of the cutting blade. Before starting (especially for the first time), know how to stop the motor quickly in the event of an emergency. To stop the motor, release the blade control lever.

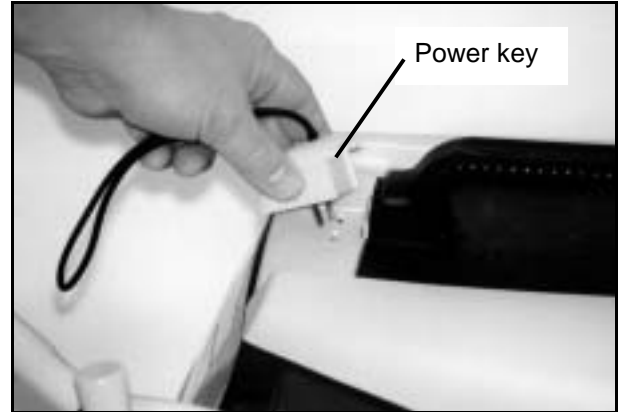

Figure 7

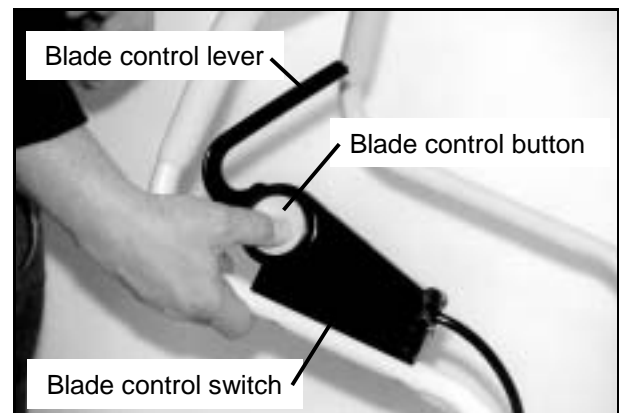

Figure 8

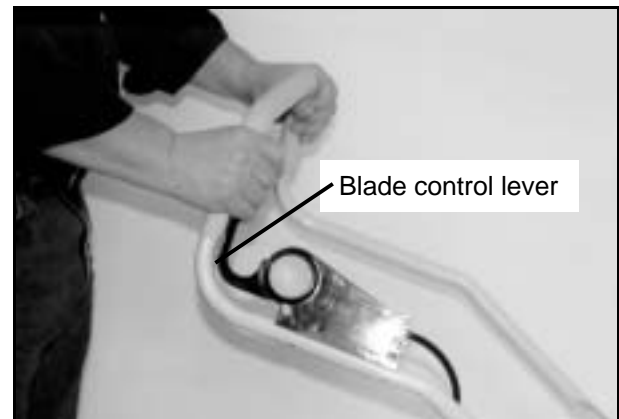

Figure 9

Battery Charging Instructions

⚠ WARNING: The battery contains corrosive fluid and toxic material. Handle with care. Keep away from children. Do not puncture, disassemble, mutilate or incinerate. Explosive gases could be vented during charging or discharging. Use in a well ventilated area, away from sources of ignition.

Charge the battery pack(s) indoors or in a dry area out of the weather. Use only the battery charger provided with the mower (Briggs & Stratton part number 497400). First plug the battery charger lead into the battery (*Figure 10*), then plug the charger into any standard 110/120 volt household electrical outlet. If you have a dual or "Y" lead, you can use the other lead to charge another battery pack at the same time, though charging will take longer (*Figure 11*).

If an extension cord is required, use one rated for outdoor use that is at least wire size 16 AWG. Connect the extension cord to the charger before plugging the extension cord into the electrical outlet. Make sure to recharge the battery packs fully when your finished using the mower. It takes at least 16 hours to recharge a completely discharged battery, and at least 24 hours to recharge two battery packs at once. The red light on the battery charger indicates that the battery charger is plugged into an electrical outlet; the green light indicates that the battery is fully charged.

The battery should be charged every 30 to 60 days if the mower is not used. Charge the battery for a maximum of 48 hours only.

Important: Always disconnect the battery charger (or the extension cord, if used) from both the electrical outlet and the battery pack, or the battery may discharge itself back into the charger. Be sure that the battery is disconnected from BOTH of these!

◆ **Reminder:** The length of time that a battery can hold its charge while mowing a lawn depends upon lawn conditions; tall, thick, or wet grass make the mower work harder and the battery discharge faster.

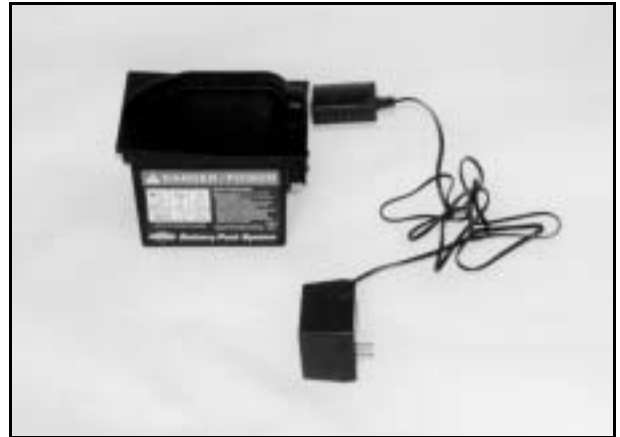

Figure 10



Figure 11

Electronic Cut-Out Switches

Circuit Breaker

A circuit breaker is located to the left of the power key on top of the mower. This breaker may trip when cutting heavy or thick grass, or when a wire short-circuits. You know the circuit breaker has tripped if the mower will not run and the white circuit breaker reset button is projecting up into the transparent rubber boot. If this happens, reset the breaker by depressing the reset button (*Figure 12*). If the circuit breaker does not reset or if it trips repeatedly under normal cutting conditions, call one of our Customer Service Representatives **TOLL-FREE 1(800) DR-OWNER(376-9637)**.

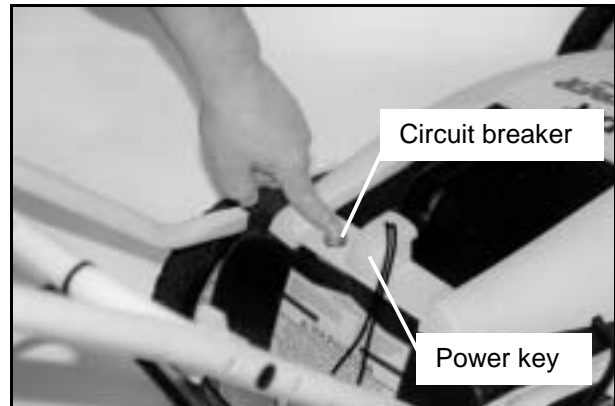

Figure 12

Note: If the circuit breaker trips during the operation of the mower, allow the electric motor to cool for at least one minute before resetting the breaker.

Low-Voltage Cut-Out Switch

The motor is equipped with an electronic cut-out switch. This device stops the mower if the battery charge becomes excessively low and the blade speed becomes slow after an extended period of mowing. Before restarting the mower, replace the battery pack with a fully charged battery pack (the discharged battery pack should be recharged immediately to avoid damage).

Cutting Height Adjustment

Adjust cutting height to cut 1" to 2" of grass at a time. The cutting height adjustment handle is located on the right side of the deck (*Figure 13*). The handle may be placed in one of five cutting height positions. Pull the handle toward the wheel and then either push it forward to raise the cutting height or pull it back to lower the cutting height. For rough or uneven lawns, move the height adjustment handle to a greater cutting height.



Figure 13

Handlebar Height Adjustment

Three holes in the upper handlebar provide handlebar height adjustment. The mower is shipped with the handlebar in the middle height position.

To change the height of the handlebar, remove the two hand knobs and the carriage bolts (*Figure 14*) which secure the upper handlebar to the lower handlebar.

To raise the handlebar height, align the bottom holes in the upper handlebar with the holes in the lower handlebar.

To lower the handlebar height, align the top holes in the upper handlebar with the holes in the lower handlebar.

Once the proper height has been selected, secure the upper handlebars to the lower using the carriage bolts and hand knobs.

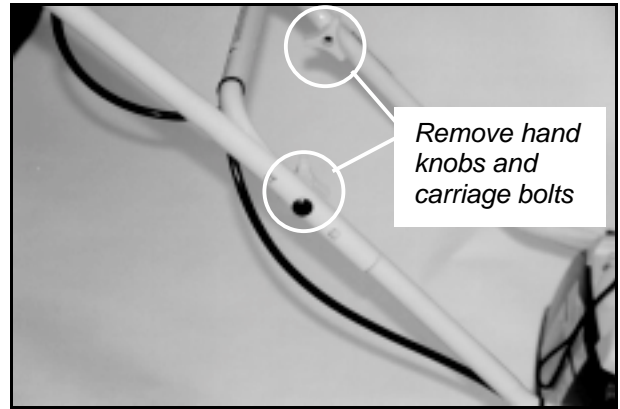

Figure 14

Off-Season Storage

The following steps should be taken to prepare the lawn mower for storage:

1. Clean the mower thoroughly as described on page 10.
2. Keep the battery pack(s) fully charged while in storage. See Battery Charging Instructions on page 5.

◆ **Reminder:** Battery pack(s) will be damaged if stored discharged.

3. Coat the cutting blade with light weight grease to prevent rusting.
4. Coat other exposed metal parts with light oil or engine oil to prevent rusting.
5. Store the mower in a dry, clean area. Do not store next to corrosive materials such as fertilizer.

Folding the Handlebars

1. The handlebar assembly can be folded in half, or completely folded away for storage. To fold the handlebars in half, loosen the upper handlebar knobs and fold the upper handlebar forward onto the machine (*Figure 15*).
2. To fold the handlebar assembly away for storage, loosen the hand knobs which secure the lower handlebar to the deck (see *Figure 1* on page 1). Fold the entire handlebar assembly forward and down over the mower until the grips are resting on the ground. Then loosen the knobs which secure the upper handlebar to the lower handlebar and fold the upper handlebar backward until it rests on top of the mower.

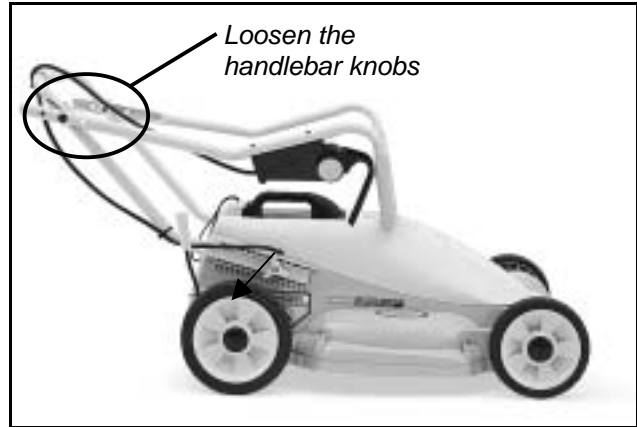

Figure 15

Important: Be careful not to kink the cable at any time; this could damage the unit and render the controls inoperative.

To place the handlebar assembly in the operating position, pull up and back on the upper handlebar until it is raised to the operating position and tighten the hand knobs securely. Be careful not to pinch the cable when unfolding the handlebars.

Lawn Care Tips

- Mow your lawn as often as necessary.
- Never remove more than one third of the leaf blade during any one mowing session. When more than one third of the blade is removed, the grass plant produces less food for itself and therefore becomes weaker and more susceptible to disease and insect damage.
- Grass that is allowed to get taller will have a stronger, larger root system that will better withstand dry periods.
- Depending on the health of your lawn and the weather, it may be necessary to mow your lawn twice a week during the fast growing periods to avoid taking off more than one third of the leaf blade.
- Your lawn will benefit more if you leave the clippings right where they are. When left in place, grass clippings shade the soil surface and reduce moisture loss. Grass clippings also add organic matter to help improve the soil by returning valuable nutrients to the soil such as nitrogen, phosphorous, and potassium when they decompose.
- The only time it is absolutely necessary to remove grass clippings is when they accumulate in a thick layer that smothers the lawn and doesn't decompose quickly.
- Keep your mower blade sharp! A sharp mower blade cuts the grass quickly and cleanly, using less of the mower's power, which conserves battery life. For best results, inspect the blade often and have an extra, sharp blade ready to as a replacement while the dull blade is being sharpened.
- Alternate the mowing pattern on your lawn frequently. By changing the pattern and direction of the cut, you'll improve the health and appearance of your lawn. Following the same mowing pattern causes soil compaction and turf wear from the mower wheels.

Maintenance

⚠ WARNING: Be certain to remove the power key and the battery pack before performing any adjustment or repair.

Service Assistance & Replacement Parts

To maintain the original quality of your mower, use genuine Briggs & Stratton replacement parts only. To obtain the correct part for your particular mower, always specify the model number (found on the name plate). Contact one of our Customer Service Representatives **Toll-Free 1(800)DR-OWNER (376-9637)** for parts and service assistance. We recommend taking your mower to a Briggs & Stratton authorized service center once each year for inspection and addition of any new devices which might upgrade the safety of your mower. Please call Country Home Products® and we will pre-arrange a visit to an authorized service center. Not all Briggs and Stratton service centers are knowledgeable about this mower. You can also send the mower to the Service Department at Country Home Products® for service.

Cleaning

1. Remove the power key.
2. Wipe the mower clean with a dry cloth. Periodically remove the battery pack and wipe the battery cavity clean (do not use water).
3. To prolong the life and efficiency of your mower, clean the underside of the mower deck after each use. Tilt the mower forward or on its side and scrape the underside clean (make certain the power key and the battery have been removed).

Cutting Blade

CHECK at frequent intervals to make sure the blade is securely tightened and that it is in good condition.

REPLACE the blade if it's badly chipped, bent, out of balance, or as soon as a notch starts wearing in the tip between the flat surface and upturned lift (Figure 16, view B). This type of wear pattern occurs more rapidly in sandy soil conditions.

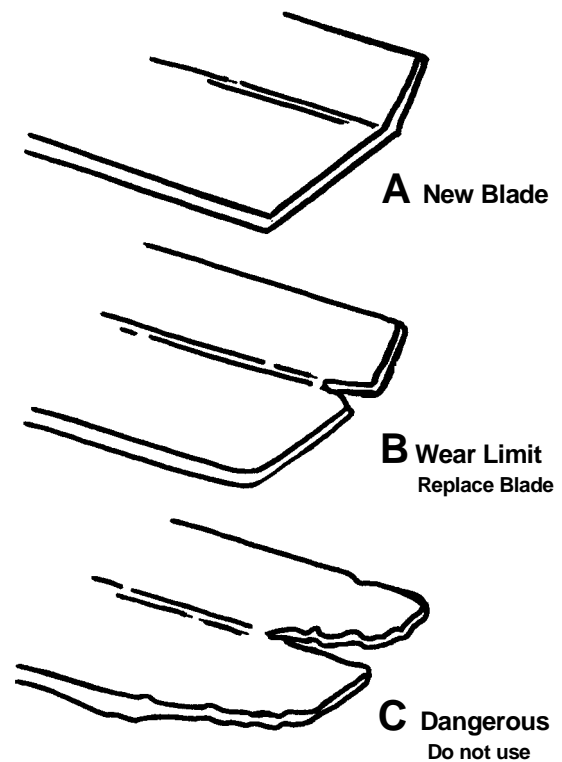

Figure 16

⚠ WARNING: Never operate the mower with the blade worn to the extent depicted in view C of Figure 16 as the tip could fly off, and cause personal injury or property damage.

⚠ WARNING: Be certain to remove the power key and the battery pack before performing any adjustment or repair.

To Sharpen the Blade

When the blade is dull, cut ends of the grass will be ragged and usually turn brown soon after mowing. If the blade is in otherwise good condition, sharpen it when the cutting edges become dull.

⚠ Caution: To avoid cutting yourself on the blade, wear heavy leather gloves.

For best results, remove the blade (*Figure 17*) and sharpen the cutting surfaces at an angle of 25 degrees.

Check the blade after sharpening to make sure it is still balanced (see "To Balance the Blade" below). It will cause excessive vibration if unbalanced.

Before reassembling the blade and the blade adapter to the unit, brush any built up debris out of the grooves of the motor base (*Figure 18*). Coat the motor crankshaft and the inner surface of the blade adapter with light oil (or engine oil).

Install the sharpened or replacement blade with components in same sequence as removed. Do not substitute any components here. Tighten the blade retaining cap screw.

Important: When replacing the blade, be sure to install it with the stiffening ribs on the blade facing toward the mower.

To Balance the Blade

Because you are removing metal from each side of the blade, make sure to remove an equal amount from each side to keep the blade balanced. A badly imbalanced blade will cause your machine to vibrate excessively. The best way to balance a blade is with a blade balancer (usually about \$3.00 at your local hardware store) or with a large nail or bolt. After sharpening the blade, place it on the balancer and check the level. If one side of the blade tips lower, you need to sharpen that side more to balance the blade.



Figure 17

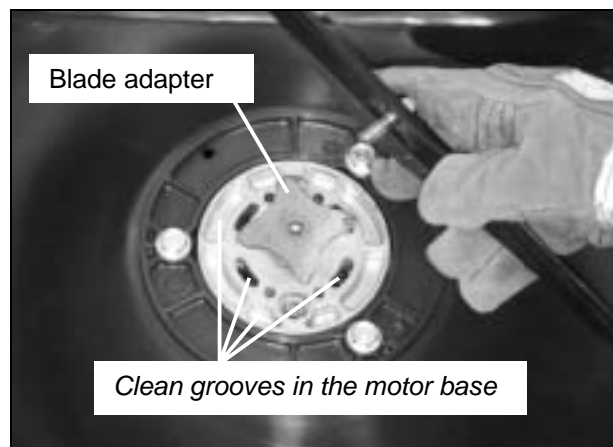

Figure 18

Troubleshooting

⚠ WARNING: Be sure to stop motor and remove the power key and battery pack before performing any repairs or maintenance.

Problem	Possible Causes	Corrective Action
<i>Motor fails to start</i>	<ul style="list-style-type: none"> ⇒ Power key not inserted ⇒ Blade control lever disengaged ⇒ Battery discharged ⇒ Mower deck clogged with grass and debris ⇒ Tripped circuit breaker ⇒ Discharge chute or mulch cover not in place ⇒ Magnet on discharge chute or mulch cover not making contact 	<ul style="list-style-type: none"> ⇒ Insert power key ⇒ Depress starter button and pull blade control lever ⇒ Charge or replace battery ⇒ Unclog mower deck. Make certain blade is free to move ⇒ Reset circuit breaker ⇒ Mount discharge chute or mulch cover onto mower, screw down tightly ⇒ Remove chute or cover & clean so that magnet makes good contact w/ mower, screw chute back down tightly
<i>Mower stops while mowing</i>	<ul style="list-style-type: none"> ⇒ Discharged battery ⇒ Cutting too much grass ⇒ Clogged deck ⇒ Magnet on discharge chute or mulch cover not making contact 	<ul style="list-style-type: none"> ⇒ Charge or replace battery ⇒ Adjust cutting height to cut 1"-2" of grass at a time or cut a narrower swath. ⇒ Unclog mower deck. Raise cutting height or cut a narrower swath ⇒ Remove chute or cover, clean so that magnet makes good contact w/ mower, screw chute back down tightly
<i>Excessive vibration</i>	<ul style="list-style-type: none"> ⇒ Cutting blade loose or unbalanced ⇒ Bent cutting blade 	<ul style="list-style-type: none"> ⇒ Tighten blade and adapter. Balance blade ⇒ Replace blade
<i>Mower will not mulch grass</i>	<ul style="list-style-type: none"> ⇒ Mower deck clogged ⇒ Wet grass ⇒ Grass is too high ⇒ Dull blade 	<ul style="list-style-type: none"> ⇒ Unclog mower deck. Make certain blade is free to move ⇒ Do not mow when grass is wet; wait until later to cut ⇒ Adjust cutting height to cut 1"-2" of grass at a time or cut a narrower swath. ⇒ Sharpen or replace blade

<i>Uneven cut</i>	⇒ Dull blade ⇒ Grass is too high or too thick	⇒ Sharpen or replace blade ⇒ Adjust cutting height to cut 1"-2" of grass at a time or cut a narrower swath.
<i>Battery loses its charge quickly</i>	⇒ Battery was not fully charged ⇒ Grass is too high or too thick	⇒ Charge battery fully ⇒ Adjust cutting height to cut 1" to 2" of grass at a time or cut a narrower swath.

Note: For repairs beyond the minor adjustments listed above, contact one of our Customer Service Representatives **Toll-Free 1(800)DR-OWNER (376-9637)**.

Parts List

Please refer to the schematic drawing on page 15.

Item	Part No.	Description		Item	Part No.	Description
1	102141	Key Assembly		25	102361	Front Wheel
2	102061	Discharge Chute		26	102131	Hubcap
3	101961	Battery Pack Assembly		27	102261	Wheel Retainer
4	101941	Interlock Switch Assembly		28	102181	Height Adjuster Link
5	102191	Magnet		29	102391	Blade Mounting Bolt
6	102271	Screw		30	102351	Washer, Split Ring
7	102031	Cord Clip		31	102301	Trailing Shield
8	101951	Circuit Board Wire		32	101981	Lower Handlebar Bolt
			Assem bly	33	102371	Rear Wheel
9	102121	Wiring Harness		34	101921	Height Adjuster, Rear
10	102041	Mower Cover		35	102251	Link Retainer
11	102311	Solenoid		36	102231	Bolt Retainer
12	102151	Knob		37	102401	Battery Charger
13	102201	Motor		38	130021	Handlebar Knob
14	102081	Height Adjuster Handle		39	102011	Solenoid Clamp
15	102001	Mulching Cover		40	102111	Battery Charger Harness ("Y" Lead--optional)
16	102321	Chute Stud		41	102091	Lower Handlebar
17	102241	Interlock Retainer		42	130021	Handlebar Knob
18	102051	Mower Deck		43	101971	Handlebar Bolt
19	101911	Height Adjuster Front		44	102171	Circuit Breaker Label/Boot
20	101991	Bolt, Motor		45	102281	Handlebar Screw
21	101901	Blade Adapter		46	102101	Upper Handlebar
22	102381	Blade		47	102411	Motor Control
23	102221	Axle Retainer		48	102071	Foam Handle Grip
24	102271	Screw		49	101931	Blade Control Assembly

Schematic Drawing

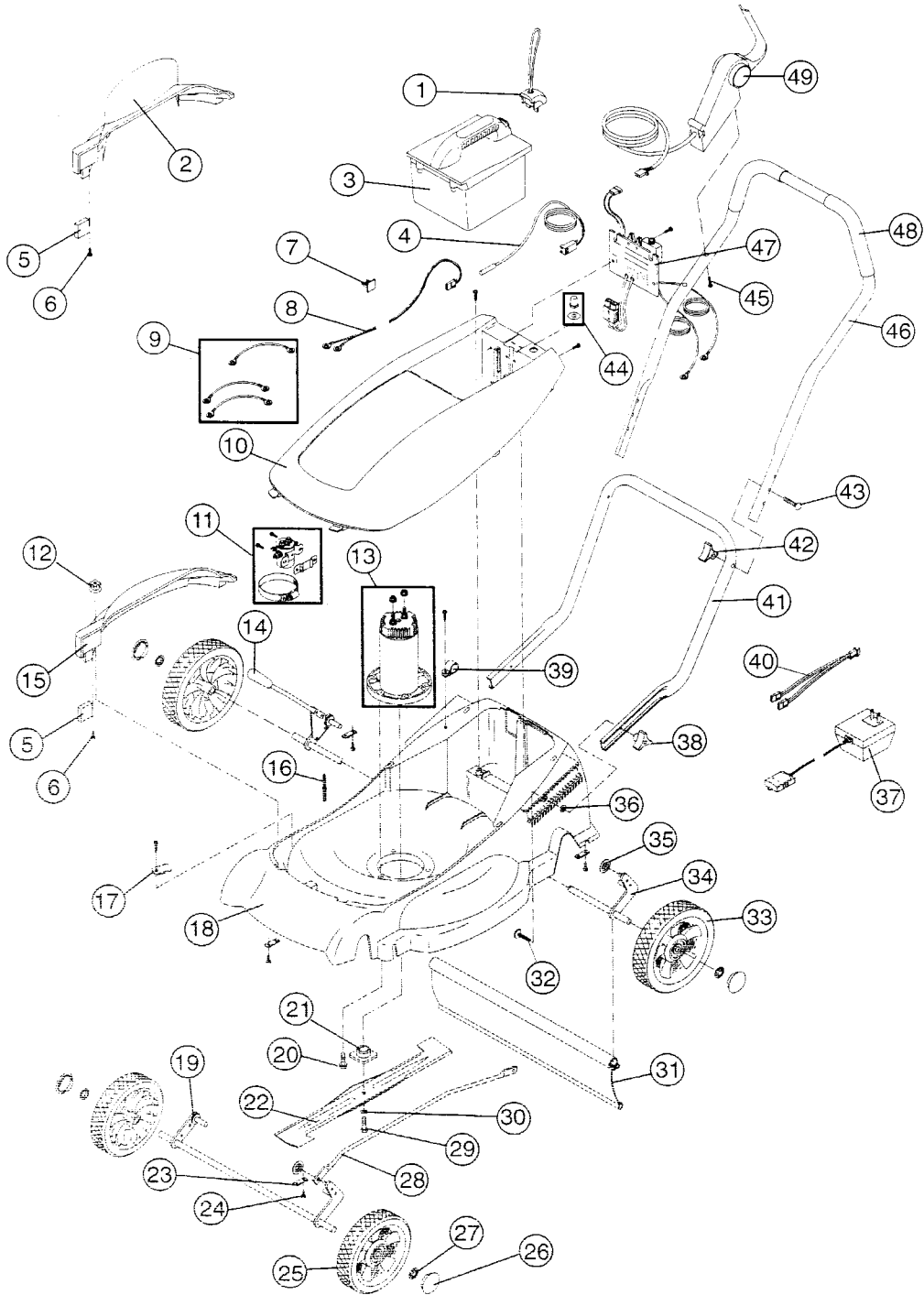

- 10 -

We Want You to be Totally Satisfied

The DR[®] WHISPER LITE[®] CORDLESS Electric Mower is designed to provide years of trouble-free performance. To ensure that you are totally satisfied with this important purchase, we offer the following three-part Assurance of Satisfaction:

1. The DR[®] WHISPER LITE[®] is GUARANTEED FOR ONE FULL YEAR against defects in materials and workmanship when in consumer use. If you believe that a part is defective, please write or call immediately. We will do our best to remedy the problem, including repairing or replacing defective parts as quickly as possible. The Power Train Elements and Battery Pack System are guaranteed separately by Briggs & Stratton (see below).
2. IF WITHIN THE FIRST 30 DAYS of actual hands-on use you have questions or you are less than 100% satisfied with your DR[®] WHISPER LITE[®], please write or call us **TOLL-FREE 1(800)DR-OWNER** (376-9637). We will do everything possible to answer your questions or make things right—even if it means that you return your DR[®] WHISPER LITE[®] for a full refund of its purchase price, shipping costs included. (Refund on shipping is for standard method, and applies to the contiguous United States and Canada only.)
3. We operate, for our Owners, a 7-Days-a-Week Customer Service Department with well-trained and friendly folks whose sole job is to ensure that you get any help you need...parts that need to be replaced...or questions answered courteously and as promptly as possible.

Briggs & Stratton Motor and Battery Pack System Warranty

Effective January 1, 1995, Limited Warranty

“Briggs & Stratton Corporation will repair or replace, free of charge, any part or parts of the Battery Pack System that are defective in material or workmanship or both. This warranty is effective for the time periods and subject to the conditions provided for in this policy. For warranty service contact COUNTRY HOME PRODUCTS[®] and we will pre-arrange a visit to an authorized service dealer in your area. THERE IS NO OTHER EXPRESS WARRANTY. IMPLIED WARRANTIES, INCLUDING THOSE OF MERCHANTABILITY AND FITNESS FOR A PARTICULAR PURPOSE ARE LIMITED TO ONE YEAR FROM PURCHASE, OR TO THE EXTENT PERMITTED BY LAW ANY AND ALL IMPLIED WARRANTIES ARE EXCLUDED. LIABILITY FOR CONSEQUENTIAL DAMAGES UNDER ANY AND ALL WARRANTIES ARE EXCLUDED TO THE EXTENT EXCLUSION IS PERMITTED BY LAW. Some states do not allow limitations on how long an implied warranty lasts. And some states do not allow the exclusion or limitation of incidental or consequential damages, so the above limitation and exclusion may not apply to you. This warranty gives you specific legal rights and you may also have other rights which vary from state to state.”

COMPONENT	WARRANTY PERIOD
Mainframe and Deck	5 years
Power Train Elements <i>(including: motor, circuit board, key, charger, and switch)</i>	2 years
Battery Pack	1 year

This warranty shall only apply to “consumer user” which means personal residential household use by the original retail consumer.

NO WARRANTY REGISTRATION CARD IS NECESSARY TO OBTAIN WARRANTY ON A BRIGGS & STRATTON BATTERY PACK SYSTEM. YOU MUST SAVE THE PURCHASE RECEIPT. A PROOF OF PURCHASE DATE WILL BE REQUIRED TO OBTAIN WARRANTY.

COUNTRY HOME PRODUCTS[®], Inc.

Meigs Road, P.O. Box 25, Vergennes, Vermont 05491

CODE: 30166X