

DR® Lawn Mower SP 26 and SP 30

Transmission Replacement Instructions – Part# 391261

These instructions will provide guidance on removing and replacing the wheel Height Adjust Lever, Transmission, and Axle flange bearings on your SP30 or SP26. Please note that the machine pictured may not match yours exactly. Please keep these instructions with your Safety and Operating Instructions Manual for future reference.

Tools and Supplies Needed:

- Safety Glasses
- Two 2x4s
- 9/16" Wrench
- 7/16" Wrench
- 3/8" Wrench
- 1/2" Wrench
- Snap Ring Pliers
- Spring Puller or Locking Pliers
- Flat Head Screwdriver
- Machine S&O Manual

WARNING

Before following steps, you must drain oil and gas from the engine. It is recommended that you have another person be a helper for some steps.

Removing the Wheels

1. With the deck raised, slide blocking under the Main Frame, in front of the rear wheels. Lower the deck to take the weight off the rear wheels and set the handlebars to the upright storage position (**Figure 1**).
2. Remove both rear wheels using a 9/16" Wrench.
3. Remove the Snap Ring from both drive gears using a pair of Snap Ring Pliers. Then remove the gear and plastic backing (**Figure 2**).

Note: Be careful not to overstretch the Snap Ring during removal. Open it just enough to slide off the shaft.



Figure 1



Figure 2

Removing the Transmission

1. Set the wheel height to the highest setting and tip the machine back on to the Handlebars.

Note: Setting the height to the highest setting reduces the tension in the spring in the next step, making it easier to remove.

2. Using a Spring Puller or Locking Pliers, take the end of the Deck Lift Spring off the Height Adjust Axle (Figure 3).

Note: This requires a good deal of force, so have a helper brace the machine so it does not tip.

3. Remove the Drive Belt as described by your S&O Manual.
4. Remove the two bolts that connect the Axle to the Frame Weldment. Use a 7/16" Wrench on the nut, and a 3/8" Wrench or socket on the bolt Head (Figure 4).
5. Remove the clip off the Height Adjust Bar by the front tires using a Flat Head Screwdriver. (Figure 5).
6. Remove the two Axle mounting bolts from each side using an Open-Ended 1/2" Wrench (Figure 6).

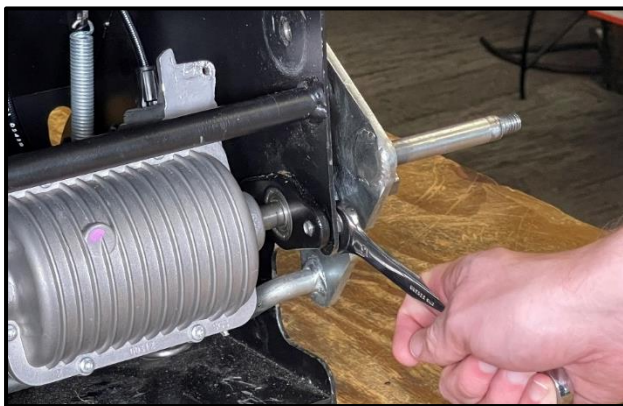

Figure 6

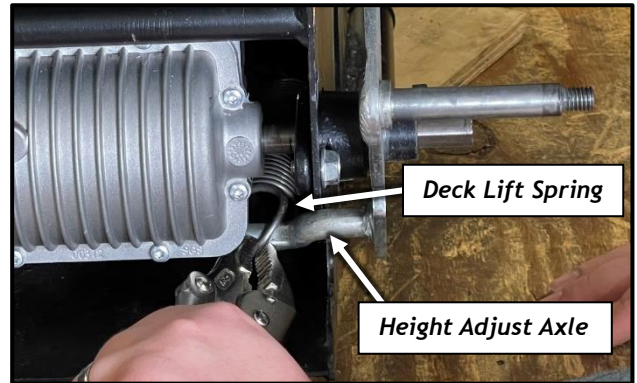

Figure 3

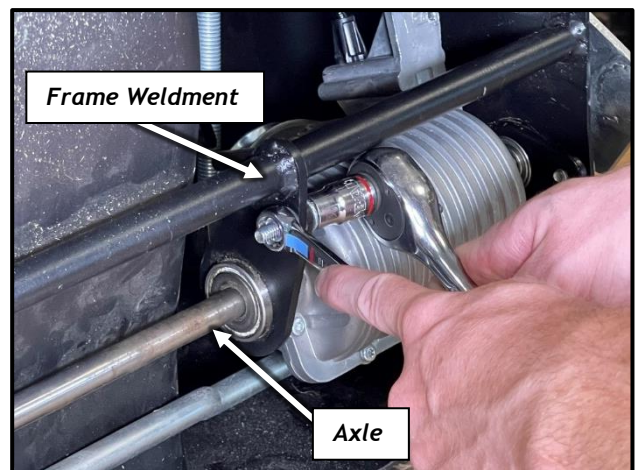

Figure 4

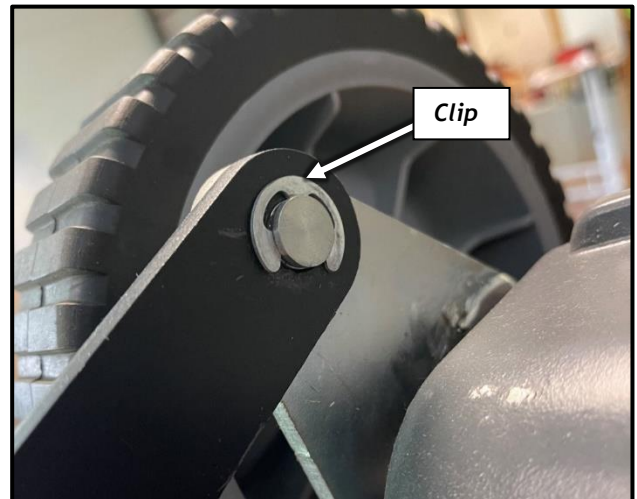

Figure 5

- Slide the whole Axle and Transmission assembly out as one piece. (**Figure 7**).

Note: It may be easier to remove the assembly if the machine is tipped back more than in previous steps, so have a helper assist to improve stability.

- Push the Flange Bearing back so that you can shift the Transmission and Axle to separate them from the Height Adjust Assembly (**Figure 8**).
- Shift the Transmission and Axle to the left, allowing you to angle the right-hand side away from the Height Adjust Weldment. Shift the Axle back to the right and separate the Transmission from the Height Adjust Assembly (**Figure 9**).

Reassembling the Mower

Reassemble the machine by following the steps in Reverse. Please read the notes below to ensure a smooth reassembly.

Note: These steps are for reinstalling the Transmission

- When doing Step 9 in reverse, there may be a Washer that must be reinstalled on your machine between the Height Adjust Lever and the Axle Weldment (**Figure 10**). This is not present on all machines.

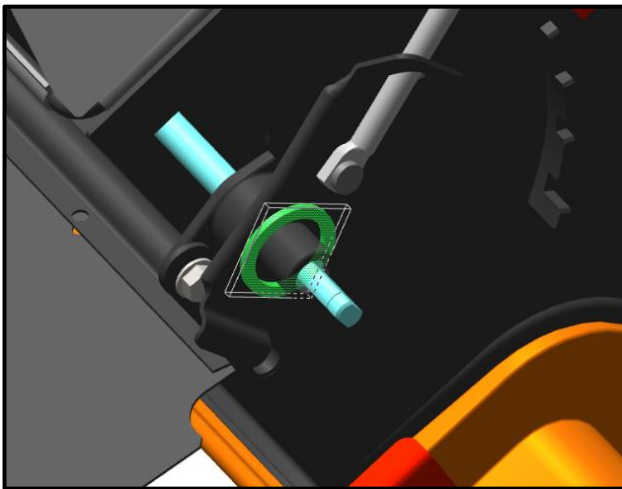

Figure 10

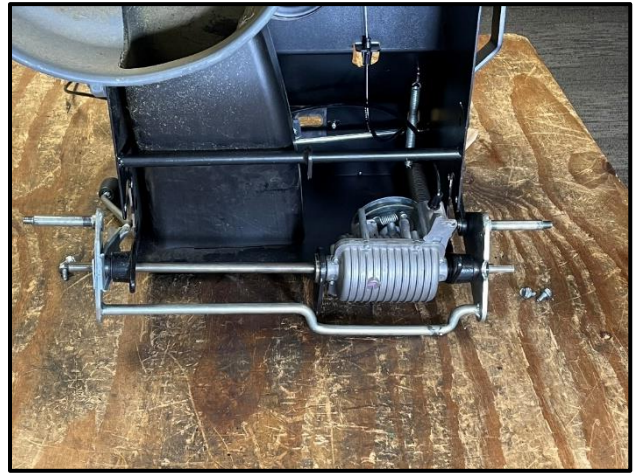

Figure 7

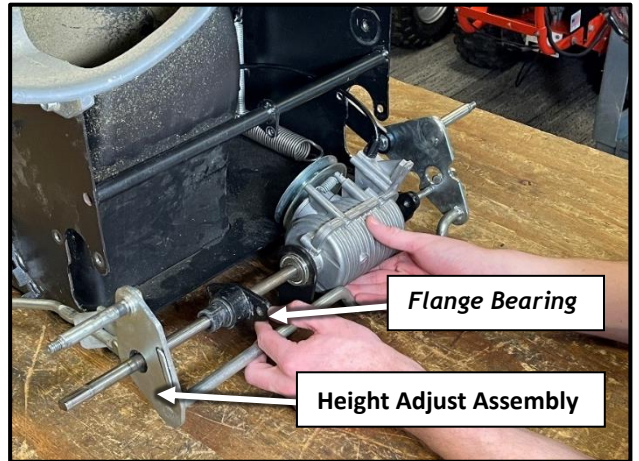

Figure 8

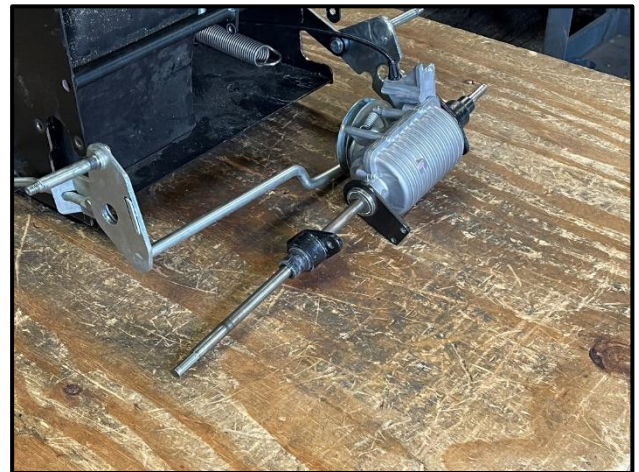

Figure 9

2. When doing Step 6 in reverse, ensure that the Support Bearing Plate is pushed up next to the Transmission when inserting the assembly back into the machine. It will catch on to the Discharge Chute and cause the assembly to not fit properly if not in the right position (**Figure 11**).

Note: This step is for reinstalling the Wheels.

3. When doing Step 3 in reverse, it may be required to move the Axle within the Transmission if you do not have the room to fit one of the gears back on. Use a Rubber Mallet to gently tap on one side of the Axle until there is enough room for both gears.

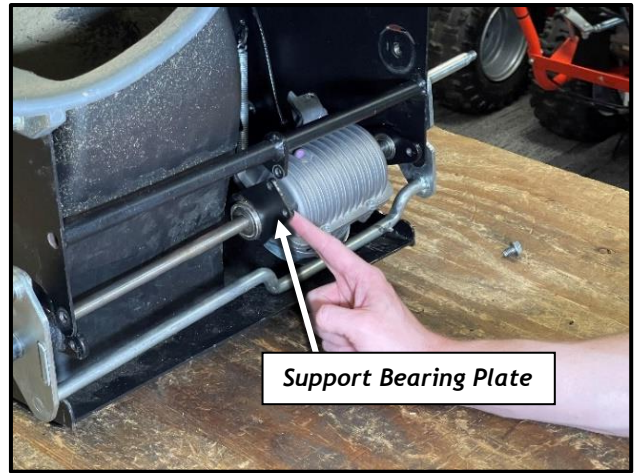

Figure 11

Additionally, below we have included other photos that were not in the above steps to better assist with reassembly.

