

DR[®] DUAL-ACTION 3 PT HITCH LOG SPLITTER

SAFETY & OPERATING INSTRUCTIONS

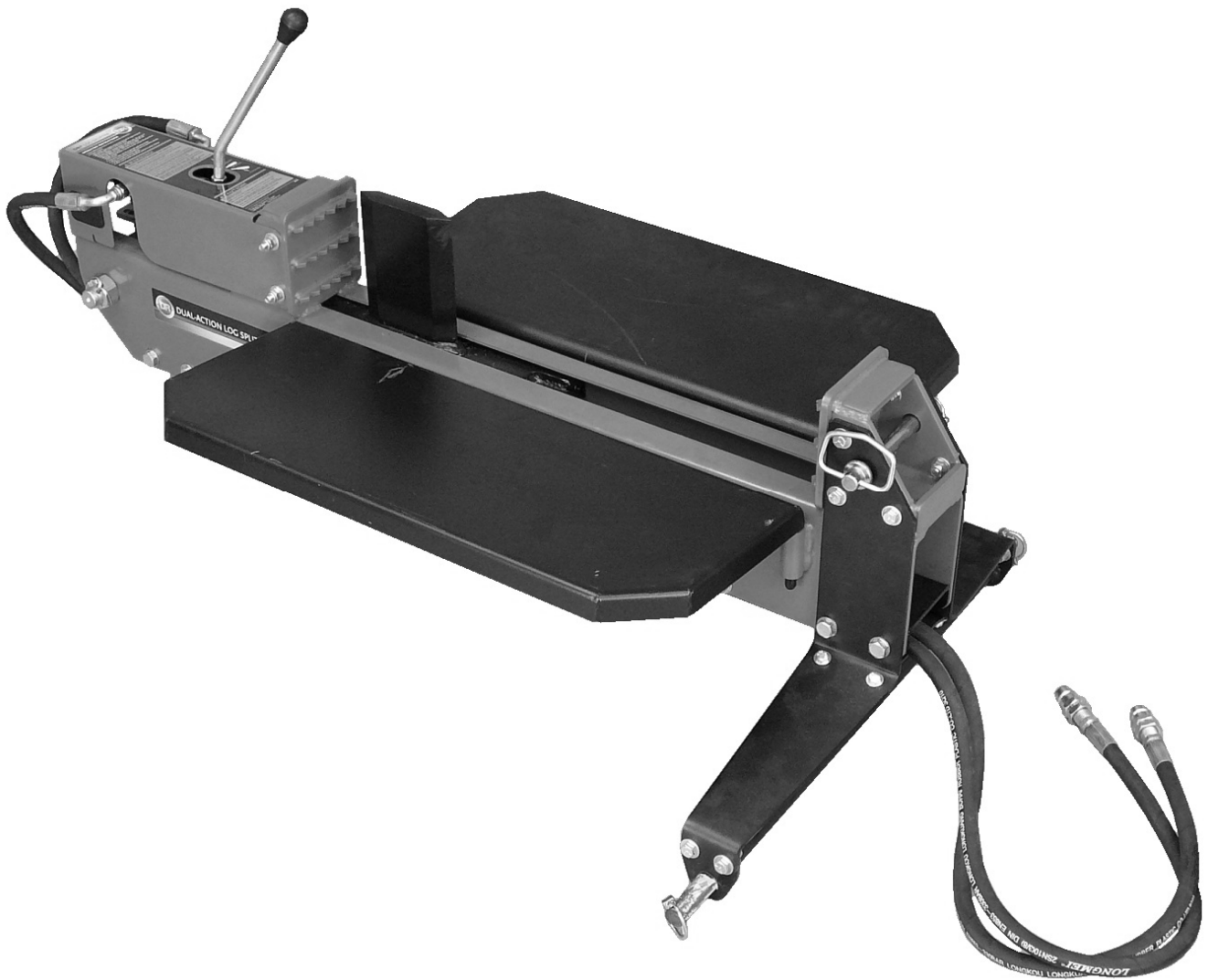

Serial No. _____

Order No. _____

Original Language

DR Power Equipment
Toll-free phone: 1-800-DR-OWNER (376-9637)
Fax: 1-802-877-1213
Website: www.DRpower.com

! WARNING

Read and understand this manual and all instructions before operating the DR Dual-Action 3 PT Hitch Log Splitter.

Table of Contents

Chapter 1: General Safety Rules.....	3
Chapter 2: Setting Up The DR DUAL-ACTION 3 PT HITCH LOG SPLITTER	6
Chapter 3: Operating The DR DUAL-ACTION 3 PT HITCH LOG SPLITTER	11
Chapter 4: Maintaining The DR DUAL-ACTION 3 PT HITCH LOG SPLITTER.....	13
Chapter 5: Troubleshooting	14
Chapter 6: Parts Lists and Schematic Diagrams.....	16

Conventions used in this manual

WARNING

This indicates a hazardous situation, which, if not avoided, could result in death or serious injury.

CAUTION

This indicates a hazardous situation, which, if not avoided, could result in minor or moderate injury.

NOTICE

This information is important in the proper use of your machine. Failure to follow this instruction could result in damage to your machine or property.

Serial Number and Order Number

A Serial Number is used to identify your machine and is located on the Serial Number Label on your machine. An Order Number is used to check and maintain your order history and is located on the upper left portion of your packing slip. For your convenience and ready reference, enter the Serial Number and Order Number in the space provided on the front cover of this manual.

Additional Information and Potential Changes

DR Power Equipment reserves the right to discontinue, change, and improve its products at any time without notice or obligation to the purchaser. The descriptions and specifications contained in this manual were in effect at printing. Equipment described within this manual may be optional. Some illustrations may not be applicable to your machine.

Chapter 1: General Safety Rules

WARNING

Read this Safety & Operating Instructions manual before you use the DR DUAL-ACTION 3 PT HITCH LOG SPLITTER. Become familiar with the operation and service recommendations to ensure the best performance from your machine. If you have any questions or need assistance, please contact us at www.DRpower.com or call toll-free 1-800-DR-OWNER (376-9637) and one of our Technical Support Representatives will be happy to help you.

Labels

Your DR DUAL-ACTION 3 PT HITCH LOG SPLITTER carries prominent labels as reminders for its proper and safe use. Shown below are copies of all the Safety and Information labels that appear on the equipment. Take a moment to study them and make a note of their location on your Log Splitter as you set up and before you operate the unit. Replace damaged or missing safety and information labels immediately.



DR® LOG SPLITTER 

OPERATING INSTRUCTIONS

1. Read Safety & Operating manual for complete instructions.
2. Prepare machine.
GAS MODEL: Start engine using instructions from engine manual. Advance throttle control to maximum speed.
ELECTRIC MODEL: Inspect electric cord before use. Do not use if cord is damaged. Use GFI adapter or electrical outlet and only approved extension cords. Start motor using switch.
3. **POINT HITCH MODEL:** Connect to tractor using instructions from tractor manual.
3. Grab log by sides and place onto rail, against base plate.
4. Move control handle to **FORWARD** position to extend the cylinder.
5. Release handle to **STOP** the cylinder.
6. Move control handle to **REVERSE** position to retract cylinder.

⚠ WARNING!

AVOID SERIOUS INJURY OR DEATH

READ SAFETY & OPERATING INSTRUCTION MANUAL COMPLETELY.
KEEP HANDS AND ALL BODY PARTS AWAY FROM SPLITTING WEDGE, RAM, PARTIALLY SPLIT WOOD, AND MOVING PARTS.
HOLD LOGS BY THE SIDES, NOT THE ENDS OR TOP WHILE LOADING.
ONLY ONE PERSON IS PERMITTED TO LOAD LOGS AND OPERATE THE LOG SPLITTER.
DO NOT CHECK FOR OIL LEAKS WITH YOUR HAND. USE A CLOTH. HIGH PRESSURE HYDRAULIC FLUID CAN PENETRATE YOUR SKIN, CAUSING BLOOD POISONING.
STAY IN THE MANUFACTURER'S DESIGNATED OPERATOR ZONE.
NEVER OPERATE LOG SPLITTER UNDER THE INFLUENCE OF ALCOHOL OR DRUGS.
GAS AND 3-POINT HITCH MODELS: DON'T REFUEL A HOT OR RUNNING ENGINE. ONLY OPERATE LOG SPLITTER IN A WELL-VENTILATED AREA.
ELECTRIC MODEL: KEEP ELECTRIC CORD AWAY FROM WATER, OIL, HEAT AND SHARP EDGES. DO NOT USE MACHINE IF THE CORD IS DAMAGED.
USE GFI ADAPTER OR ELECTRICAL OUTLET AND ONLY APPROVED EXTENSION CORDS.



⚠ CAUTION!

OPERATE LOG SPLITTER ON FLAT, LEVEL, DRY GROUND. STAY OFF SLOPES AND SLIPPERY SURFACES.
NEVER ALLOW CHILDREN OR UNTRAINED ADULTS TO USE LOG SPLITTER.
KEEP BYSTANDERS, CHILDREN, AND HELPERS AT LEAST 25 FT. AWAY.
WEAR SAFETY GLASSES, HEARING PROTECTION, TIGHT FITTING WORK GLOVES WITHOUT LOOSE STRAPS OR DRAWSTRINGS, AND SAFETY SHOES.
NEVER LEAVE LOG SPLITTER UNATTENDED DURING OPERATION.
SPLIT WOOD IN THE DIRECTION OF THE GRAIN ONLY.

DR POWER EQUIPMENT
75 Meigs Road, Vergennes, VT 05491
1-800-DR-OWNER www.DRpower.com

293941

#29394

⚠ WARNING! DO NOT SIT OR STAND ON TRAY

29395

Protecting Yourself and Those Around You

WARNING

This is a high-powered machine, with moving parts operating with high energy. You must operate the machine safely. Unsafe operation can create a number of hazards for you, as well as anyone else in the nearby area. Always take the following precautions when using this machine:

- Keep in mind that the operator or user is responsible for accidents or hazards occurring to other people, their property, and themselves.
 - Always wear protective goggles or safety glasses with side shields while using the Log Splitter to protect your eyes from possible thrown debris.
 - Avoid wearing loose clothing or jewelry, which can catch on moving parts.
 - We recommend wearing gloves while using the Log Splitter. Be sure your gloves fit properly and do not have loose cuffs or drawstrings.
 - Wear shoes with non-slip treads when using your Log Splitter. If you have safety shoes, we recommend wearing them. Do not use the machine while barefoot or wearing open sandals.
 - Wear long pants while operating the Log Splitter.
 - Use ear protectors or ear plugs rated for at least 20 dBA to protect your hearing.
 - Keep bystanders at least 50 feet away from your work area at all times. Stop the Tractor engine when another person or pet approaches.
-

Safety for Children and Pets

WARNING

Tragic accidents can occur if the operator is not alert to the presence of children and pets. Children are often attracted to the machine and the splitting activity. *Never* assume that children will remain where you last saw them. Always follow these precautions:

- Keep children and pets at least 50 feet from the working area and ensure they are under the watchful care of a responsible adult.
 - Be alert and turn the Tractor off if children or pets enter the work area.
 - Never allow children to operate the Log Splitter.
-

Hydraulic Safety

WARNING

High fluid pressures are developed in hydraulic machines. Pressurized hydraulic fluid escaping through a pin hole opening can puncture skin and cause severe blood poisoning. Therefore, the following Instructions should be heeded at all times.

- Do not operate the unit with frayed, kinked, cracked or damaged hoses, fittings, or tubing. Stop the Tractor engine, wait 5 minutes and relieve hydraulic system pressure before changing or adjusting fittings, hoses, tubing, or other system components.
 - Do not change any Log Splitter relief valve settings. They are set at the factory for best Splitter performance and safety.
 - Do not check for leaks with your hand. Leaks can be located by passing cardboard or wood over the suspected area: Look for discoloration. If injured by escaping fluid, see a doctor at once. Serious infection or reaction can develop if proper medical treatment is not administered immediately.
 - Always wear safety glasses to protect your eyes from hydraulic fluid.
-

General Safety

WARNING

Operating this Log Splitter safely is necessary to prevent or minimize the risk of death or serious injury. Unsafe operation can create a number of hazards for you. Always take the following precautions when operating this Log Splitter:

- Your Log Splitter is a powerful tool, not a plaything. Exercise extreme caution at all times. The machine is designed to split logs. Do not use it for any other purpose.
- Know how to stop the Log Splitter quickly; see “stopping the Splitter” in chapter 3.
- Never operate your unit on a slippery, wet, muddy, or icy surface. Exercise caution to avoid slipping or falling.
- See manufacturer’s instructions for proper operation and installation of accessories. Only use accessories approved by DR Power Equipment.
- Never use the machine without ensuring that all guards and shields are in place.
- Never, under any conditions, remove, bend, cut, fit, weld, or otherwise alter standard parts on the Log Splitter. This includes all shields and guards. Modifications to your machine could cause personal injuries and property damage and will void your warranty.
- Allow only one person to operate the Log Splitter at any time.
- If the machine should start making an unusual noise or vibration, shut down the Tractor engine, wait 5 minutes for machine to cool down, then inspect for damage. Vibration is generally a warning of trouble. Check for damaged parts and clean, repair and/or replace as necessary.
- Never tamper with safety devices. Check their proper operation regularly.
- Before performing any maintenance or inspection procedure on the Log Splitter shut down the Tractor engine, wait 5 minutes for machine to cool down.
- Never allow people who are unfamiliar with these instructions to use the Log Splitter. Allow only responsible individuals who are familiar with these rules of safe operation to use your machine.
- Never overload or attempt to split logs beyond the manufacturer’s recommendation. Personal injury or damage to the machine could result.
- While using the Log Splitter, don’t hurry or take things for granted. When in doubt about the equipment or your surroundings, stop the machine and take the time to look things over.
- Never operate the machine when under the influence of alcohol, drugs, or medication.
- Use the machine only in daylight.
- Stay alert for hidden hazards or traffic.
- Keep all nuts and bolts tight and keep the equipment in good operating condition.

A Note to All Users

No list of warnings and cautions can be all-inclusive. If situations occur that are not covered by this manual, the operator must apply common sense and operate this DR® Dual-action 3 PT Hitch log splitter in a safe manner. Contact us at www.DRpower.com or call 1-800-DR-OWNER (376-9637) for assistance.

Chapter 2: Setting Up The DR DUAL-ACTION 3 PT HITCH LOG SPLITTER

It may be helpful to familiarize yourself with the controls and features of your DR Dual-Action 3 PT Hitch Log Splitter as shown in Figure 1 before beginning these procedures. If you have any questions at all, please feel free to contact us at www.DRpower.com.

DR DUAL-ACTION 3 PT HITCH LOG SPLITTER Controls and Features

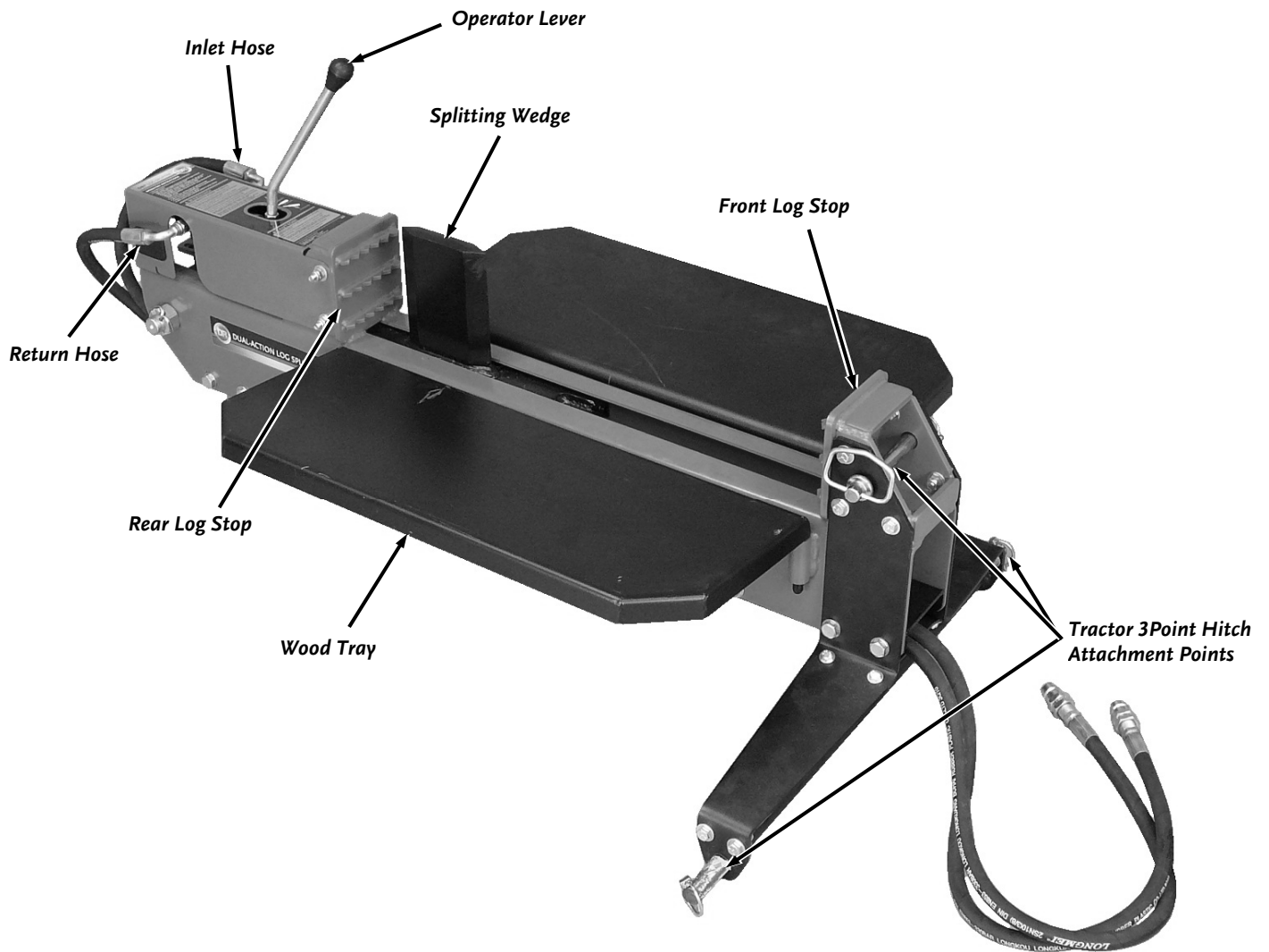

Figure 1

Specifications

Engine	Tractor dependant
Tractor Requirements	Category 1 with hydraulic couplings, 2500 PSI recommended
Bed height	Tractor dependant, 3 PT hitch range
Wedge	6.61" (168mm) H, .75" (19mm) W, high carbon steel.
Log Trays	27.45in (697mm) L x 11.45in (290mm) W
Force/Tonnage	Up to 13 Tons (Tractor dependant)
Log Length	20 inches
Log Diameter*	24 inches
Cycle Time	Approx. 6 seconds (Tractor dependant)
Weight	232 lbs (105kg)
Dimensions	50" L X 31.5" W X 28" H
Cylinder Size	3" (76mm) Bore, 18.51" (470mm) Stroke
Control Valve	Integrated Pressure Relief

*The diameter of the log is indicative - a small log can be difficult to split when it contains knots or a particularly tough fiber. On the other hand, it may not be difficult to split logs with regular fibers even if its diameter exceeds the maximum indicated above.

Assembling the DR DUAL-ACTION 3 PT HITCH LOG SPLITTER

Tools and Supplies Needed:

- Two 3/4" Wrenches
- Two 9/16" Wrenches
- Two 1/2" Wrenches
- 17mm Wrench
- Jack Stands
- Wire Cutters
- Safety Glasses

1. Open the Parts Box and lay them out on a clean flat area (**Figure 2**).

Note: For assembly location, the part numbers in the following list can be referenced to the Parts List and illustrations in Chapter 6.

Parts Supplied in Parts Box (**Figure 2**):

Item #	Part #	Description	Qty
1	29361	Brace, Cross.....	1
2	24537	Hitch Pin 3/4" X 6".....	1
3	27610	Abrasion Resistant Sheathing, 15.5in.....	1
4	24538	Linch Pin, 3/16" X 1-9/16".....	3
5	15043	Bolt, HHCS, 3/8-16 X 1-1/4", GR5.....	10
6	11241	Washer, Flat, 5/16 USS, ZP.....	28
7	11075	Nut, Nylon Lock, 3/8-16, ZP.....	10
8	11076	Nut, Nylon Lock, 5/16-18, ZP.....	6
9	11158	Bolt, HCS, 5/16-18 X 1", ZP.....	6
10	29379	Tube Clamp, 3/4", Vinyl Coated.....	4
11	15192	Pin, Hitch Clip 5/16" - 3/8".....	4
12	11214	Cable Tie, 7-1/2 Long.....	2

Compare the contents of the Parts Box with the "Parts Supplied" list above. If you have any questions please contact us at www.DRpower.com or call 1-800-DR-OWNER (376-9637) for assistance.

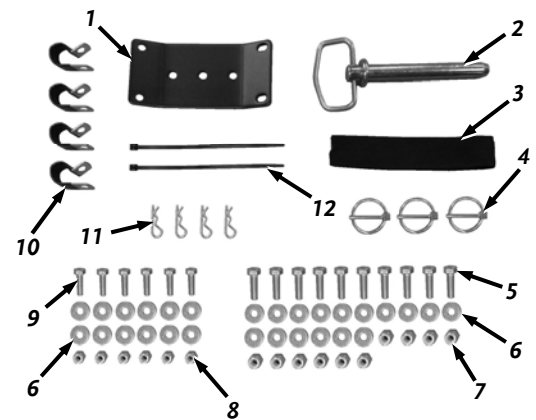

Figure 2

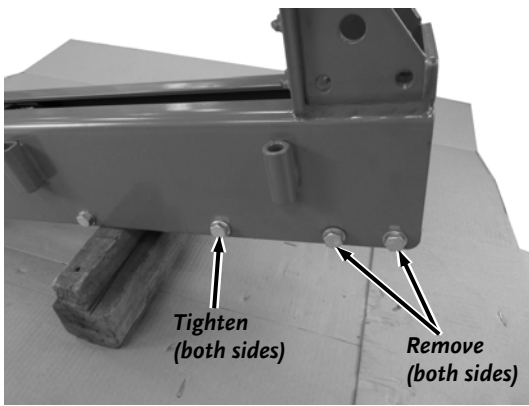

Figure 3

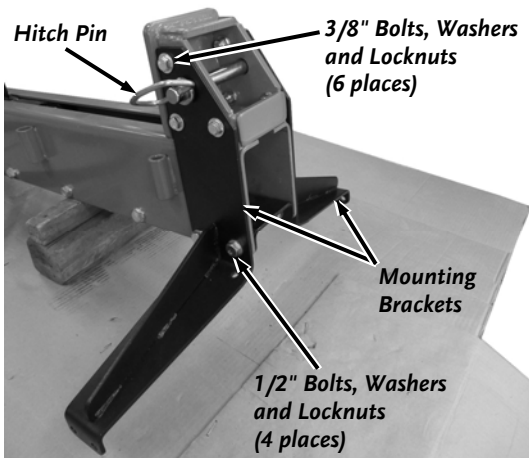

Figure 4

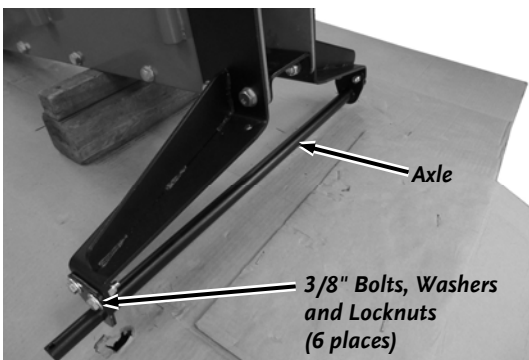

Figure 5

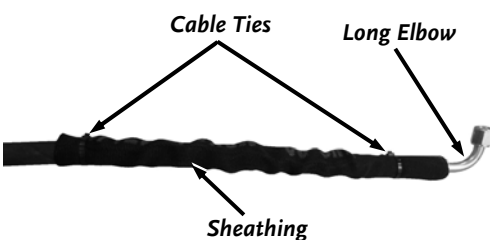

Figure 6

Assembly

CAUTION

We recommend two people when handling assemblies during the following procedures. The assemblies involved are heavy and could cause injury when lifting or if dropped.

1. Block the rear end of the Beam Assembly up to gain access to the hardware and remove the first two sets on each side (**Figure 3**). Tighten the third set on each side using a 3/4" Wrench.
2. Position the two Mounting Brackets and insert the large Hitch Pin to locate them (**Figure 4**).
3. Install the six sets of 3/8" Bolts, Washers (one on bolt side and one on nut side) and Locknuts by hand.
4. Install the four sets of 1/2" Bolts, Washers (bolt side and nut side) and Locknuts by hand that you removed in step 1.

Note: As the hardware is tightened in the next step, make sure the Hitch Pin moves freely in its holes and does not bind.

5. Tighten the 3/8" hardware using two 9/16" Wrenches.
6. Tighten the four 1/2" Hardware with two 3/4" Wrenches.

Note: Install the hardware in the next step with the Bolt threads and Locknuts on the inside so they will not interfere with arms of your Tractors 3 point hitch.

7. Position the Axle with its mounting ears on the outside of the two Mounting Brackets and install the Axle with 3/8" Bolts, Washers (one on bolt side only) and Locknuts using two 9/16" Wrenches (**Figure 5**).

8. Slide the Sheathing over the long Elbow end of one of the Hoses and secure it with the two Cable Ties (**Figure 6**).

Note: Remove protective Caps as needed for the following Hydraulic Hose connections

9. Install both Hoses onto the Valve angled rearward at a 45 degree angle so it can be routed under the center of the Beam Assembly (**Figure 7**). Tighten with a 17mm Wrench.

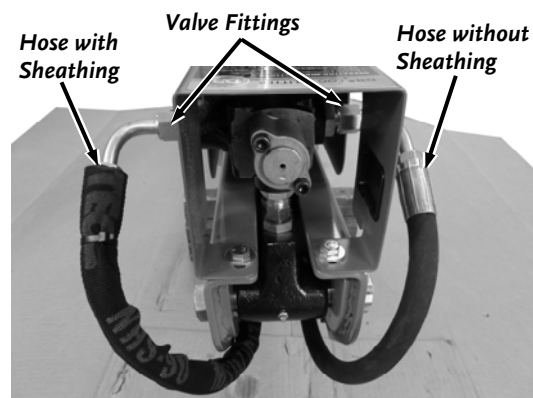

Figure 7

10. Block the front end of the Beam Assembly up to gain access to the hardware and remove and discard the second set of hardware on each side (**Figure 8**). Tighten the third set on each side using a 3/4" Wrench.
11. Place a Hose Clamp over each Hose and attach the Clamp to the Beam with 3/8" Bolts, Washers (one on bolt side and one on nut side) and Locknuts using two 9/16" Wrenches (**Figure 9**).
12. Route the Hoses down the underside of the Beam to the rear.
13. Place a Hose Clamp around each Hose near the Axle and loosely attach the Clamps to the Cross Brace with 5/16" Bolts (clamp side) and Washer and Locknut (bottom side) (**Figure 10**).
14. Position the Cross Brace onto the Mounting Brackets and secure with four 5/16" Bolts, Washers (one on bolt side and one on nut side), and Locknuts using two 1/2" Wrenches (**Figure 11**).
15. Pull the Hoses to take up any sagging under the Beam and tighten the Clamp hardware using two 1/2" Wrenches.
16. Remove the Nut and Flat Washer from the Control Lever threads and reinstall the Nut all the way onto the threads (**Figure 12**).
17. Place the Washer onto the threads and screw the Control Lever into the top of the Control Valve as far as it will go. Turn it back to the desired position depending of your preference to split on the right or left side of the splitter. Tighten the Jam Nut against the Valve to secure the Lever using a 17mm Wrench.
18. Install the Trays onto the sides of the Beam assembly and secure with the Hitch Clips (**Figure 13**).

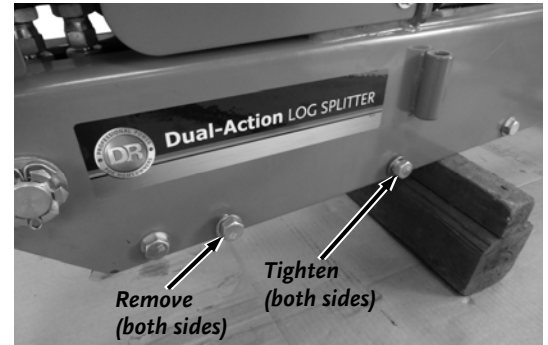

Figure 8

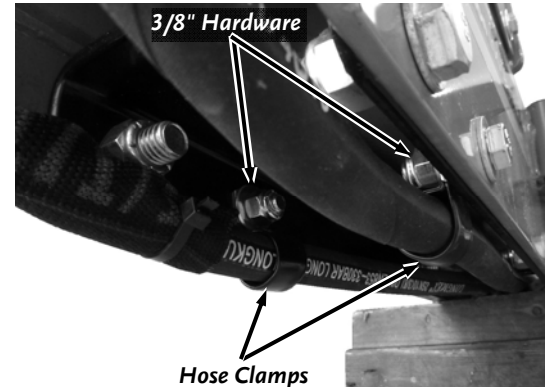

Figure 9

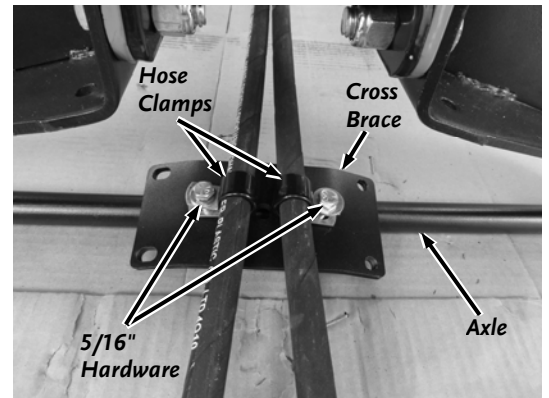

Figure 10

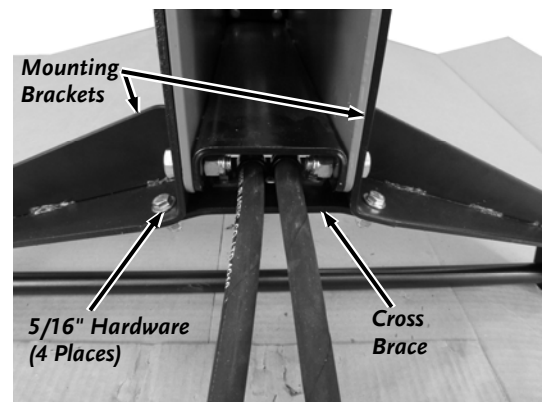

Figure 11

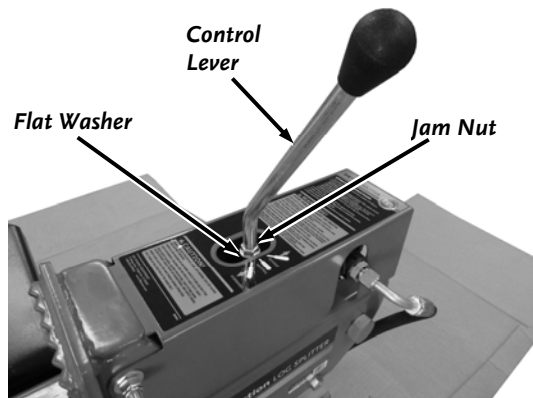

Figure 12

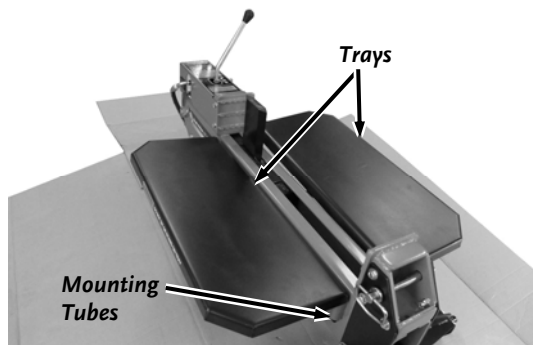

Figure 13

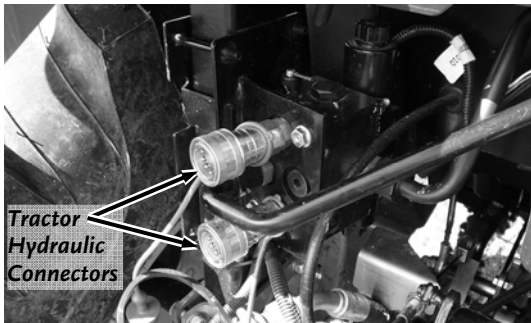

Figure 14

Attaching the Log Splitter to the Tractor

There are many different types and sizes of Tractor Hydraulic Connectors (**Figure 14**). For this reason the Splitter Hoses do not have Connectors on the ends. This allows you to purchase the correct type/size for your application. You may need to bring your Connectors to the supplier to ensure you get the correct mating Connectors for your Tractor. The Splitter Hose threads are 1/2" NPT Male where the Connector you will purchase attaches to the Hose.

! WARNING

- Before performing the following procedure, be sure your Tractor engine is off, brake is set, and the key removed for safety.
- Refer to your tractor manual or Tractor supplier before removing connectors or performing any procedures involving Tractor specific alterations to prevent damage to equipment or personal injury.

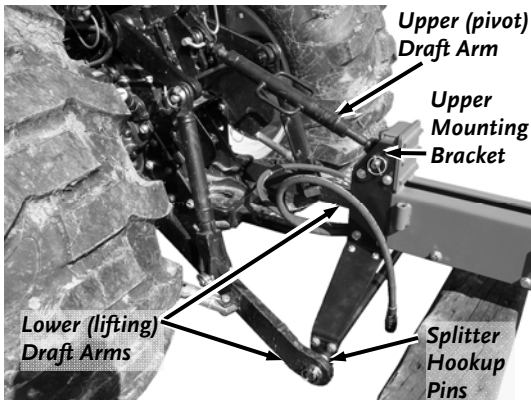

Figure 15

NOTE: Blocking the Splitter up off the ground to the level that the three point hitch can adjust to will aid attachment. It is also a good idea to store the Splitter in this manner in between use.

1. Position the Tractor to the Log Splitter and position the Lower Draft Arms to the Splitter Hookup Pins (**Figure 15**).
2. Slide the Lower Draft Arms onto the Splitter Hookup Pins and secure with Tractor Hitch Pins.
3. Position the Upper Draft Arm inside the Mounting Bracket and align with the Mounting Bracket Holes.
4. Insert the Tractor Hitch Pin to secure the Upper Draft Arm to the Splitter.
5. Attach the left side Splitter Hose Connector to the pressure Port coming from the Tractor pump (**Figure 16**). Attach the right side Splitter Hose Connector to the return Port going to the Tractor Hydraulic Tank.

Note: If the Hoses are attached to the wrong Connectors the direction that the Operator Lever is pushed will be opposite the direction of the Wedge. Simply swap the Hoses to ensure the Wedge travels in the same direction that the Operator Lever is pushed.

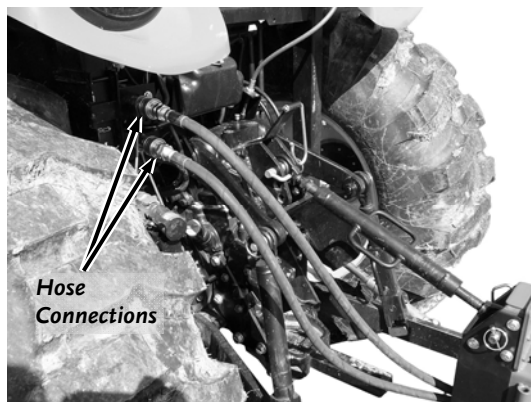

Figure 16

! WARNING

Do not lift the Splitter to the full height of the 3 Point Hitch range. The top link of some tractors may hit the splitter frame and become damaged. Check your range carefully so you know how high the splitter can be safely lifted for transport.

Chapter 3: Operating The DR DUAL-ACTION 3 PT HITCH LOG SPLITTER

It may be helpful to better familiarize yourself with the features of your Log Splitter by reviewing **Figure 1** in Chapter 2 before beginning the steps outlined in this chapter.

Note: Make sure the Hydraulic Hoses and 3 PT Hitch are attached securely as described in Chapter 2. All logs should be no longer than 20".

! WARNING

- Read and understand all instructions, safety precautions, and/or warnings listed in "Chapter 1 General Safety Rules" before operating this DR Dual-action 3 PT Hitch Log Splitter. If any doubt or question arises about the correct or safe method of performing anything found in this manual, please contact our Customer Service Representatives at our toll free number: 1-800-DR-OWNER (376-9637).
- When operating the Log Splitter, make sure you are standing in the safe operating area (OPERATOR ZONE) as shown in figure 17. You must stay in the safe operating area at all times when the splitting wedge is in motion (whether extending or retracting). Never place any part of your body into a position that causes an unsafe operating condition.
- Before loading and operating the Log Splitter, always wear protective gear, INCLUDING safety goggles, hearing protection, tight-fitting gloves without draw strings or loose cuffs, and steel-toed shoes.
- Use the following photos for the correct and incorrect methods of splitting logs. Never split a log using an incorrect or unsafe method.

1. Start the Tractor and adjust your Splitter to the desired height with the Tractor 3 PT Hitch.
2. Make sure the Tractor is in neutral and the Emergency Brake is set.
3. Set throttle and power the hydraulics to the Splitter as necessary for your Tractor.
4. Using the Control Lever, make the Wedge travel all the way to the end of the stroke at least twice to be sure to bleed any residual air from the hoses.

! WARNING

- Do not place your hands on the ends of the log when loading the Log Splitter. This is a very UNSAFE method and could result in injury to your hands (**Figure 18**).
- Do not reach or step across the rail while the Log Splitter is running. This is a very UNSAFE method which could cause personal injury or even death.

! CAUTION

Never attempt to split wood across the grain. The Log Splitter was not designed for cross-grain splitting. Doing so could damage the Log Splitter and may cause personal injury (**Figure 19**).

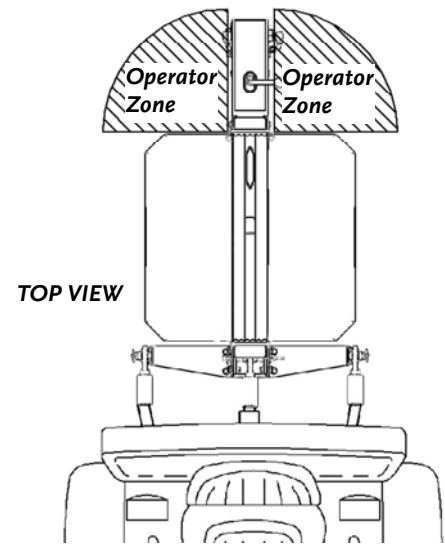

Figure 17



Figure 18



Figure 19

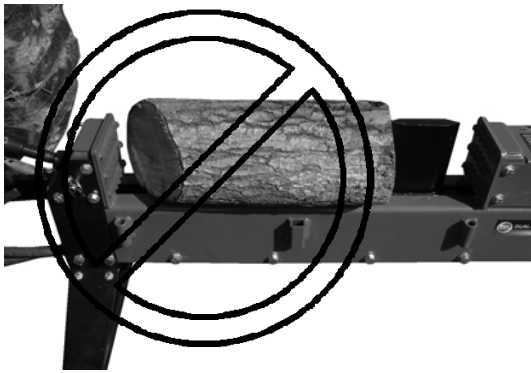

Figure 20

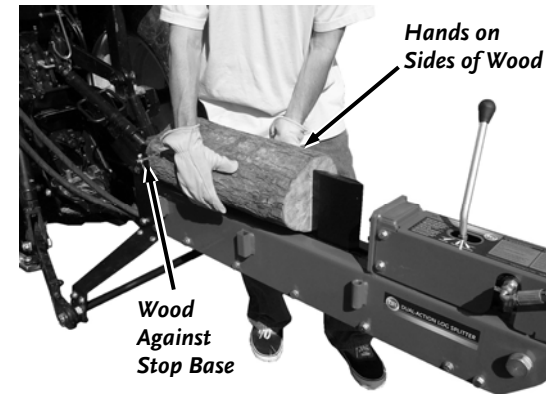

Figure 21

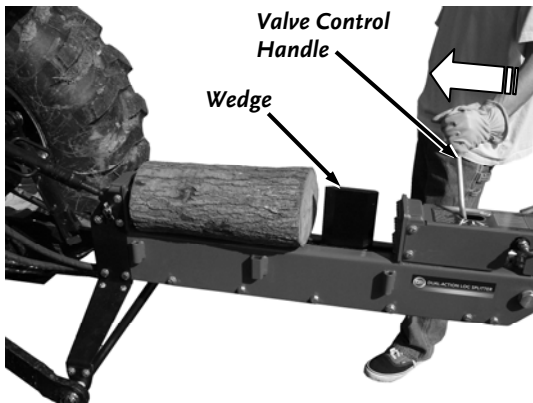

Figure 22

CAUTION

Make sure both ends of the log you are splitting are cut as square as possible. This will prevent the log from sliding out of position while under pressure (Figure 20)

NOTICE

Never run the Log Splitter unless the Hydraulic Fluid Tank is at the proper level.

5. Place the log on the Log Splitter. Grasp the log on the sides near the middle of the block (Figure 21). Center the log, side-to-side, on the rail of the Log Splitter, making sure that one end is against the Stop Base.
6. Using only your hand, push the Valve Control Handle forward (towards the log) (Figure 22). If the log moves before it is contacted by the Wedge, release the Valve Control Handle and then reposition the log.
7. Hold the Valve Control Handle, moving the Wedge towards the Log until the log is split or the cylinder rod stops at its maximum travel position. Stop the Log Splitter (forward movement), at any point in the splitting process, if you feel an unsafe splitting condition is occurring. As the log is being split, DO NOT reach forward and attempt to catch the split wood — let it fall to the ground/Tray.
8. Once the Wedge reaches its full forward travel, let go of the Valve Control Handle and the Wedge will stay at that position.

NOTICE

If the log does not split immediately, do not continue the forward thrust of the Ram for more than five (5) seconds. This can damage the Splitter. Try repositioning the log on the Splitter or set the log aside.

9. Load another log on the other side of the Wedge and pull the Valve Control Handle, moving the Wedge towards you and the Log until the log is split or the cylinder rod stops at its maximum travel position.

Splitting Large Logs

When splitting a large log, or one in which the wood is extremely tough or stringy (such as elm), the first pass through the Splitter may not split the log into two sections. If this happens, turn the log and split off small sections. Repeat this process as necessary to split the entire log.

CAUTION

Depending on the type of wood being split, a log may not always split into two pieces and fall onto the Trays. If a log sticks to the Wedge, move the Wedge away from the Base, stop the Engine, and carefully remove the log from the Wedge. If the Log is stuck onto the Wedge and you can't remove it by hand, a piece of wood cut into a Wedge shape can be used between the Log and Base to lift the Log from the machine as you actuate the Lever.

Chapter 4: Maintaining The DR DUAL-ACTION 3 PT HITCH LOG SPLITTER

Regular maintenance is the way to ensure the best performance and long life of your machine. Please refer to this manual and the Tractor manufacturer's owner's manual for maintenance procedures.

WARNING

Before performing any maintenance procedure or inspection, stop the Tractor, set the Brake and remove the Key, wait five (5) minutes to allow all parts to cool.

Regular Maintenance Checklist

PROCEDURE	BEFORE EACH USE	EVERY 25 HOURS	EVERY 100 HOURS
Check General Equipment Condition	▲		
Check Wedge for Sharpness	▲		

General Maintenance Check (before operating)

The Hydraulic System (hoses and cylinder) should be carefully inspected before each use. Also, inspect the mechanical parts at the same time. Make sure all clamps, nuts, bolts, fittings, etc., are properly installed and tightened.

WARNING

Do not check for leaks with your hand. Leaks can be located by passing a piece of cardboard or wood around the suspected leak and looking for discoloration. High-pressure fluid escaping from a very small hole can be almost invisible. Escaping fluid under pressure can have sufficient force to penetrate skin, causing serious injury or even death. If fluid is injected into your skin, it must be treated immediately by a doctor familiar with this type of injury.

Always replace frayed, kinked, or cracked hoses and/or other damaged hydraulic components with DR Power Equipments authorized parts and components specified in the "Parts" section (Chapter 6) of this manual. Replacement parts from secondary suppliers (not original DR Power Equipments replacement parts) can lead to product damage and/or personal injury, and will void the warranty.

Should it become necessary to loosen or remove any hydraulic fitting or line, be sure to relieve all hydraulic pressure by shutting off the Tractor and moving the valve control handle back and forth several times until no cylinder movement is visible.

Chapter 5: Troubleshooting

Most problems are easy to fix. Consult the Troubleshooting Table below for common problems and their solutions. If you continue to experience problems, contact us at www.DRpower.com or call toll-free 1-800-DR-OWNER (376-9637) for support.

WARNING

Before performing any maintenance procedure or inspection, stop the Tractor, set the Brake and remove the Key, wait five (5) minutes to allow all parts to cool.

Troubleshooting Table

SYMPTOM	POSSIBLE CAUSE
<i>When the Valve Control Handle is pushed, the Wedge does not move.</i>	<ul style="list-style-type: none">⇒ Check the Tractor to make sure the hydraulic fluid level is correct. If the fluid level is not correct, fill with hydraulic fluid as described in your Tractor manual.⇒ Check the Tractor Hoses to make sure the hydraulic fluid is flowing. Hoses should be vibrating when fluid is flowing.⇒ If the fluid level is OK then contact us at www.DRpower.com for assistance.
<i>The Splitter lacks power</i>	<ul style="list-style-type: none">⇒ Tractor throttle is set too low; Adjust Tractor throttle.⇒ Tractor pressure low; Check the pressure output of the Tractor.⇒ If your Splitter still lacks power, contact us at www.DRpower.com for assistance.
<i>The splitting Wedge moves slowly, but will split wood.</i>	<ul style="list-style-type: none">⇒ Check the hydraulic fluid level in the Tractors Hydraulic Tank and fill as necessary.⇒ Check the high-pressure hose, fittings, and valve openings for dirt and debris that may have obstructed the openings.
<i>The splitting Wedge moves in the opposite direction than Operator Lever is pushed.</i>	<ul style="list-style-type: none">⇒ Hoses from Splitter to Tractor are connected to the wrong ports; Swap Hose connections.

Chapter 6: Parts Lists and Schematic Diagrams

Parts List - BEAM ASSEMBLY

NOTE: Part numbers listed are available through DR Power Equipment.

<u>Ref#</u>	<u>Part#</u>	<u>Description</u>	<u>Ref#</u>	<u>Part#</u>	<u>Description</u>
1	16003	Pin, Hitch Clip, 1/2" To 9/16", .12" Wire	16	29046	Brace, Lower Cylinder
2	11241	Washer, Flat, 5/16", USS	17	29370	Guard, Seal
3	29047	Valve, Hyd, 3200 Psi	18	29519	Label, DR Branding
4	29043	Cylinder Assembly, Hydraulic	19	29395	Label, Warning, Do Not Sit or Stand
5	11158	Bolt, HCS, 5/16-18 X 1"	20	29389	Tray, Log, With Labels
6	11243	Washer, Lock, Split, 5/16"	21	29388	Cover, Valve, With Label
7	11072	Nut, Nylon Lock, 1/2-13	22	29394	Label, Controls
8	29502	Washer, 26mm X 44mm X 3.5mm	23	29373	Bolt, HCS, 3/8-16 X 5.5", Gr5, ZP
9	29375	Bolt, HHCS, 1-14 X 6", Gr5, ZP	24	15131	Plug, Hour Meter Hole, 2" X 1-1/4"
10	23499	Washer, SAE Flat, 1/2", ZP	25	11075	Nut, Nylon Lock, 3/8-16
11	25311	Pin, Cotter, 3/16 X 2.5"	26	11238	Washer, Flat, 1/4", USS
12	25346	Hyd Adapter, Jcm06-Obm08	27	12321	Bolt, HCS, 5/16-18 X .75"
13	29371	Hyd Adapter, Obm08-Jcsf06	28	11076	Nut, Nylon Lock, 5/16-18
14	22909	Bolt, HHCS, 1/2-13 X 1.5", Gr5, ZP	29	29513	Handle Assembly, Control Valve
15	25310	Nut, Slotted, 1-14, ZP	30	29503	O-ring, 22mm X 2.4mm

Items Not shown in illustration

15043	Bolt, HHCS, 3/8-16 X 1-1/4", Gr5
29379	Tube Clamp, 3/4", Vinyl Coated

Schematic – BEAM ASSEMBLY

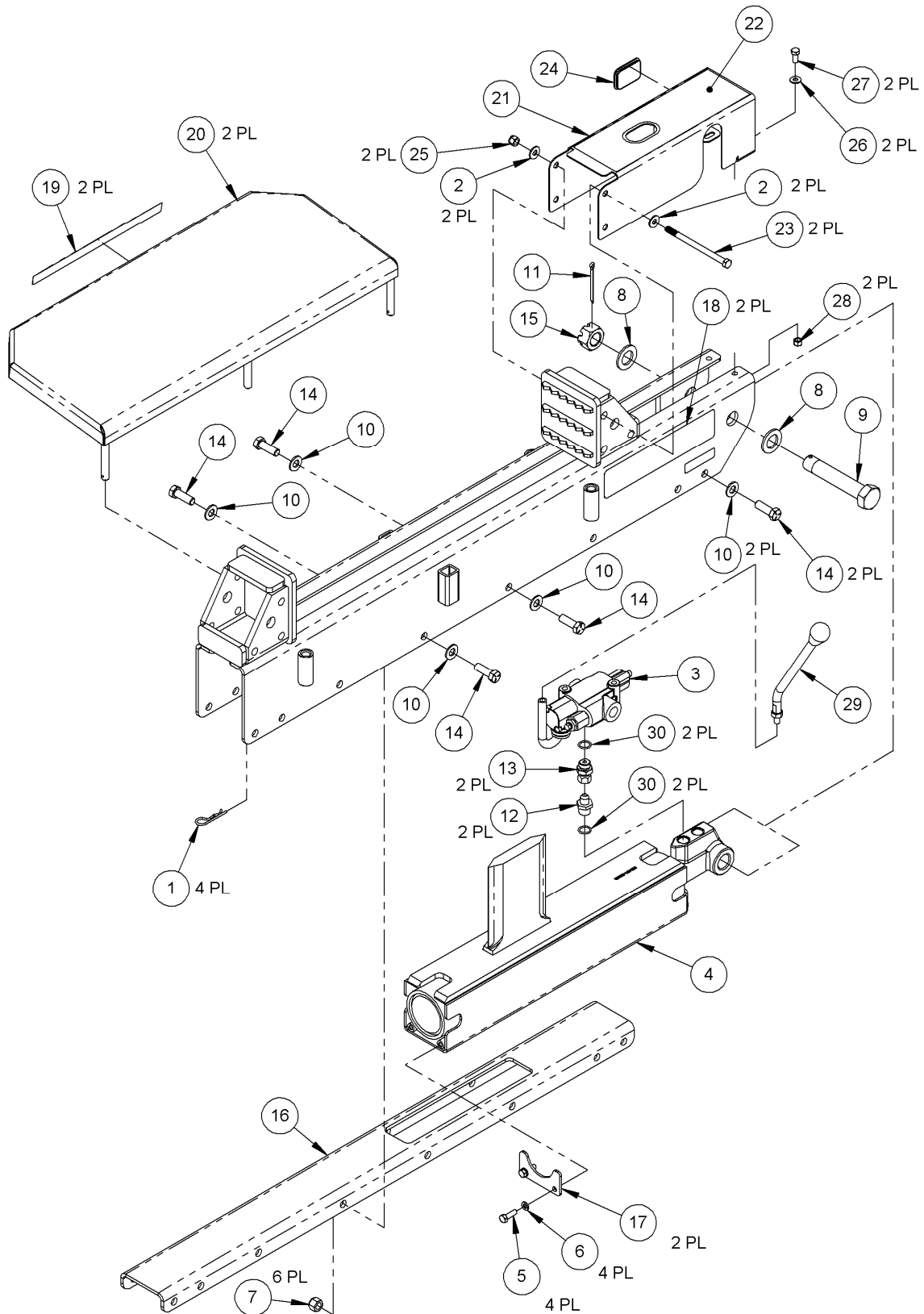

Parts List – 3 PT HITCH

NOTE: Part numbers listed are available through DR Power Equipment.

<u>Ref#</u>	<u>Part#</u>	<u>Description</u>	<u>Ref#</u>	<u>Part#</u>	<u>Description</u>
1	11241	Washer, Flat, 5/16", USS	11	24538	Pin, Lynch, 3/16" X 1-9/16"
2	11075	Nut, Nylon Lock, 3/8-16	12	29359	Bracket, Mounting, Left, 3 PT
3	22909	Bolt, HHCS, 1/2-13 X 1.5", Gr5, ZP	13	29360	Bracket, Mounting, Right, 3 PT
4	23499	Washer, SAE Flat, 1/2", ZP	14	29362	Axle, 3 PT
5	11072	Nut, Nylon Lock, 1/2-13	15	12336	Bolt, HHC, 5/16-18 X 1-1/4"
6	15043	Bolt, HHCS, 3/8-16 X 1-1/4", Gr5	16	11076	Nut, Nylon Lock, 5/16-18
7	29379	Tube Clamp, 3/4", Vinyl Coated	<u>Items Not shown in illustration</u>		
8	29363	Hose, Hyd, 100"	27610		Sheathing, Abrasion Resistant, 15.5"
9	29361	Brace, Cross, 3 PT	11214		Tie, Cable, 7 1/2"L
10	24537	Pin, Hitch, 3/4" X 6"			

Schematic – 3 PT HITCH

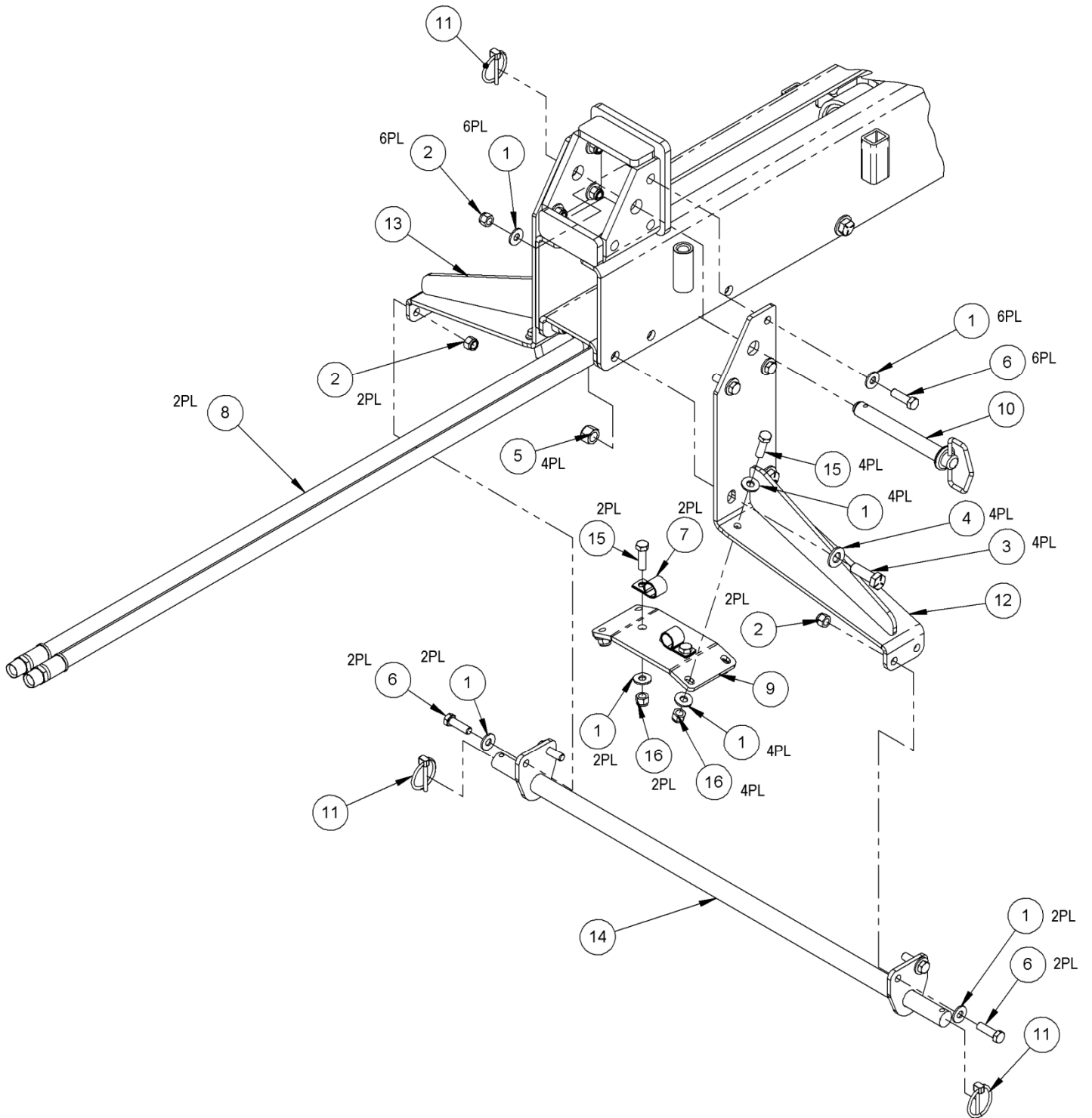

Daily Checklist for the DR 3 PT HITCH LOG SPLITTER

To help maintain your DR 3 PT HITCH LOG SPLITTER for optimum performance, we recommend you follow this checklist each time you use your Log Splitter.

! WARNING

Before performing any maintenance procedure or inspection, stop the tractor and remove the key, wait five (5) minutes to allow all parts to cool.

- Check the general condition of the Log Splitter, e.g.; nuts, bolts, welds, etc.
- Check hydraulic fluid level in your Tractor and fill as needed.
- Check hydraulic Hoses for cracks or wear.
- Check the Frame for wear and damage.
- Check the Wedge for tightness, nicks and wear.

End of Season and Storage

! WARNING

Before performing any maintenance procedure or inspection, stop the tractor and remove the key, wait five (5) minutes to allow all parts to cool.

- Check the Wedge for nicks and wear. Sharpen if needed.
- Clean the exterior of the unit to remove all dirt, grease, and any other foreign material. To prevent rust, touch up painted surfaces that have been scratched or chipped.
- Be sure all nuts, bolts, and screws are securely fastened.
- If possible, store the Log Splitter in a dry, protected place. If it is necessary to store the Log Splitter outside, cover it with a protective material.



75 MEIGS ROAD, P.O. BOX 25, VERGENNES, VERMONT 05491