

# DR<sup>®</sup> SNOW BLOWER

## SAFETY & OPERATING INSTRUCTIONS



**Models:**  
PRO 24B  
PRO 28B  
PRO XL30B

Serial No. \_\_\_\_\_

Order No. \_\_\_\_\_

DR Power Equipment  
Toll-free phone: 1-800-DR-OWNER (376-9637)  
Website: [www.DRpower.com](http://www.DRpower.com)

### **WARNING**

Read and understand this manual and all instructions before operating the DR SNOW BLOWER.

# Table of Contents

Chapter 1: General Safety Rules..... 3

Chapter 2: Setting Up the DR SNOW BLOWER..... 7

Chapter 3: Operating the DR SNOW BLOWER ..... 14

Chapter 4: Maintaining the DR SNOW BLOWER ..... 18

Chapter 5: Troubleshooting ..... 23

Chapter 6: Parts Lists and Schematic Diagrams..... 25

## Conventions used in this manual

### **WARNING**

This indicates a hazardous situation, which, if not avoided, **could** result in death or serious injury.

### **CAUTION**

This indicates a hazardous situation, which, if not avoided, **could** result in minor or moderate injury.

### **NOTICE**

This information is important in the proper use of your machine. Failure to follow this instruction could result in damage to your machine or property.

## Serial Number and Order Number

A Serial Number is used to identify your machine and is located on the Serial Number Label on your machine (**Figure 1**). An Order Number is used to check and maintain your order history and is located on your packing slip. For your convenience and ready reference, enter the Serial Number and Order Number in the space provided on the front cover of this manual.

## Additional Information and Potential Changes

DR Power Equipment reserves the right to discontinue, change, and improve its products at any time without notice or obligation to the purchaser. The descriptions and specifications contained in this manual were in effect at printing. Equipment described within this manual may be optional. Some illustrations may not be applicable to your machine.

## California Proposition 65

 **WARNING**  
**CANCER AND REPRODUCTIVE HARM - [www.P65Warnings.ca.gov](http://www.P65Warnings.ca.gov).**

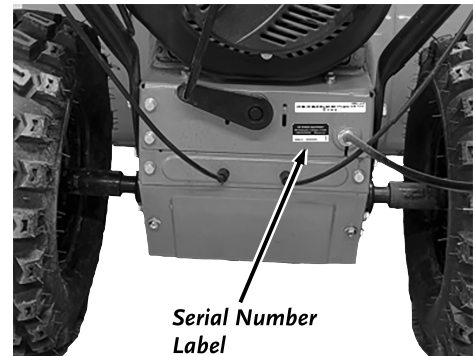

Figure 1

# Chapter 1: General Safety Rules

## ! WARNING

Read this safety & operating Instructions manual before you use the DR SNOW BLOWER. Become familiar with the operation and service recommendations to ensure the best performance from your machine. If you have any questions or need assistance, please contact us at [www.DRpower.com](http://www.DRpower.com) or call toll-free 1-800-DR-OWNER (376-9637) and one of our Technical Support Representatives will be happy to help you.

### Labels

Your DR SNOW BLOWER carries prominent labels as reminders for its proper and safe use. Shown below are copies of all the Safety and Information labels that appear on the equipment. Take a moment to study them and make a note of their location on your SNOW BLOWER as you set up and before you operate the unit. Replace damaged or missing safety and information labels immediately.



#A0004516267



#A0004510884



#A0004510881



#A0004510883



#A0004516269



#A0004510885



#423731



#423751



#423741

## Protecting Yourself and Those Around You

---

### **WARNING**

This is a high-powered machine, with moving parts operating with high energy. You must operate the machine safely. Unsafe operation can create several hazards for you, as well as anyone else in the nearby area. Always take the following precautions when using this machine:

- Keep in mind that the operator or user is responsible for accidents or hazards occurring to other people, their property, and themselves.
  - Always wear protective goggles or safety glasses with side shields while using the SNOW BLOWER to protect your eyes from possible thrown debris.
  - Avoid wearing loose clothing or jewelry, which can catch on moving parts.
  - We recommend wearing gloves while using the SNOW BLOWER. Be sure your gloves fit properly and do not have loose cuffs or drawstrings.
  - Wear shoes with non-slip treads when using your SNOW BLOWER. If you have safety shoes, we recommend wearing them. Wear long pants while operating the SNOW BLOWER.
  - Use ear protectors or ear plugs rated for at least 20 dba to protect your hearing.
  - Keep bystanders at least 75 feet away from your work area at all times. Stop the engine when another person or pet approaches.
- 

## Safety for Children and Pets

---

### **WARNING**

Accidents can occur if the operator is not alert to the presence of children and pets. Children are often attracted to the machine and the snow blowing activity. *Never* assume that children will remain where you last saw them. Always follow these precautions:

- Keep children and pets at least 75 feet from the working area and ensure they are under the watchful care of a responsible adult.
  - Be alert and turn the machine off if children or pets enter the work area.
  - Never allow children to operate the SNOW BLOWER.
- 

## Safety with Extension Cords

---

### **WARNING**

Never overlook the hazards of electricity. Always follow these precautions:

- Never open the Control Box cover. Never attempt any electrical repairs yourself. If in doubt, consult a qualified electrician, visit our website at [www.DRpower.com](http://www.DRpower.com), or contact DR Power Equipment for toll-free support at: 1-800-DR-OWNER (376-9637) for help or information.
  - Never use an extension cord that is not rated for outdoor use.
  - Never connect the Cord to the Snow Blower if there is an electrical hazard present.
  - Never connect the Cord to the Snow Blower in wet conditions.
  - Never connect the Cord to the Snow Blower with a damaged extension cord.
  - Always grasp the electrical cord plug when unplugging the cord from the outlet; never pull the plug out by the cord. Make sure your fingers do not touch the metal prongs when plugging or unplugging.
  - Never Start the Snow Blower unless the electrical cord is plugged into a properly grounded outlet, which supplies 110-120V power, and is protected by a 15-amp circuit breaker.
  - Never tamper with safety devices. Check their proper operation regularly.
  - When using an extension cord, keep the connection between the Control Box and the extension cord well away from any water.
-



## ***Safety with Extension Cords (Continued)***

---

### **WARNING**

- Never use an extension cord longer than 25 feet and smaller than 12 awg in diameter, or longer than 50 feet and smaller than 10 awg in diameter; the cord will produce a voltage drop that will prevent the starter from supplying full power and may cause damage to the Starter or Control Box. Use of a smaller diameter (larger awg number) extension cord could result in melting of the insulation or even create a fire.
  - Always keep the electrical cord and/or extension cord away from excessive heat, oil, and sharp objects.
- 

## ***Safety with Gasoline - Powered Machines***

---

### **WARNING**

Gasoline is a highly flammable liquid. Gasoline also gives off flammable vapor that can be easily ignited and cause a fire or explosion. Never overlook the hazards of gasoline. Always follow these precautions:

- Never run the engine in an enclosed area or without proper ventilation as the exhaust from the engine contains carbon monoxide, which is an odorless, tasteless, and deadly poisonous gas.
  - Store all fuel and oil in containers specifically designed and approved for this purpose and keep away from heat and open flame, and out of the reach of children.
  - Replace rubber fuel lines and grommets when worn or damaged and after 5 years of use.
  - Fill the gasoline tank outdoors with the engine off and allow the engine to cool completely. Don't handle gasoline if you or anyone nearby is smoking, or if you're near anything that could cause it to ignite or explode. Reinstall the Fuel Tank Cap and Fuel Container Cap securely.
  - If you spill gasoline, do not attempt to start the engine. Move the machine away from the area of the spill and avoid creating any source of ignition until the gas vapors have dissipated. Wipe up any spilled fuel to prevent a fire hazard and properly dispose of the waste.
  - Allow the engine to cool completely before storing in any enclosure. Never store a machine that has gas in the tank, or a fuel container, near an open flame or spark such as a water heater, space heater, clothes dryer or furnace.
  - Never make adjustments or repairs with the engine running. Shut down the engine, disconnect the spark plug wire, keeping it away from the spark plug to prevent accidental starting, wait 5 minutes before making adjustments or repairs.
  - Never tamper with the engine's governor setting. The governor controls the maximum safe operation speed and protects the engine. Over-speeding the engine is dangerous and will cause damage to the engine and to the other moving parts of the machine. If required, see your authorized dealer for engine governor adjustments.
  - Keep combustible substances away from the engine when it is hot.
  - Never cover the machine while the muffler is still hot.
  - The muffler and engine become very hot and can cause a severe burn; do not touch.
- 

## ***General Safety***

---

### **WARNING**

Operating this SNOW BLOWER safely is necessary to prevent or minimize the risk of death or serious injury. Unsafe operation can create a number of hazards for you. Always take the following precautions when operating this SNOW BLOWER:

- Your SNOW BLOWER is a powerful tool, not a plaything. Exercise extreme caution at all times. The machine is designed to blow snow. Do not use it for any other purpose.
  - Know how to stop the SNOW BLOWER quickly; see "stopping the engine" in chapter 3.
  - Wear winter tread boots designed for snow and ice traction to avoid slipping or falling.
  - See manufacturer's instructions for proper operation and installation of accessories. Only use accessories approved by DR Power Equipment.
  - Never use the machine without ensuring that all guards and shields are in place.
-

## General Safety (Continued)

---

### **WARNING**

- Never, under any conditions, remove, bend, cut, fit, weld, or otherwise alter standard parts on the SNOW BLOWER. This includes all shields and guards. Modifications to your machine could cause personal injuries and property damage and will void your warranty.
  - Allow only one person to operate the SNOW BLOWER at any time.
  - If the machine should start making an unusual noise or vibration, shut down the engine, disconnect the spark plug wire, keeping it away from the spark plug to prevent accidental starting, wait 5 minutes, then inspect for damage. Vibration is generally a warning of trouble. Check for damaged parts and clean, repair, and/or replace as necessary.
  - Never tamper with safety devices. Check their proper operation regularly.
  - Before performing any maintenance or inspection procedure on the SNOW BLOWER, stop the engine, remove the Safety Key, and wait five minutes to allow all parts to cool.
  - Never allow people who are unfamiliar with these instructions to use the SNOW BLOWER. Allow only responsible individuals who are familiar with these rules of safe operation to use your machine.
  - Never overload or attempt to use the SNOW BLOWER beyond the manufacturer's recommendation. Personal injury or damage to the machine could result.
  - While using the SNOW BLOWER, don't hurry or take things for granted. When in doubt about the equipment or your surroundings, stop the machine and take the time to look things over.
  - Never operate the machine when under the influence of alcohol, drugs, or medication.
  - Stay alert for hidden hazards or traffic.
  - Keep all nuts and bolts tight and keep the equipment in good operating condition.
- 

### **A Note to All Users**

Under California law, and the laws of some other states, you are not permitted to operate an internal combustion engine using hydrocarbon fuels without an engine spark arrester. This also applies to operation on US Forest Lands. All DR® SNOW BLOWERS shipped to California, New Mexico, and Washington State are provided with spark arresters. Failure of the owner or operator to maintain this equipment in compliance with state regulations is a misdemeanor under California law and may be in violation of other state and/or federal regulations. Contact your State Park Association or the appropriate state organization for specific information in your area.

No list of warnings and cautions can be all-inclusive. If situations occur that are not covered by this manual, the operator must apply common sense and operate this DR SNOW BLOWER in a safe manner. Contact us at [www.DRpower.com](http://www.DRpower.com) or call 1-800-DR-OWNER (376-9637) for assistance.

## Chapter 2: Setting Up the DR SNOW BLOWER

It may be helpful to familiarize yourself with the controls and features of your DR SNOW BLOWER as shown in **Figure 2** before beginning these procedures. If you have any questions at all, please feel free to contact us at [www.DRpower.com](http://www.DRpower.com).

### DR SNOW BLOWER Controls and Features

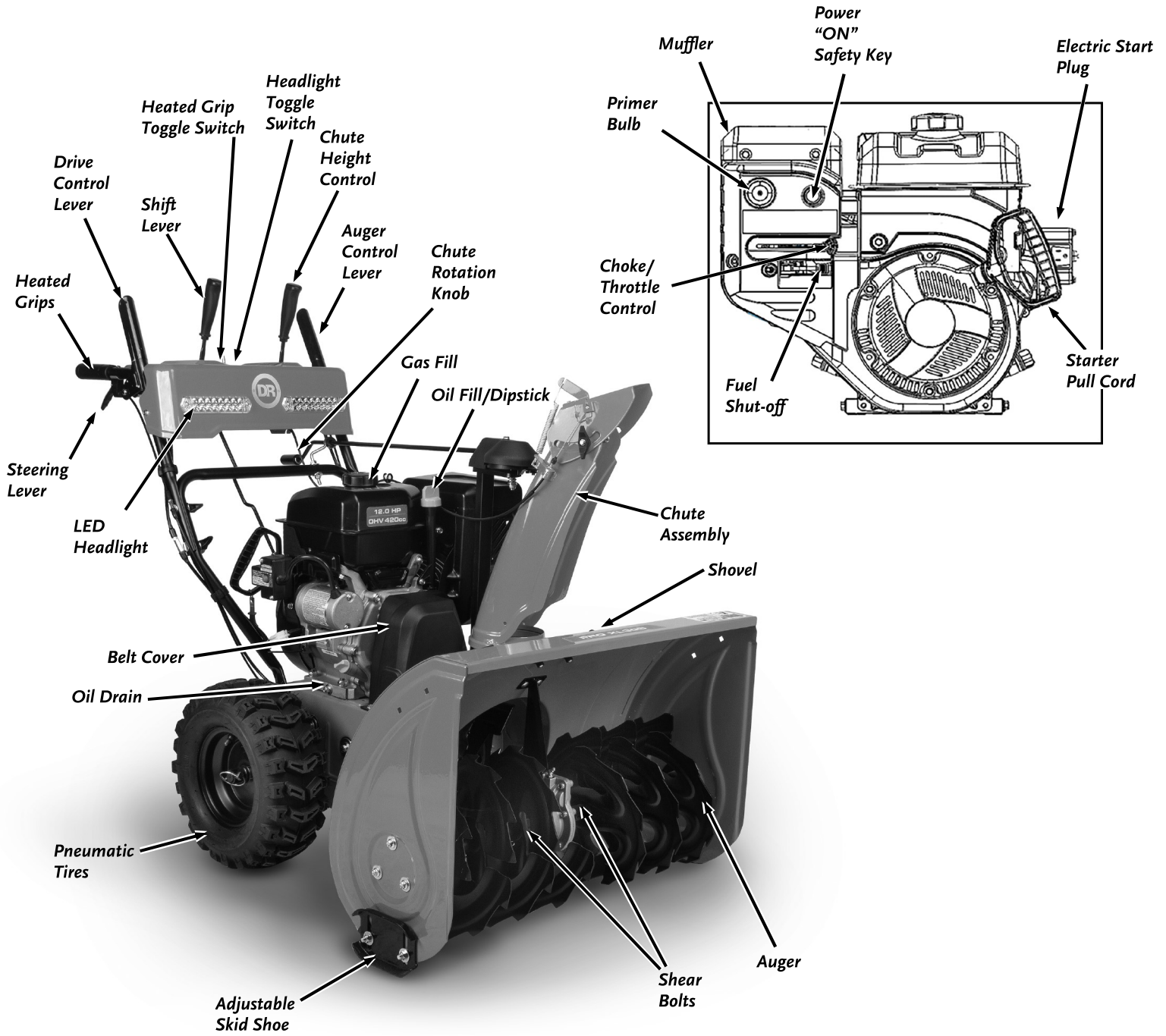
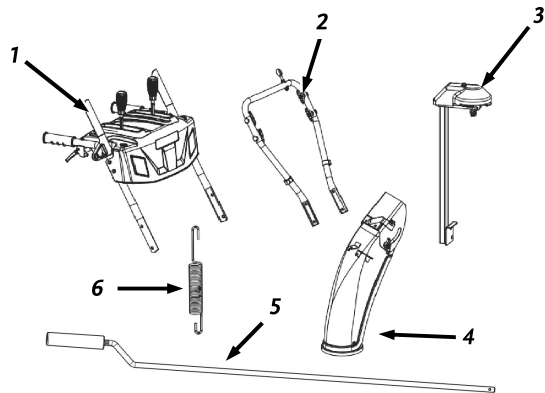

Figure 2

## Specifications

Model	PRO 24B	PRO 28B	PRO XL30B
Clearing Width - Inch (mm)	24 (609)	28 (711)	30 (764)
Intake Height - Inch (mm)	21 (533)		
Throwing Distance – Ft (m)	≤ 40ft (12.2m)	≤ 40ft (12.2m)	≤ 45ft (13.7m)
Starting System	110V Electric with Recoil Back-up		
Transmission Type	Friction Disc		
Speeds	6 Forward, 2 Reverse		
Wheel Size	14x5.00-6	15x6.50-7	
Chute Rotation	Hand Crank, 190° Turning Radius		
Ice Chopping Auger	Yes		
EZ Turn System	Yes, Steering Levers		
One Handed Operation	Yes		
Heated Grips	Yes		
Headlight	LED		
Operator Controls	Shift Lever, Drive Control, Auger Control, Chute Controls, Steering Levers, Headlight Toggle Switch, Heated Grip Toggle Switch		
Machine Dimensions – Inch (cm)	52.5x26x44 (133.4x66x111.8)	52.5x30x44 (133.4x76.2x111.8)	54x32x46 (137.2x81.3x116.8)
Machine Weight - Pound (Kg)	185 (84)	220 (99.8)	246 (111.6)



### Components Supplied (Figure 3):

Item#	Description	Qty
1	Upper Handle Assembly	1
2	Lower Handle Assembly	1
3	Chute Rotation Support	1
4	Chute Deflector	1
5	Chute Rotator	1
6	Chute Spring	1

Compare the contents with the “Components Supplied” list above. If you have any questions, please contact us at [www.DRpower.com](http://www.DRpower.com) or call 1-800-DR-OWNER (376-9637) for assistance.

Figure 3

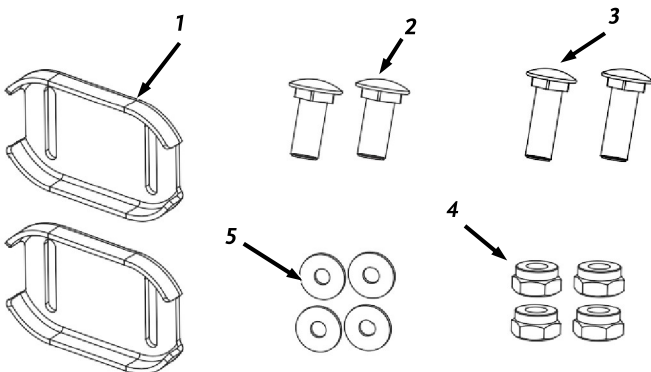

### Parts Box (Figure 4):

Item#	Description	Qty
1	Skid Plate	2
2	M8x20 Carriage Bolt	2
3	M8x25 Carriage Bolt	2
4	Lock Nut	4
5	Large Washer	4

Compare the contents with the “Parts Box” list above. If you have any questions, please contact us at [www.DRpower.com](http://www.DRpower.com) or call 1-800-DR-OWNER (376-9637) for assistance.

Figure 4

**Parts Bags (Figure 5):**

Item#	Description	Qty
1	Drive Speed Control Rod	1
2	Spring	1
3	Flat Cotter Pin	1
4	8mm Washer	2
5	Shear Pin	2
6	Bowtie Clip	2
7	Flat Cotter Pin	2
8	Spark Plug Wrench Handle	1
9	Spark Plug Wrench	1

Compare the contents with the “Parts Bags” list above. If you have any questions please contact us at [www.DRpower.com](http://www.DRpower.com) or call 1-800-DR-OWNER (376-9637) for assistance.

**Assembly Instructions**

**Tools Needed:**

- 10mm Wrench
- 13mm Wrench
- Wire Cutters
- Eye Protection

**Installing Handlebars**

1. Remove the four M8x25 Flange Bolts, Spring Spacers, and Flat Spacers from Frame (**Figure 6**).
2. Install Lower Handlebar into two holes located on each side of the Frame (**Figure 6**).
3. With an assistant, install Upper Handlebar onto Lower Handlebar using the four M8x50 Handle Bolts, Spacers, and Handle Knobs (**Figure 7**).

*Note: Use pre-installed handle knobs on lower handlebar assembly to install upper handlebar assembly.*

4. Install top of Auger Cable and Drive Cable into the holes on the left and right Handles (**Figure 8**).
5. Install Cable Threads into panel of respective Handlebar. Adjust Cable Tension as necessary.

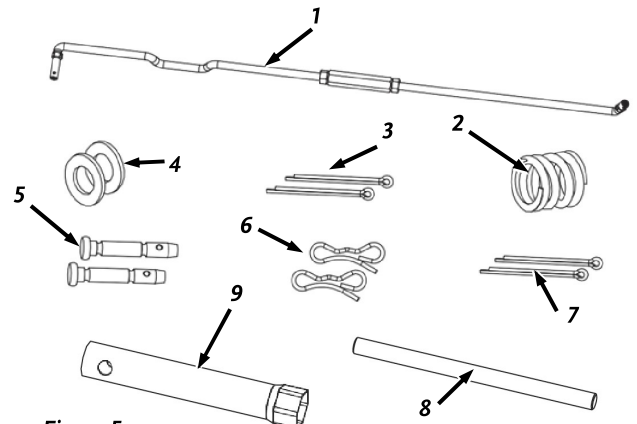

Figure 5

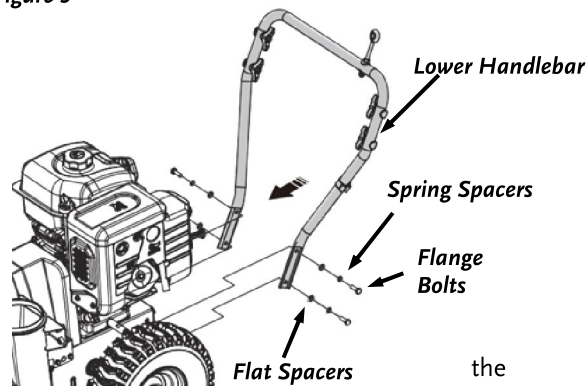

Figure 6

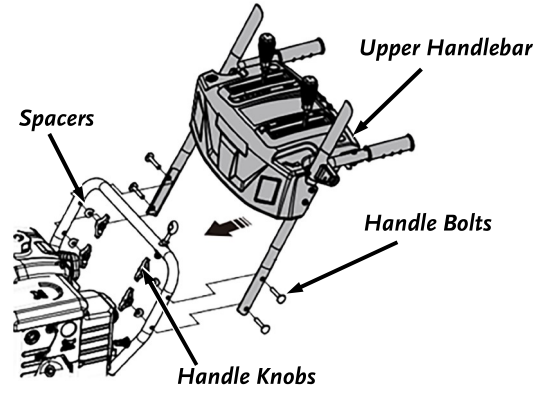

Figure 7

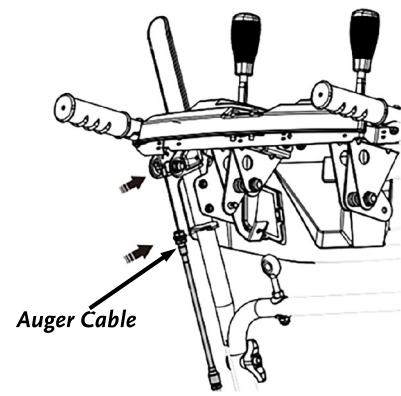

Figure 8

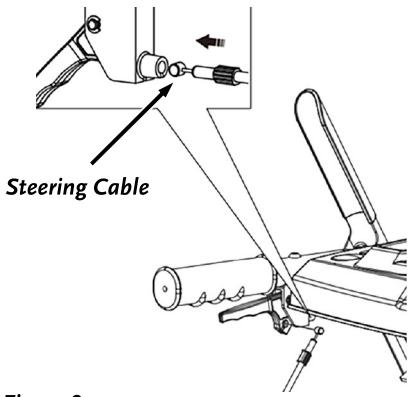

Figure 9

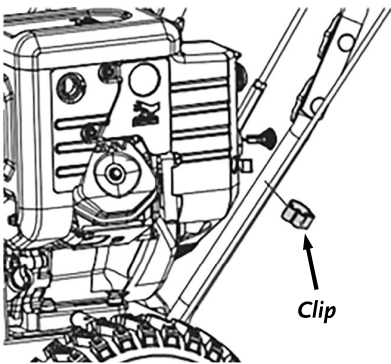

Figure 10

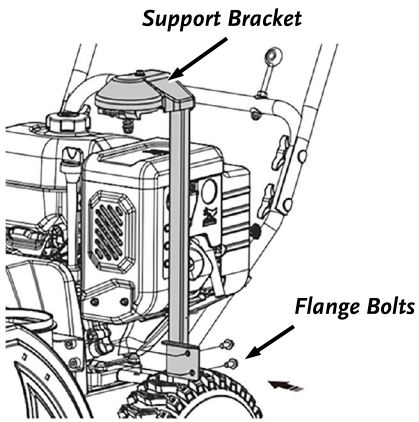

Figure 11

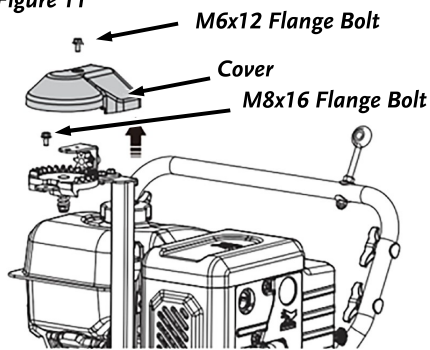

Figure 12

6. Install the Steering Cable Barrels into the Steering Handles (**Figure 9**).
7. Install the Steering Cables into the Cylindrical Holes in front of the Steering Handle.
8. Use the Clip to lock the Steering Cables on their respective Handlebars (**Figure 10**).

### Assembling Chute

1. Remove the two M8x16 Flange Bolts. Install Chute Rotation Support bracket on Auger Housing using the Bolts (**Figure 11**).
2. Remove the Cover by removing the M6x12 Flange Bolt and the M8x16 Flange Bolt from the Chute Rotation Support (**Figure 12**).
3. Install Deflector Chute and secure with M8x16 Flange Bolt (**Figure 13**).
4. Insert eyelet end of the Deflector Chute Cable into the Hole. Secure the Cable Screw in the Slot and tighten the M8 Nut (**Figure 14**).
5. Install long end of Snow Outlet Extension Spring into upper slot and the short end into the lower slot (**Figure 15**).

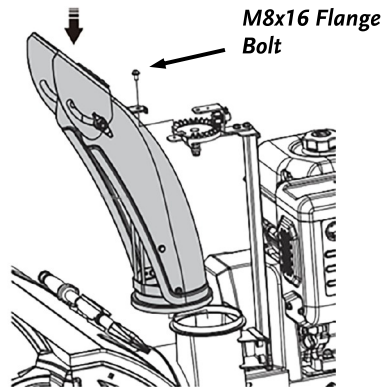

Figure 13

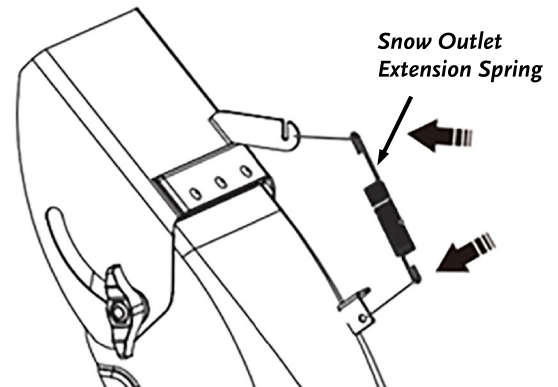

Figure 15

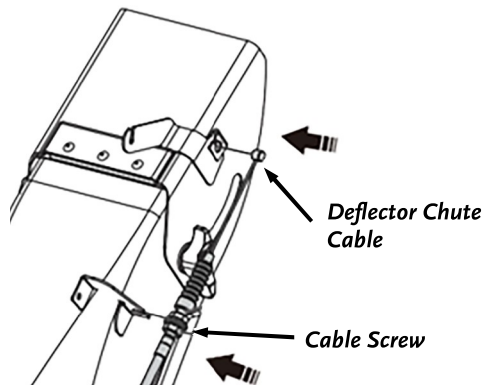

Figure 14



## Installing Chute Rotator

1. Insert Chute Rotator through Rubber Bushing of the Fixed Rod (**Figure 16**).
2. Install Chute Rotator into Steering Gear Hole and insert the Pin (**Figure 17**).
3. Install the Cover and secure it with the M6x12 Flange Bolt.

## Installing Drive Speed Control Rod

1. Install the long bent end of the Drive Speed Control Rod to the Control Panel and secure it with the connecting Rod Spring, Flat Washer, and Cotter Pin (**Figure 18**).
2. Pull the Shift Connecting Plate upwards and install short bent end of the Drive Speed Control Rod. Attach the Drive Speed Control Rod with the flat washer and cotter pin (**Figure 19**).

## Installing Skid Plate

1. Remove Skid Plate Hardware from the Skid Plate (**Figure 20**).
2. Install the Skid Plate and secure it with the provided hardware; M8x25 Bolt, M8x20 Bolt, Large Washer, and Lock Nut.

## Installing Wiring

1. Connect LED Light and Heated Grip Cable Plugs to Engine Output Cable Plugs (**Figure 21**).
2. Secure Wiring Cables to Handlebar Assembly using Clips.

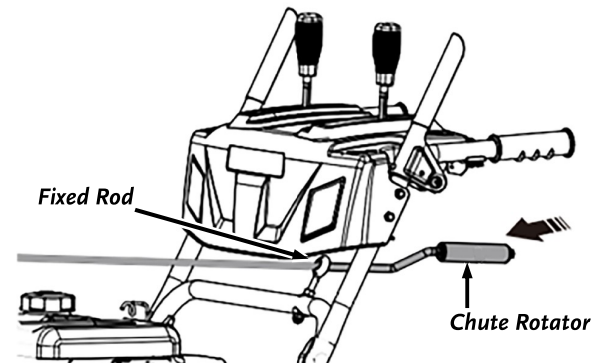

Figure 16

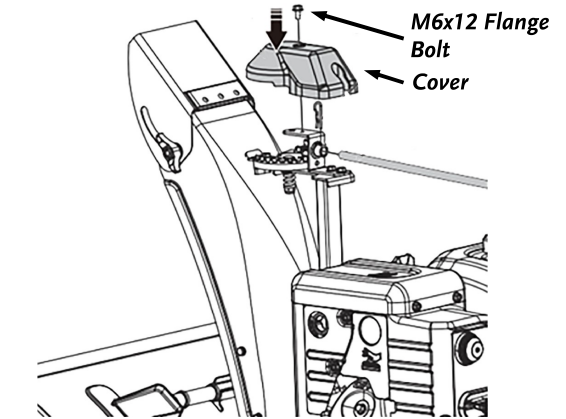

Figure 17

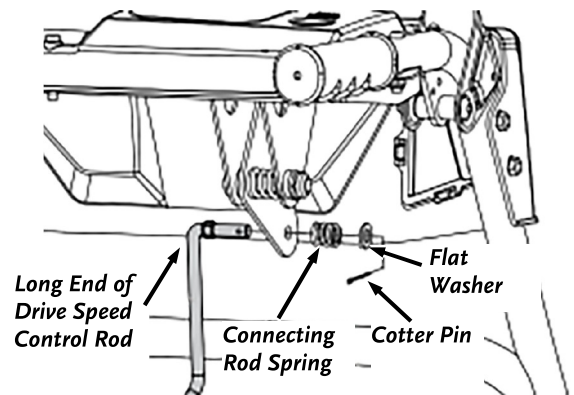

Figure 18

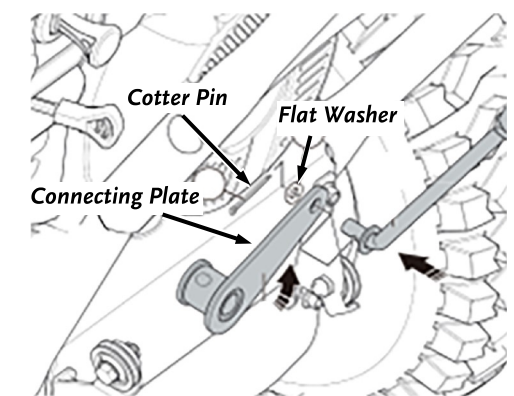

Figure 19

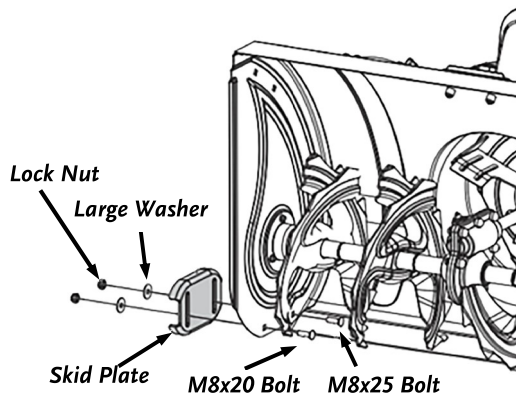

Figure 20

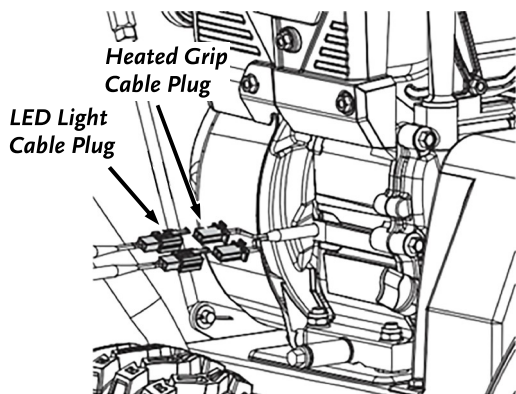

Figure 21





**Figure 22**

## ***Check the Tire Pressure***

---

### **! WARNING**

Do not over inflate the tires. Inflate to the manufacturers recommended pressure found on the tires.

---

#### **Tools Needed:**

- Tire Pressure Gauge
- Air Compressor

1. Remove the Valve Stem Protective Cap (**Figure 22**) and check the tire pressure with a Tire Pressure Gauge.
2. Compare the tire pressure reading with the manufacturer's recommended tire pressure stamped on the side of the tire.
3. If the pressure is too low, add air through the Valve Stem with an air hose.
4. Replace the Valve Stem Protective Cap when finished.

## Adding Oil and Gasoline

### NOTICE

- You must add oil before starting the engine. This machine is shipped without oil. Traces of oil may be in the reservoir from factory testing, but you must add oil before starting the engine. Fill the reservoir slowly, checking the level frequently to avoid overfilling.
- To get an accurate reading when checking the oil level:
  - The Engine must be level.
  - The Oil Fill/Dipstick should not be screwed down to ensure an accurate oil level reading.

<b>Engine Oil</b>	5W-30 or 0W-30: -30°F (-34°C) or higher 0W-30: -13°F (-25°C) or lower
<b>Fuel</b>	Unleaded gasoline. Minimum 90 Octane rating. Maximum 10% ethanol (E10).

**Note:** Use only the recommended high detergent engine oil. Other types of oil could cause problems operating your machine. Please refer to your Engine Owner's Manual for detailed oil information.

1. Position the machine so the Frame and Engine are level. Remove the Oil Fill/Dipstick (**Figure 23**) and clean the end of it with a rag.
2. Machines are shipped with no oil. Initially add 3/4 of the oil recommended by the Engine Manufacturer (see oil quantities in your Engine User Manual). Wait one minute for the oil to settle.
3. Insert the Oil Fill/Dipstick without screwing it in and check the oil level. Clean the Oil Fill/Dipstick with the rag after checking.
4. Continue adding a few ounces of oil at a time, rechecking the Oil Fill/Dipstick until the oil reaches the fill mark. Be careful not to overfill.
5. When full, replace the Oil Fill/Dipstick and screw all the way down.
6. Remove the Gas Fill Cap and fill the Gas Tank with fresh, unleaded gas (with a minimum of 90 Octane) to approximately 1" to 1-1/2" below the top of the fill neck to allow for fuel expansion. Be careful not to overfill and ensure you reinstall the Gas Fill Cap before starting the engine. See your Engine Owner's Manual for more detailed information.

**Note:** To refill the Gas Tank, turn the Engine OFF and let the Engine cool at least five minutes before removing the Gas Fill Cap.

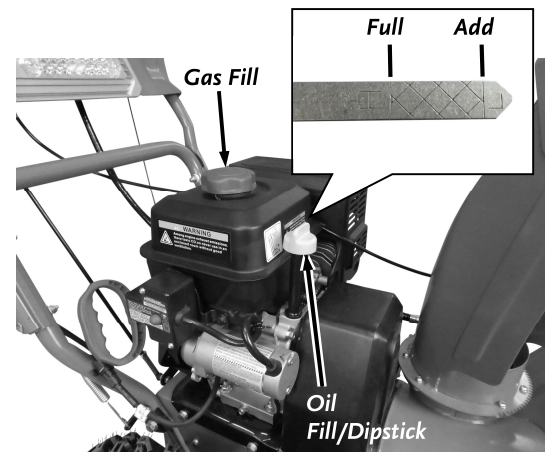

Figure 23

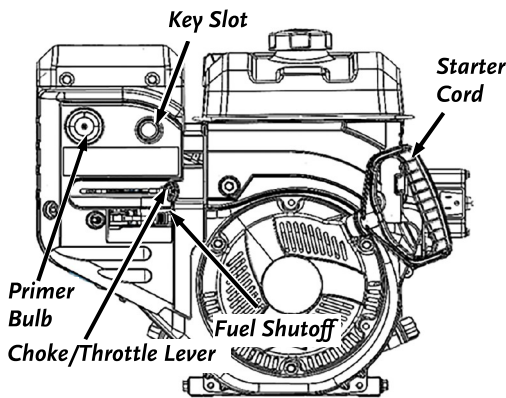

Figure 24

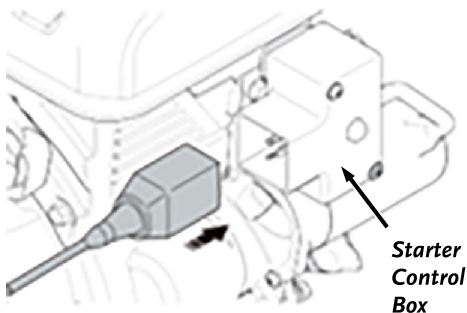

Figure 25

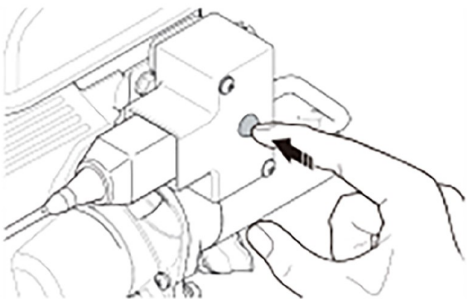

Figure 26

It may be helpful to better familiarize yourself with the features of your SNOW BLOWER by reviewing **Figure 2** in Chapter 2 before beginning the steps outlined in this chapter.

### **! WARNING**

Read and understand all warnings listed in “Chapter 2” before operating this SNOW BLOWER.

#### **Starting the Engine (Manual Start)**

1. Set Wheel Speed to lowest Forward Setting.
2. Insert Key into Key Slot (**Figure 24**).
3. Set Fuel Shutoff Switch to ON.
4. Move the Choke/Throttle Control Lever to the Left “Choke” position.  
*Note: Leave Choke/Throttle Control Lever in the “Run” position if the engine is already warm.*
5. Push in Key to RUN position.
6. Push and release the Primer Bulb 3 times.
7. Slowly pull the Starter Cord until you feel resistance, then pull quickly to start the engine. The Cord will recoil back into position when released.
8. When the Choke is on, the Engine will soon begin to run rough. Adjust the Choke to the Right until the engine runs smoother. Continue this process until the engine runs well with the Choke Lever fully in the run position.

**Note:** Ensure that the Choke/Throttle Control Lever is always in the “Run” position before operating the machine.

#### **Starting the Engine (Electric Start)**

### **! WARNING**

Read and understand the warnings listed in Chapter 2 “Safety with Extension Cords” before connecting the Extension Cord.

1. Set wheel speed to lowest Forward Setting.
2. Insert the Key into the Key Slot (**Figure 24**).
3. Set Fuel Shutoff Switch to ON.
4. Move the Choke Control Lever to the left “choke” position.  
*Note: Leave Choke/Throttle Control Lever in the “Run” position if the engine is already warm.*
5. Push in Key to RUN position.
6. Push and release the Primer Bulb 3 times.
7. Connect the required Heavy-Duty extension cord into the SNOW BLOWER Control Box (**Figure 25**) and plug the Extension cord into a 120V outlet. Use an outdoor rated extension cord shorter than 50 feet (15m).
8. Push and hold the Starter Button on the SNOW BLOWER Control Box until the Engine starts and then release the Button (**Figure 26**).

**NOTICE:** Do not push the Starter Button more than 10 times at intervals of 5 seconds on/ 5 seconds off. If the Engine will not start, see the Troubleshooting section in Chapter 5 of this manual.

9. When the Choke is on, the Engine will soon begin to run rough. Adjust the Choke to the right until the engine runs smoother. Continue this process until the engine runs well with the Choke/Throttle Control Lever fully in the “Run” position.

**Note:** Ensure that the Choke/Throttle Control Lever is always in the “Run” position before operating the machine.

## Stopping the Engine

1. Move Choke/Throttle Control Lever fully to the Right.
2. Pull the Key out of the Key Slot to stop the Engine (**Figure 24**).

## Operating the DR SNOW BLOWER

### NOTICE

Remember to always engage the Auger for 15 seconds before shutting down the SNOW BLOWER. This will remove any remaining snow/ice and prevent the Auger from becoming frozen to the Housing. Attempting to run the Auger when frozen to the Housing will damage the Auger Belt.

1. Make sure the SNOW BLOWER Auger is clear of snow/ice before starting the Snow Blower (**Figure 27**).
2. Start the Engine as described on the previous page.
3. After the Engine has warmed up, set the Choke/Throttle Control Lever to Maximum Speed.
4. Move the Shift Lever to the desired gear (see “Selecting Gears” in the next section).
5. Always start the SNOW BLOWER Auger first before moving forward by pushing the Auger Control Lever down to the Handle.

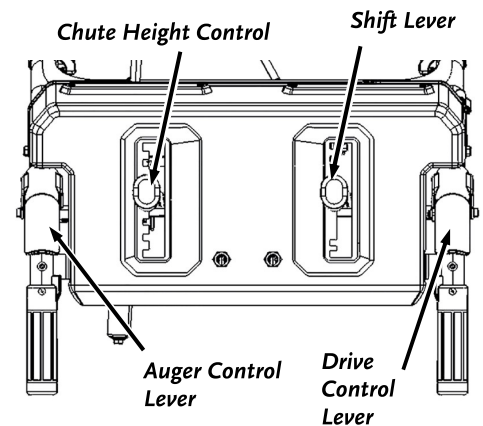

**Figure 27**

### NOTICE

- If the Auger strikes a foreign object or if your machine should start making an unusual noise or vibration, immediately release the Levers, stop the engine and wait for all moving parts to come to a complete stop. Inspect for any damage and repair or replace any damaged parts before restarting and operating the machine.
- Never use DR Blower as a snowplow. Do not push the snow; let the SNOW BLOWER work its way through the snow.
- If the ground speed of the machine is too fast, release the Drive Control Lever and shift to a slower speed to prevent the discharge chute from becoming overloaded and clogged.
- In deeper snow you can raise the SNOW BLOWER by pushing down on the handlebars to remove some of the top layer of snow first, or take a half-width pass. A second or third pass will remove the remaining snow much easier.

6. Gently squeeze the Drive Control Lever to engage the Wheels.

**NOTICE:** When both the Drive and Auger Levers are engaged, they will **both need to be released** to disengage the Drive and stop the machine from moving forward.

7. Upon completion of your work, allow the Auger to operate for 15 seconds to remove buildup and prevent icing within the Housing.
8. Release the Drive and Auger Levers, reduce throttle setting, and pull out the Key to turn off the engine.

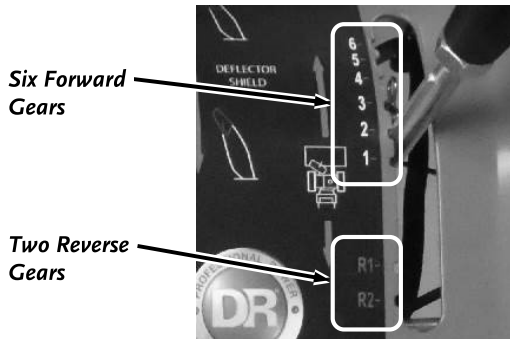

Figure 28

### Selecting Gears

- The SNOW BLOWER has six forward gears (**Figure 28**) that are labeled 1 (slowest) to 6 (fastest).
- There are two reverse gears that are labeled R1 (slowest) to R2 (fastest).

### **! WARNING**

Always ensure the Drive Control Lever is released before shifting gears to prevent damage to the machine and possible injury to the operator.

### Changing the Discharge Chute Rotation

The Discharge Chute Rotation can be set to any position within a 190 degrees radius for ease of snow removal.

1. Rotate the Chute Rotation Knob until the desired angle is achieved (**Figure 32**). Rotate clockwise to rotate the Chute to the right. Rotate counterclockwise to rotate the Chute to the left.

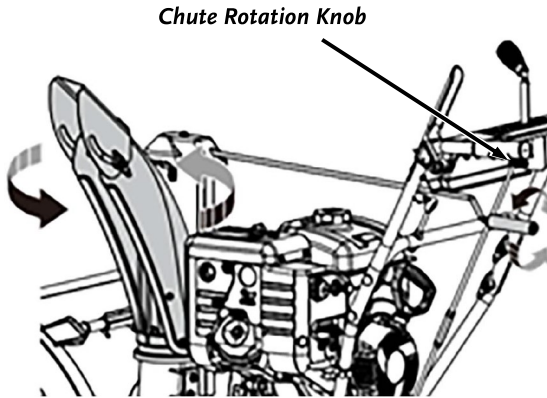

Figure 32

### Changing the Chute Height

The angle of the top portion of the Chute can be adjusted up or down to change the distance that the snow is being thrown.

1. Move the Chute Height Control forward to lower the Chute Deflector for Blowing the snow shorter distances (**Figure 27**).
2. Move the Chute Height Control back to raise the Chute Deflector for longer distances.

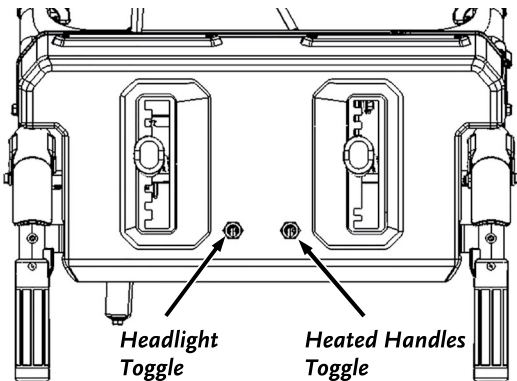

Figure 33

### Operating the Heated Grips

1. Move the Toggle to the forward (ON) position to turn on the Heated Grips (**Figure 33**).
2. Move the Toggle to the rear (OFF) position to turn off the Heated Grips.

### Operating the LED Headlight

1. Move the Toggle to the forward (ON) position to turn the Headlight on (**Figure 33**).
2. Move the Toggle to the rear (OFF) position to turn the Headlight off.

### Adjusting the Skid Shoes

The Skid Shoes can be adjusted to work best with the surface you are working with. For smooth pavement without defects, the Skid Shoes can be set to the lowest position. For gravel surfaces, you should raise the Skid Shoes to a height that allows the most snow to be removed without disturbing the gravel surface.

1. Loosen the two Lock Nuts (**Figure 34**).
2. Position the Skid Shoes to the desired height and tighten Lock Nuts.

**Note:** Both Skid Shoes should be set at the same height.



Figure 34

## Clearing out a Clog in the Auger and Discharge Chute

### **WARNING**

Before clearing out a clog, stop the engine, remove the Safety Key, and wait five minutes to allow all parts to cool.

1. Use the Shovel that is secured to the top of the Auger Housing when clearing snow from the Discharge Chute or Auger Housing (**Figure 35**).
2. Start the machine to clean out remaining material and repeat cleaning process as needed until snow discharges freely.



**Figure 35**

## Chapter 4: Maintaining the DR SNOW BLOWER

Regular maintenance is the way to ensure the best performance and long life of your machine. Please refer to this Manual and the Engine Manufacturer's Owner's Manual for maintenance procedures. Service intervals listed in the checklist below supersede those listed in the Engine Manufacturer's Owner's Manual.

### **! WARNING**

Before performing any maintenance procedure or inspection, stop the Engine, remove the Safety Key, and wait five minutes to allow all parts to cool.

### Regular Maintenance Checklist

PROCEDURE	BEFORE EACH USE	EVERY 5 HOURS	EVERY 25 HOURS	EVERY 50 HOURS
Check Engine Oil Level (add as needed)	▲			
Check General Equipment Condition	▲			
Check Auger and Impeller (If they are excessively worn or damaged)	▲			
Check Auger Shear Bolts (replace as needed)	▲			
Clean Engine Exterior & Cooling Fins	▲			
Check condition of belts (replace as needed)	▲			
Lubricate Chute Gear Flange		▲		
Lubricate Traction Drive Chain			▲	
Lubricate Cables (SAE 30 Oil)			▲	
Change Engine Oil		1 <sup>st</sup> time 5 hours	▲	
Replace Spark Plug				▲

### Removing and Replacing the Engine Oil

#### Tools and Supplies Needed:

- 10mm Wrench (PRO 24B)
- 12mm Wrench (PRO 28B and PRO XL30B)
- Rags and approved Container (for waste oil)
- Small Funnel
- Engine Oil (see your Engine Manual for Oil specifications)

### NOTICE

The Frame and Engine must be level to get an accurate reading when adjusting the oil level.

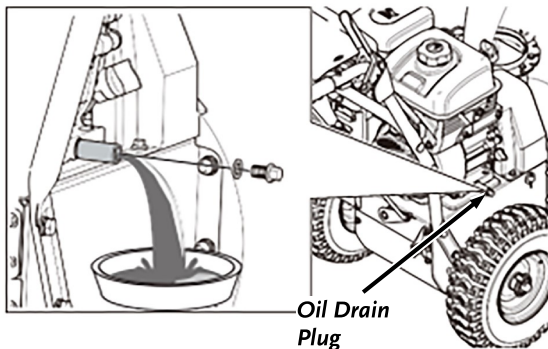

Figure 36

1. Position the machine so the Frame and Engine are level and place a Waste Oil Container under the Oil Drain Plug (**Figure 36**).
2. Remove the Engine Key.
3. Remove the Oil Drain Plug and tip unit to the side to drain the Oil into the Container.
4. Replace the Oil Drain Plug when all Oil has drained.



## NOTICE

- Fill the Oil reservoir slowly, checking the level frequently to avoid overfilling.
- To get an accurate reading when checking the oil level:
  - The Engine must be level.
  - The Oil Fill/Dipstick should not be screwed down to ensure an accurate oil level reading.

5. Remove the Oil Fill/Dipstick and initially add 3/4 of oil (type of oil recommended by the Engine Manufacturer) into the Oil Fill and wait one minute for the oil to settle (**Figure 37**).
6. Insert the Oil Fill/Dipstick without screwing all the way in and then remove to check the level.
7. Continue adding a few ounces of oil at a time, rechecking the Oil Fill/Dipstick until the oil reaches the fill mark. Be careful not to overfill.
8. When full, insert Oil Fill/Dipstick completely and tighten cap.

### Checking and Replacing the Auger Shear Pins

Check the condition of the Shear Pins by removing them from the Auger Shafts. If the Shear Pins are worn excessively, or if they are broken or missing from the Auger Shaft, they must be replaced.

#### Tools and Supplies needed:

- Safety Glasses
- Small Punch
- Hammer
- Shear Pin
- Cotter Pin
- Shear Bolt
- Jam Nut

#### Checking

1. Remove the Cotter Pin securing each Auger Shear Pin (**Figure 38**).
2. Remove the Auger Shear Pins and inspect condition.
  - If the Auger Shear Pins are not worn excessively or damaged, they can be reinstalled.
  - If the Shear Pins are worn excessively or damaged, replace as described in the following steps.

#### Replacing

1. If you cannot see the Shear Bolt hole, you will need to turn the Auger until the holes in the Auger and Auger Shaft line up.
2. If the Shear Bolt ends are sheared off, you may need to use the Punch to push the remainder of the Shear Bolt out.
3. Once the holes are aligned and clear, the new Shear Bolts and Cotter Pins can be installed.

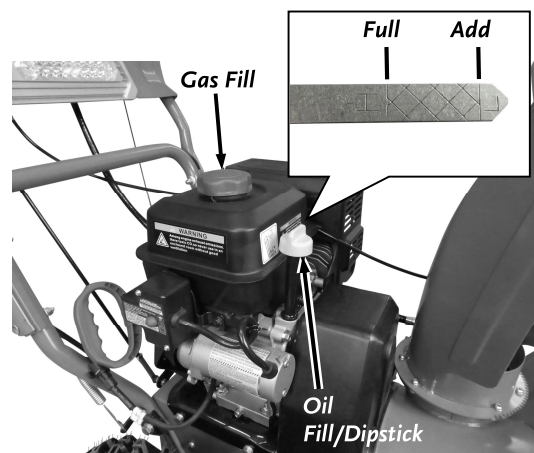

Figure 37

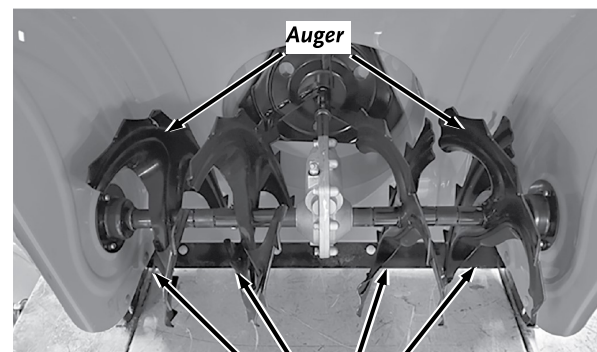

Figure 38

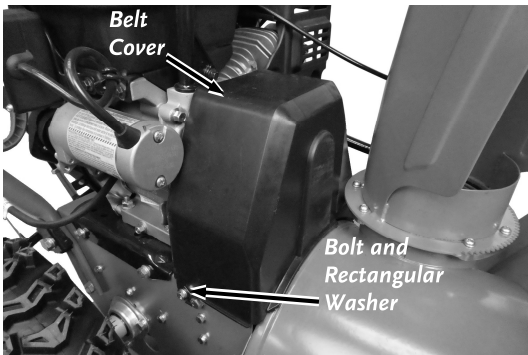

Figure 39

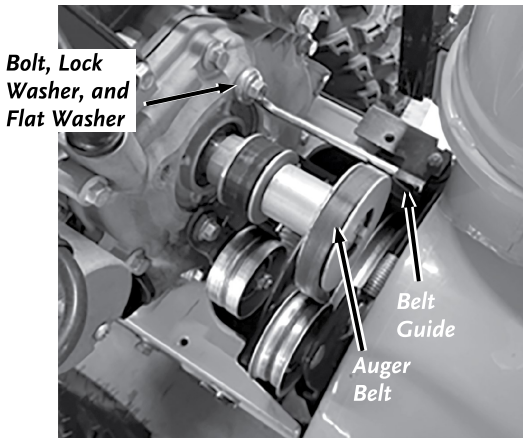

Figure 40

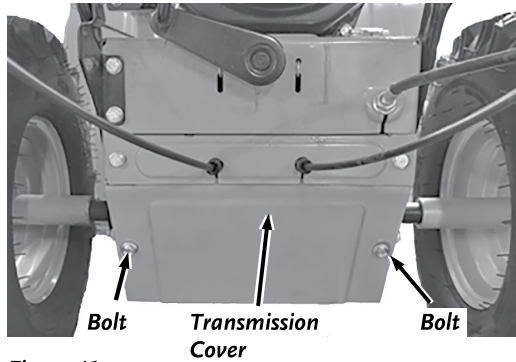

Figure 41

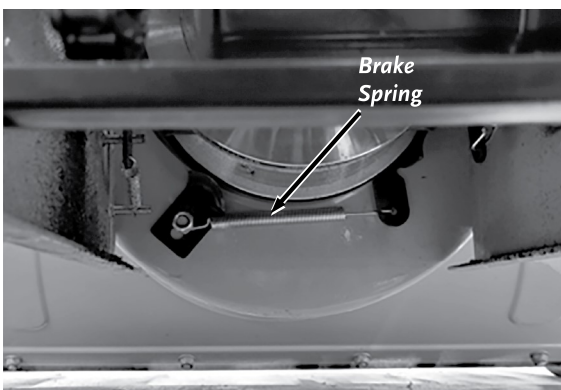

Figure 42

## Replacing the Auger Belt (PRO 24B Model)

The PRO 28B and PRO XL30B Models use two (2) Belts to drive the Auger.

### Tools and Supplies needed:

- 10mm Wrench
- 13mm Wrench
- Pliers
- One new DR Belt

1. Remove the two Bolts and rectangular Washers from the Belt Cover using a 10mm Wrench and remove the Belt Cover (**Figure 39**).
  2. Remove the two Bolts, Lock Washers and Flat Washers that secure the Belt Guide to the Engine using a 13mm Wrench and remove the Belt Guide (**Figure 40**).
  3. Remove the six Bolts that secure the Transmission Cover using a 10mm Wrench and Remove the Transmission Cover (**Figure 41**). This will allow you to guide the Belt off the Auger Pulley from underneath.
  4. Roll the Auger Belt off the front of the Auger Drive Pulley (**Figure 40**).
  5. Remove the Brake Spring from bottom right side of the Frame so the Brake Pad will come away from the Auger pulley, making room for Belt removal (**Figure 42**).
  6. Remove the Belt from the Auger Pulley underneath and pull the Belt up past the rear side of the Pulley to remove it.
  7. Position the new Belt down to the rear side of the Auger Pulley and install the Belt onto the Pulley from underneath making sure the Belt is fully into the Pulley groove.
- Note:** Ensure that the Belt is completely seated into the bottom of the Auger Pulley with the Brake Pad out of the way.
8. Install the Belt onto the Auger Pulley.
  9. Reconnect the Brake Spring to the Frame.
  10. Reinstall the Transmission Cover.
  11. Reinstall the Belt Guide and Belt Cover.

## Replacing the Traction Drive Belt

### Tools and Supplies needed:

- 10mm Wrench
- 13mm Wrench
- Pliers
- New DR Belt

1. Remove the two Bolts and rectangular Washers from the Belt Cover using a 10mm Wrench and remove the Belt Cover (**Figure 51**).
2. Loosen bolt securing the Belt Guide using a 10mm wrench. Move Belt Guide away from the Auger Belt (**Figure 52**).
3. Remove the six Bolts that secure the Transmission Cover using a 13mm Wrench and remove the Transmission Cover (**Figure 53**).
4. Roll Auger Belt off the front of the Auger Drive Pulley (**Figure 52**).

*Note: A 10mm wrench can be used on the engine shaft bolt and turned clockwise to aid rolling the belts off the pulley.*

5. Remove the Cotter Pin and Washer from the Drive Pulley Pivot Rod (**Figure 54**).
6. Remove the Drive Pulley Return Spring.
7. Move the Drive Belt off of the Drive Pulley and past the Auger Drive Pulley.
8. Remove the Drive Belt from underneath the unit.
9. Install new Drive Belt onto Drive and Engine Pulleys.
10. Secure the new Drive Pulley Rod Spring.
11. Reinstall the Pivot Rod, Washer, and Cotter Pin.
12. Reinstall the Auger Belt onto the Pulley.
13. Reinstall the Transmission Cover.
14. Reinstall the Belt Guide and Belt Cover.

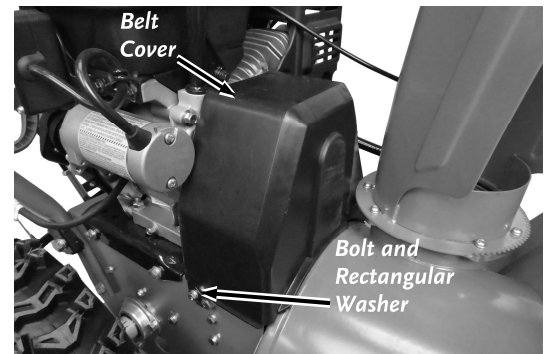

Figure 51

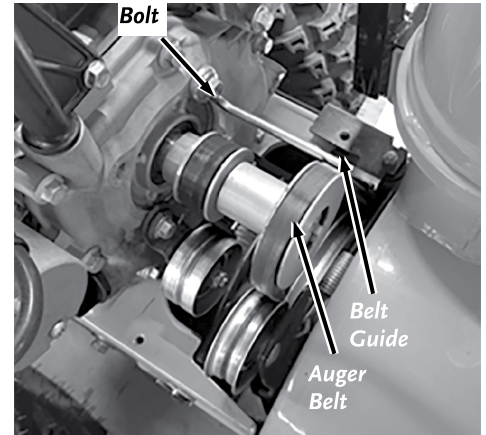

Figure 52

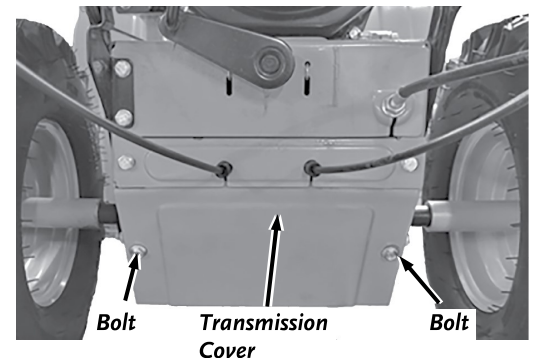

Figure 53

## Replacing the Friction Drive Wheel

### Tools Needed:

- Flat Head Screwdriver
- 10mm Wrench
- Two 13mm Wrenches
- Dead Blow Hammer

### Disassembly

1. Drain the Gas and Oil from the machine before starting these instructions.
2. With the help of another person, tip the SNOW BLOWER onto the Auger Housing (**Figure 54**).
3. Remove the Lynch Pins from the Wheels and remove the Wheels. (**Figure 55**).
4. Remove six Bolts securing the Transmission Cover and remove the Cover (**Figure 53**).
5. Remove Hex Shaft Bolts from the Hex Shaft. Hold the Hex Shaft with a Channel Lock Wrench (**Figure 56**).
6. Remove Hex Shaft Bearings from the Frame.
7. Remove the Hex Shaft, Friction Wheel, Sprocket, and Spacer (**Figure 57**).

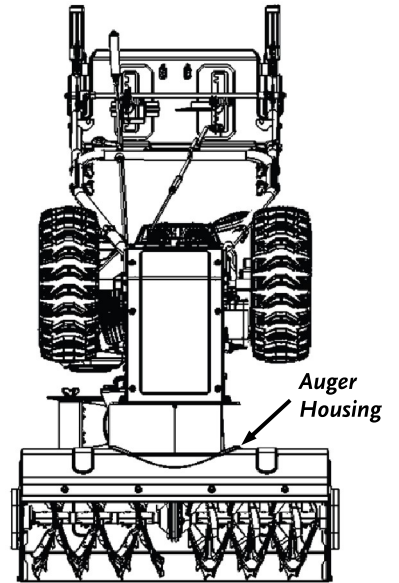

Figure 54

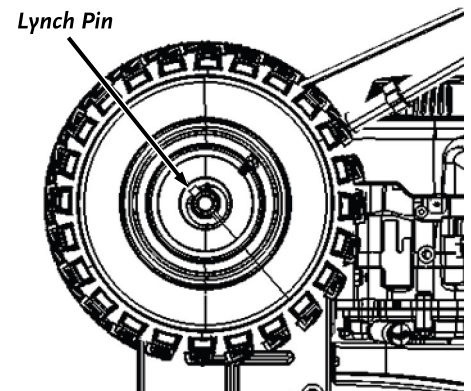

Figure 55

### Assembly

1. Assemble new Friction Wheel, Sprocket, and Spacer onto the Hex Shaft.
2. Install new Assembly into Drive Chain and Bearings.
3. Reinstall and tighten Bolts on Hex Shaft while holding the Hex Shaft with a Channel Lock Wrench.
4. Reinstall the Wheels and the Lynch Pins.
5. Reinstall the Transmission Cover.
6. With assistance, tip the SNOW BLOWER into operating position.
7. Add Oil and Gas to the Engine as described in “Adding Oil and Gasoline” in Chapter 2.

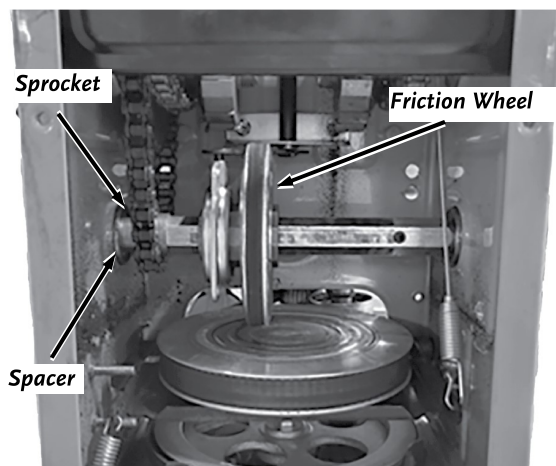

Figure 57

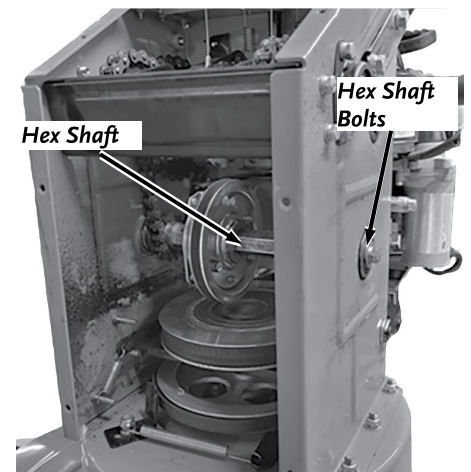

Figure 56

## Chapter 5: Troubleshooting

Most problems are easy to fix. Consult the Troubleshooting Table below for common problems and their solutions. If you continue to experience problems, contact us at [www.DRpower.com](http://www.DRpower.com) or call toll-free 1-800-DR-OWNER (376-9637) for support.

### **WARNING**

Shut down the engine, remove the spark plug wire keeping it away from the Spark Plug and wait 5 minutes for parts to cool before performing any maintenance procedure or inspection on the SNOW BLOWER.

### Troubleshooting Table

SYMPTOM	POSSIBLE CAUSE
<i>Recoil will not pull out or is difficult to pull.</i>	<ul style="list-style-type: none"> <li>⇒ There may be an oil compression lock in the Cylinder. Take out the Spark Plug; hold a rag over the Spark Plug hole and pull the Recoil Cord several times to blow out any oil in the Cylinder. Wipe off the Spark Plug and reinstall it.</li> <li>⇒ Check the Engine oil level; the Engine may be seized.</li> <li>⇒ The Recoil may be broken or jammed. Visit our website at <a href="http://www.DRpower.com">www.DRpower.com</a>.</li> </ul>
<p><i>The Engine will not start.</i></p> <p><i>(Please refer to the Engine Owner's Manual for Engine-specific procedures.)</i></p>	<ul style="list-style-type: none"> <li>⇒ Check the oil and gas level.</li> <li>⇒ Make sure that the Fuel Shut-Off is in the ON position.</li> <li>⇒ Check that the Spark Plug Wire is attached.</li> <li>⇒ The gas may be old; change it if necessary. Use a Fuel Stabilizer if you keep gas longer than one month.</li> <li>⇒ Check the Throttle and Choke settings, adjustment, and travel.</li> <li>⇒ The Spark Plug may be dirty or cracked; change it if necessary. If it's oily, leave it out, hold a rag over the Plug Hole and pull the Recoil Cord several times to blow out any oil in the Cylinder, then wipe off the Plug and reinsert it.</li> <li>⇒ If your Engine still will not start, visit our website at <a href="http://www.DRpower.com">www.DRpower.com</a>.</li> </ul>
<p><i>The Engine lacks power or is not running smoothly.</i></p> <p><i>(Please refer to the Engine Owner's Manual for engine-specific procedures.)</i></p>	<ul style="list-style-type: none"> <li>⇒ Make sure the Choke/Throttle Control Lever is all the way off.</li> <li>⇒ The Spark Plug may be dirty or cracked; change it if necessary.</li> <li>⇒ The gas may be old; change it if necessary. Use a Fuel Stabilizer if you keep gas longer than one month.</li> <li>⇒ The Engine oil may be dirty. Change it if necessary.</li> <li>⇒ Check that the Cooling Fins are clean and free of debris. Clean as needed.</li> <li>⇒ If your Engine still lacks power, visit our website at <a href="http://www.DRpower.com">www.DRpower.com</a>.</li> </ul>
<i>Engine smokes.</i>	<ul style="list-style-type: none"> <li>⇒ Check the Oil Level and adjust as needed.</li> <li>⇒ Clean the Engine Cooling Fins and the Carburetor Housing if they are dirty.</li> <li>⇒ You may be using the wrong oil. Refer to your Engine Owner's Manual for detailed information.</li> <li>⇒ If the Engine still smokes, visit our website at <a href="http://www.DRpower.com">www.DRpower.com</a>.</li> </ul>



## Troubleshooting Table (Continued)

### **WARNING**

Shut down the engine, remove the spark plug wire and wait 5 minutes before performing any maintenance procedure or inspection on the SNOW BLOWER.

<b>SYMPTOM</b>	<b>POSSIBLE CAUSE</b>
<i>The Engine runs well but the machine is not Blowing Snow.</i>	<ul style="list-style-type: none"><li>⇒ Augers may not be turning. Check Auger Belt/s and Shear Bolts and replace as needed.</li><li>⇒ Impeller may not be turning. Check Impeller Belt and Shear Bolts and replace as needed.</li></ul>
<i>The Wheels are not Turning when the Traction Drive Lever is engaged.</i>	<ul style="list-style-type: none"><li>⇒ Traction Drive Belt is Stretched or worn. Replace the Belt.</li><li>⇒ The Traction Drive Pulley face is dirty or wet. Clean as needed.</li><li>⇒ The Friction Wheel is worn or damaged. Replace as needed.</li></ul>

## Chapter 6: Parts Lists and Schematic Diagrams

---

### **Parts List – HANDLEBAR ASSEMBLY**

**Note:** Part numbers listed are available through DR Power Equipment.

<u>Ref#</u>	<u>Part#</u>	<u>Description</u>	<u>Ref#</u>	<u>Part#</u>	<u>Description</u>
1	A0004756034	Decorative Cover	14	A0004756063	Connecting Rod Adjusting Lever
2	A0004756051	Hex Flng Bolt Enlarged B, M6x12	15	A0004756068	M8 Hex Nut, Type 1, Left Handed
3	A0004756052	Circlip D2.5	16	A0004756069	Linkage, Shift Lower
4	A0004756053	Snow Outlet Rocker	17	A0004756071	Screw, M8x25, Full Thread, GB/T5783
5	A0004763847	Belt Shroud (PRO 28B & PRO XL30B)	18	A0004756073	Spring Washer, M8
5	A0004756054	Belt Shroud (PRO 24B)	19	A0004756074	M8 Lock Nut, Nylon Insert, Type 1
6	A0004756055	Washer M10, Class A			
7	A0004756056	Snow Outlet Rocker Handle			
8	A0004756057	Washer M6, Class A, Large			
9	A0004756058	Washer M8, Class A			
10	A0004756059	Spring, Conn Rod			
11	A0004756060	Cotter Pin, 2 X 25			
12	A0004756061	Linkage, Shift Upper			
13	A0004756062	M8 Hex Nut, Type 1			



**Schematic – HANDLEBAR ASSEMBLY**

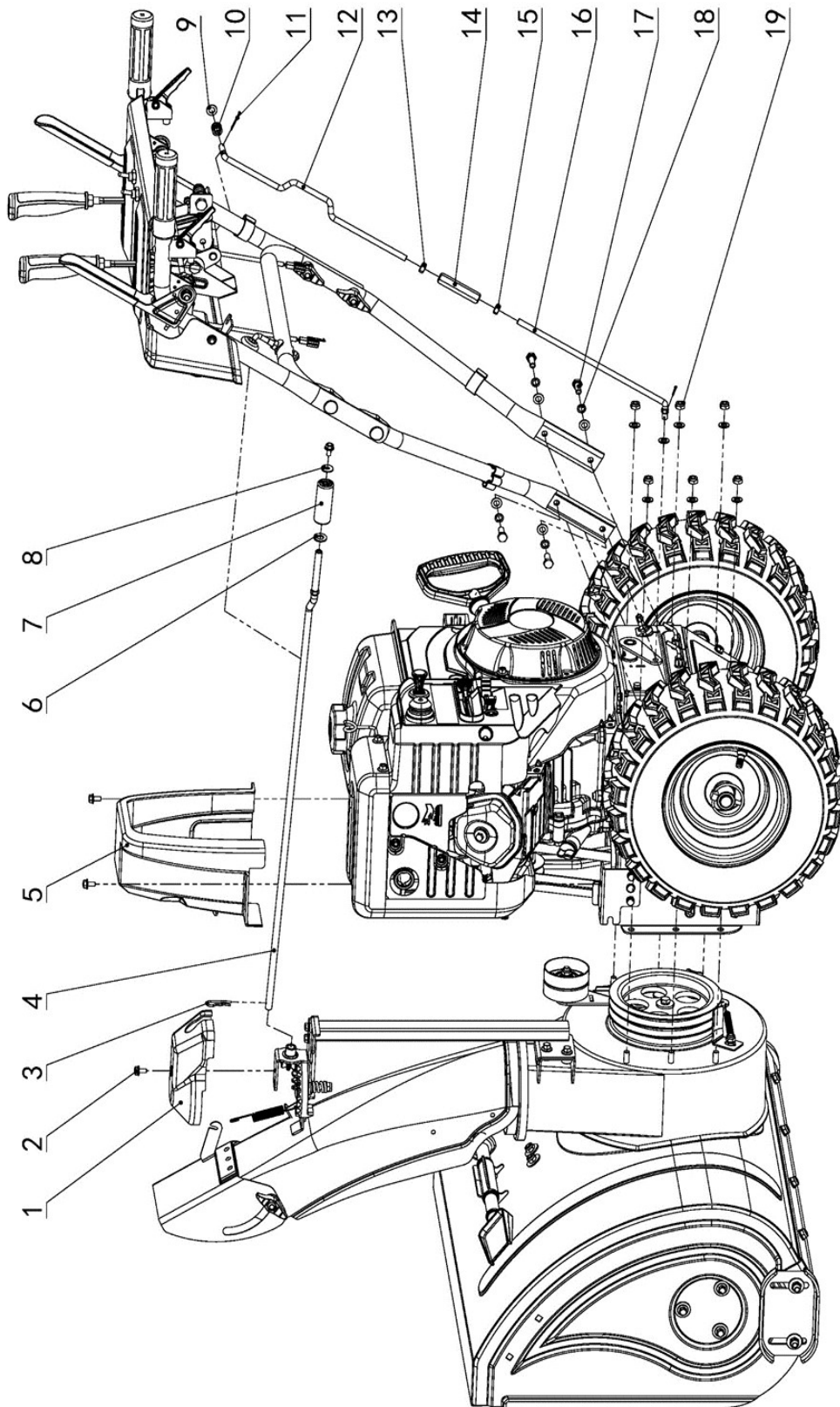

## Parts List – AUGER ASSEMBLY (all models)

**Note:** Part numbers listed are available through DR Power Equipment.

Ref#	Part#	Description	Ref#	Part#	Description
1	A0004756075	Assy, End Cup	28	A0004763884	Key, 6 X 22.5, Type C
2	A0004756076	Gasket, 19.5x34x1.5	29	A0004756058	Washer M8, Class A
3	A0004756077	Left Hand Auger	30	A0004757237	Spring, Auger Belt Tensioner Pulley
4	A0004756081	Adjusting Sleeve, Auger Cage	31	A0004757240	M8 Hex Nut, Thin
5	A0004763904	Fixing Sleeve, Auger Cage (PRO XL30B)	32	A0004763885	Tensioner Block
5	A0004763859	Fixing Sleeve, Auger Cage (PRO 28B)	33	A0004757236	Bearing Seat, Worm
5	A0004756083	Fixing Sleeve, Auger Cage (PRO 24B)	34	A0004763886	Bearing, UB204
6	A0004756087	Circlip D1.8	35	A0004757242	Bolt, M8x12, Flg, Class A, Small Series
7	A0004763905	Assy, Worm Gearbox (PRO XL30B)	36	A0004757244	Bolt, M8 X 25, Square Neck
7	A0004763862	Assy, Worm Gearbox (PRO 28B)	37	A0004757246	Bolt, M8 X 20, Square Neck
7	A0004756099	Assy, Worm Gearbox (PRO 24B)	38	A0004763887	Snow Scraper
8	A0004763866	Safety Pin, D6.1 X 38	39	A0004757247	Bolt, M8 X 16, Square Neck
9	A0004756110	Right Hand Auger	40	A0004757249	Screw, Ppht St 4.2 X 13, Type C
10	A0004763906	Box Connection Panel	41	A0004757248	Cap
11	A0004756111	Pin, Elastic Cylind, 6 X 35			
12	A0004756112	Flat Auger			
13	A0004756113	Skid Shoe			
14	A0004756114	M10 Lock Nut, Nylon Insert, Type1			
15	A0004763907	Auger Housing (PRO XL30B)			
15	A0004763871	Auger Housing (PRO 28B)			
15	A0004757207	Auger Housing (PRO 24B)			
16	A0004757209	Mounting Base, Snow Shovel			
17	A0004757243	Washer M8, Large			
18	A0004756074	M8 Lock Nut, Nylon Insert, Type 1			
19	A0004757213	Snow Shovel			
20	A0004757216	Gasket, 10.2x25x0.5			
21	A0004763875	Pulley Assy, Auger Belt Tensioner (PRO 28B & PRO XL30B)			
21	A0004757222	Pulley Assy, Auger Belt Tensioner (PRO 24B)			
22	A0004757225	Screw, M10 X 14			
23	A0004763880	Pulley, Auger Cage Driven (PRO 28B & PRO XL30B)			
23	A0004757230	Pulley, Auger Cage Driven (PRO 24B)			
24	A0004757232	Washer M8, Oversized			
25	A0004757233	Screw, M8 X 20, Full Thread, GB/T5783			
26	A0004756073	Spring Washer, M8			
27	A0004763883	V-Belt, 4LXA875E (PRO 28B & PRO XL30B)			
27	A0004757235	V-Belt, 4LXA875E (PRO 24B)			

**Schematic – AUGER ASSEMBLY (all models)**

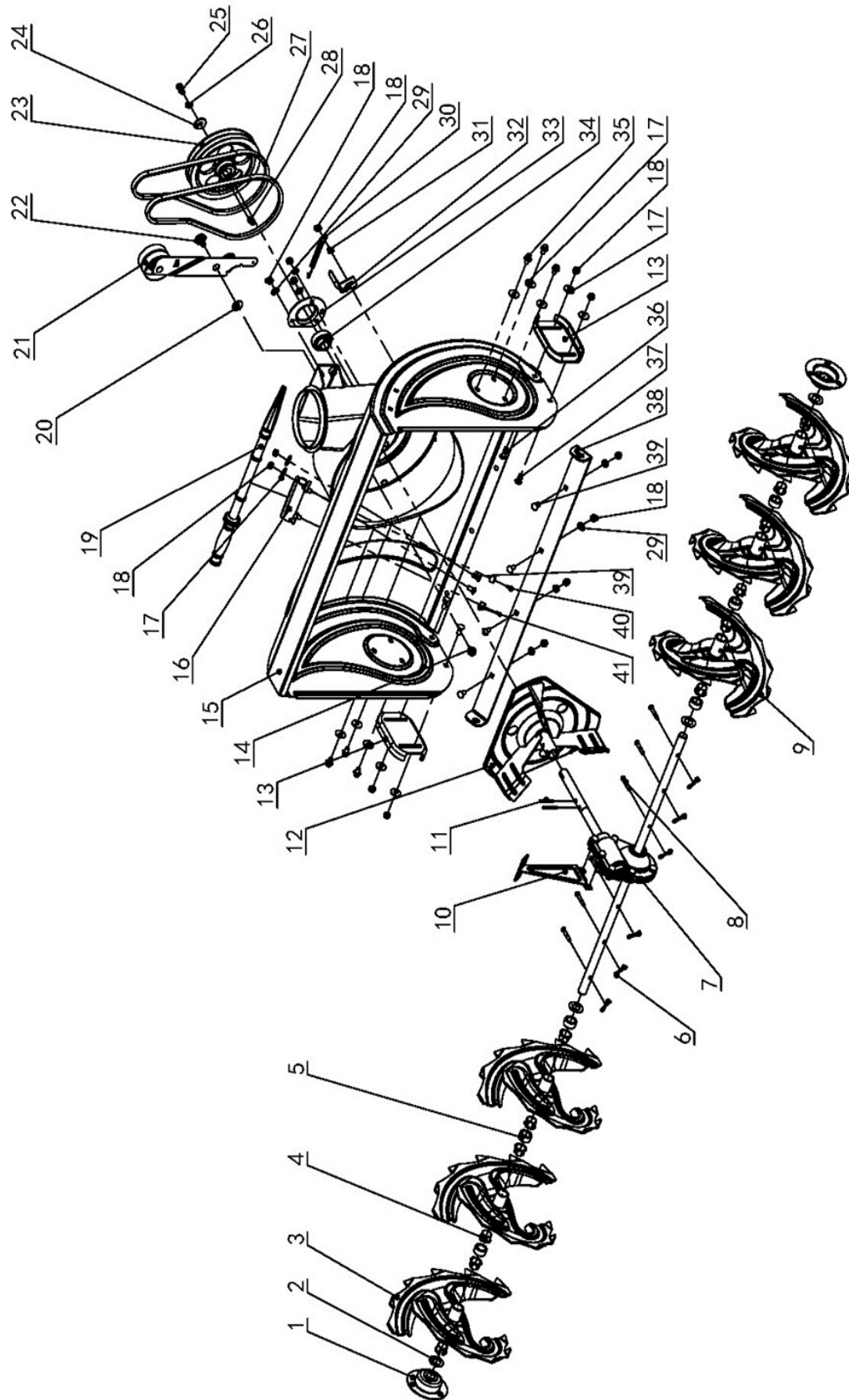

## Parts List – DRIVE ASSEMBLY

**Note:** Part numbers listed are available through DR Power Equipment.

Ref#	Part#	Description	Ref#	Part#	Description
1	A0004757251	Spring, Traveling Driven Pulley	46	A0004763900	Bracket, Rear, Auger Clutch Cable
2	A0004757253	Bracket, Traveling Driven Pulley	47	A0004763678	Screw Assy, M6 X 30
3	A0004763667	M10 Lock Nut, Nylon Insert, Type1	48	A0004763679	Spring, Fork Return
4	A0004757255	Bushing, 13.2 X 19 X 16.5	49	A0004763680	Steering Fork
5	A0004757256	Gasket, 13.5x25x2.5	50	A0004763685	Mounting Block, Steer Fork Shaft, Left
6	A0004757258	Cotter Pin, 2 X 30	51	A0004763901	Tire, 15 X 6.5 – 7L (PRO 28B & PRO XL30B)
7	A0004757259	Bearing, 6203-2rs	51	A0004763681	Tire, 14 X 5 – 6L (PRO 24B)
8	A0004757261	Screw Phillips Round Head, M6 X 12 G4.8	52	A0004757349	Bolt, M8x12, Flg, Class A, Small Series
9	A0004757264	Screw M10 X 12	53	A0004763689	Screw Phillips Round Head, M4 X 35
10	A0004757266	Cover, Slave Synchronize Wheel	54	A0004763690	Chain, 38 Sections - 08a
11	A0004757267	Screw Assy, M6 X 16	55	A0004763691	Sprocket, 28 Teeth - 08a
12	A0004757269	Bearing Seat	56	A0004763693	Steering Fork Shaft
13	A0004757270	Slave Synchronize Wheel	57	A0004763692	Steering Clutch Arm
14	A0004757271	Screw, M8 X 20, Full Thread, GB/T5782	58	A0004763695	M4 Lock Nut, Nylon Insert, Type1
15	A0004756073	Belt, 5m_HTD-750	59	A0004763696	Key, 5 X 5 X 22, Type A
16	A0004757243	Washer M8, Large	60	A0004763697	Shaft
17	A0004757273	Belt, 5m_HTD-750	61	A0004763698	Bushing, 15.2 X 20 X 72
18	A0004757274	Bearing, 6301-2rs-Nr	62	A0004763699	Bracket
19	A0004757275	Ring, D14	63	A0004763701	Bushing, 17.2 X 22 X 14.5
20	A0004763888	Tire, 15 X 6.5 - 7r (PRO 28B & PRO XL30B)	64	A0004763703	Sprocket, 10 Teeth – 08A
20	A0004757276	Tire, 14 X 5 - 6r (PRO 24B)	65	A0004763704	Bearing, 6002-2RS-NR
21	A0004757277	Pin, D6 X 45	66	A0004763707	Screw Hwht M6 X 12
22	A0004757278	Gasket, 14.2x28x2	67	A0004763710	Ring, D35, Type A
23	A0004757279	Gearshift Fork	68	A0004763711	Case Cover
24	A0004757280	Mounting Block, Fork	69	A0004763712	Shift Fork Cover
25	A0004757281	Bolt, M8x25, Flg, Class A, Small Series	70	A0004763713	Gasket, 16.2 X 30 X 2
26	A0004757283	Mounting Block, Steer Fork Shaft, Right	71	A0004763714	Sprocket, 18 Teeth – 08A
27	A0004763889	Gasket, 9x36x3	72	A0004763715	Ring, Rubber, Friction Wheel
28	A0004763890	Active Pulley, Auger Cage (PRO 28B & PRO XL30B)	73	A0004763716	Bushing, 17.2 X 22 X 38.3
28	A0004757288	Active Pulley, Auger Cage (PRO 24B)	74	A0004763717	Cover, Friction Wheel
29	A0004757289	Bolt, M8x20, Flg, Class A, Small Series	75	A0004763718	Planetary Gears Assy
30	A0004763891	Cover, Active Synchronize Wheel	76	A0004763719	Bushing, Friction Wheel
31	A0004757327	Bolt, M8x16, Flg, Class A, Small Series	77	A0004763720	Ring, D15, Gb896
32	A0004763892	Traceling Belt Tensioner Pulley Assy	78	A0004763722	Key, 5 X 6.5 X 16, Half Round
33	A0004763893	Active Synchronous Pulley	79	A0004763721	Flat Washer, M6, Class A
34	A0004757322	Bracket Pad, 8.5 X 15 X 6	80	A0004763723	Lock Washer, M6
35	A0004763894	Key, 7 X 7 X 70, Type B	81	A0004763724	Screw, M6 X 12
36	A0004763895	Belt Tensioner (PRO 28B & PRO XL30B)	82	A0004763725	Chain, 28 Sections – 08A
36	A0004757328	Belt Tensioner (PRO 24B)	83	A0004763726	Pin, D6 X 28
37	A0004757326	Spring, Traveling Belt Tensioner Pulley	84	A0004763727	Axle, Friction Wheel
38	A0004763908	Engine, W420fse/P Snow Blower (PRO XL30B)	85	A0004763728	Axle, Travel
38	A0004763896	Engine, W420FSE/P Snow Blower (PRO 28B)	86	A0004763729	Bearing, 6203-2RS-NR
38	A0004757332	Engine, W420FSE/P Snow Blower (PRO 24B)	<b>Not Shown</b>		
39	A0004757330	M8 Hex Nut, Type 1	A0004763672	M6 Lock Nut, Nylon Insert, Type 1 (PRO 24B)	
40	A0004757331	Lasso Wire Seat, Short	A0004763673	Bracket, Front, Auger Clutch Cable (PRO 24B)	
41	A0004756055	Washer M10, Class A	A0004763674	Pulley, Lasso (PRO 24B)	
42	A0004757350	Lasso Bracket	A0004763675	Shaft, M6 X 10, Lasso Pulley (PRO 24B)	
43	A0004757351	Pin, Elastic Cylind, 6 X 22			
44	A0004763669	Shift Linkage Arm			
45	A0004763909	Traveling Case			

**Schematic – DRIVE ASSEMBLY**

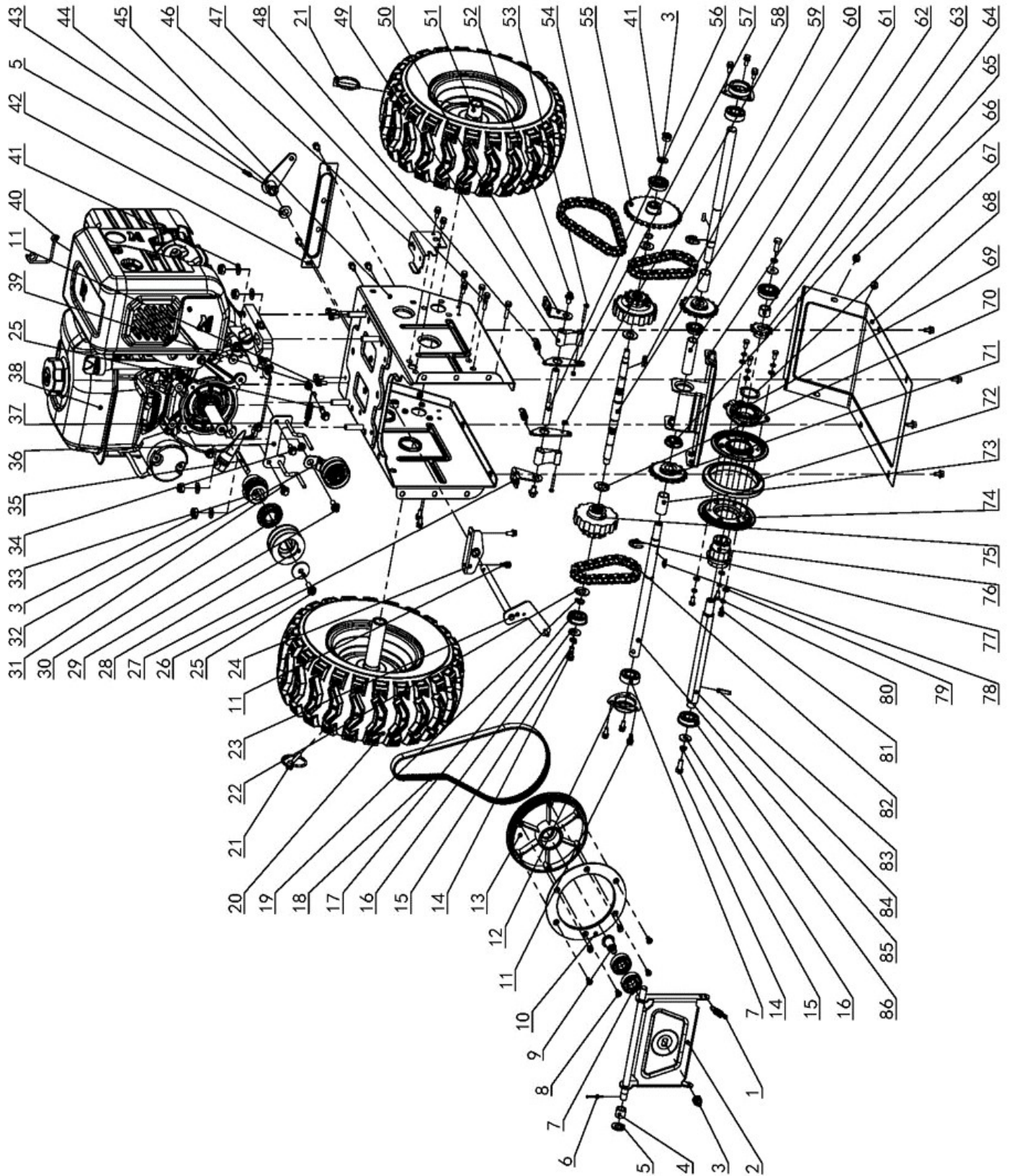



## Parts List – CONTROL PANEL ASSEMBLY

**Note:** Part numbers listed are available through DR Power Equipment.

<u>Ref#</u>	<u>Part#</u>	<u>Description</u>	<u>Ref#</u>	<u>Part#</u>	<u>Description</u>
1	A0004763730	Cable, Steering Clutch	32	A0004763765	Screw Phillips Round Head, M5 X 8
2	A0004763731	Assy, Clutch Handle	33	A0004763766	Twist Switch
3	A0004763732	Self-Locking Coupling Sleeve	34	A0004763767	Bolt, M10 X 50
4	A0004763733	Handle Panel	35	A0004763768	Bushing, 11 X 20 X 5
5	A0004763734	Clamp, D25	36	A0004756058	Washer M8, Class A
6	A0004763735	Hex Flng Bolt Enlarged B, M6x35	37	A0004763771	Joystick, Snow Cap
7	A0004763736	Bolt, M8 X 50	38	A0004763772	Spring, Gear Pressure
8	A0004756074	M8 Lock Nut, Nylon Insert, Type 1	39	A0004756060	Cotter Pin, 2 X 25
9	A0004763672	M6 Lock Nut, Nylon Insert, Type 1	40	A0004756114	M10 Lock Nut, Nylon Insert, Type1
10	A0004763737	Screw, Ppht St 3.5 X 16, Type C	41	A0004763773	Handle, Gear Shift
11	A0004763738	Shaft, Interlock, Long	42	A0004763775	M10 Hex Nut, Type 1
12	A0004763739	Lasso, Travel Clutch	43	A0004763793	Lever, Gear Shift
13	A0004763740	Lasso, Snow Cap Adjustment	44	A0004763794	Returen Torsion Spring
14	A0004763741	Frame, Lower Arm	45	A0004763795	Frame, Right Arm
15	A0004763742	Armrest, Handle Locking	46	A0004763796	Pin, Elastic Cylind, 3 X 16
16	A0004763743	Arc Washer, D8	47	A0004763797	Screw Phillips Round Head, M5 X 12
17	A0004756062	M8 Hex Nut, Type 1	48	A0004763802	M5 Lock Nut, Nylon Insert, Type1
18	A0004763744	Retainer, Rocker			
19	A0004763745	Retaining Sleeve, Rocker			
20	A0004763746	Tie, L150mm			
21	A0004763747	Harness, W210FSE/P			
22	A0004763748	Cam Sleeve, New			
23	A0004763902	Frame, Left Arm			
24	A0004763750	Led Light			
25	A0004763751	Steering Handle			
26	A0004763752	Rivet, 4 X 12, GB/T12618			
27	A0004763753	Heatable Handle			
28	A0004763754	Screw Shc M6 X 35, GB/T70.2			
29	A0004763903	Cable, Auger Clutch (PRO 28B & PRO XL30B)			
29	A0004763755	Cable, Auger Clutch (PRO 24B)			
30	A0004763758	Clasp, Metal			
31	A0004763763	Assy, Clutch Handle W/ Limit			

**Schematic – CONTROL PANEL ASSEMBLY**

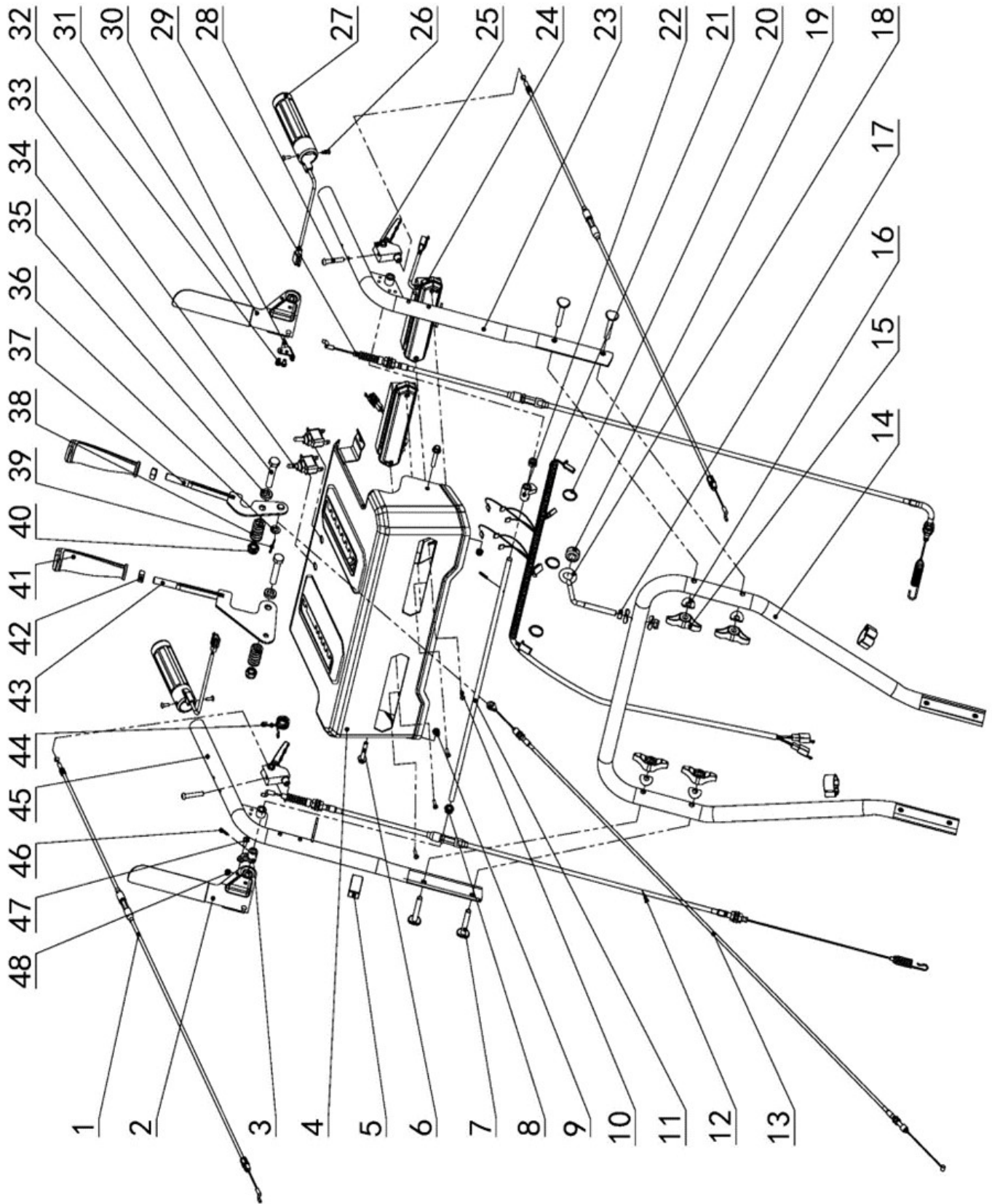



## Parts List and Schematic – CHUTE ASSEMBLY (all models)

**Note:** Part numbers listed are available through DR Power Equipment.

Ref#	Part#	Description	Ref#	Part#	Description
1	A0004763803	Ring, Shock Absorber, Snow Chute	13	A0004763813	Steering Gear
2	A0004763742	Armrest, Handle Locking	14	A0004763814	Mounting Base, Rocker
3	A0004757244	Bolt, M8 X 25, Square Neck	15	A0004757335	Hex Flng Bolt Enlarged B, M6x12
4	A0004757243	Washer M8, Large	16	A0004763815	Gasket, 16.2x24x0.8
5	A0004763804	Remote Control, Snow Chute	17	A0004763823	Ring, D15, Type A
6	A0004763752	Rivet, 4 X 12, GB/T12618	18	A0004763825	Mounting Block, Rocker
7	A0004763807	Bolt, M8x16, Flg, Class A, Small Series	19	A0004763826	Steering Rack
8	A0004763805	Rubber, Snow Chute	20	A0004763827	Connection Plate
9	A0004763806	Hinge, Snow Chute	21	A0004763828	Gasket, 8x30x3
10	A0004763810	Remote Control, Snow Cap	22	A0004763829	Compression Spring
11	A0004763811	Tension Spring, Snow Chute	23	A0004756074	M8 Lock Nut, Nylon Insert, Type 1
12	A0004763812	Bolt, M8 X 50, Square Neck	24	A0004763830	Chute Rotation Support

### Not Shown

423751

Label, Chute Warning

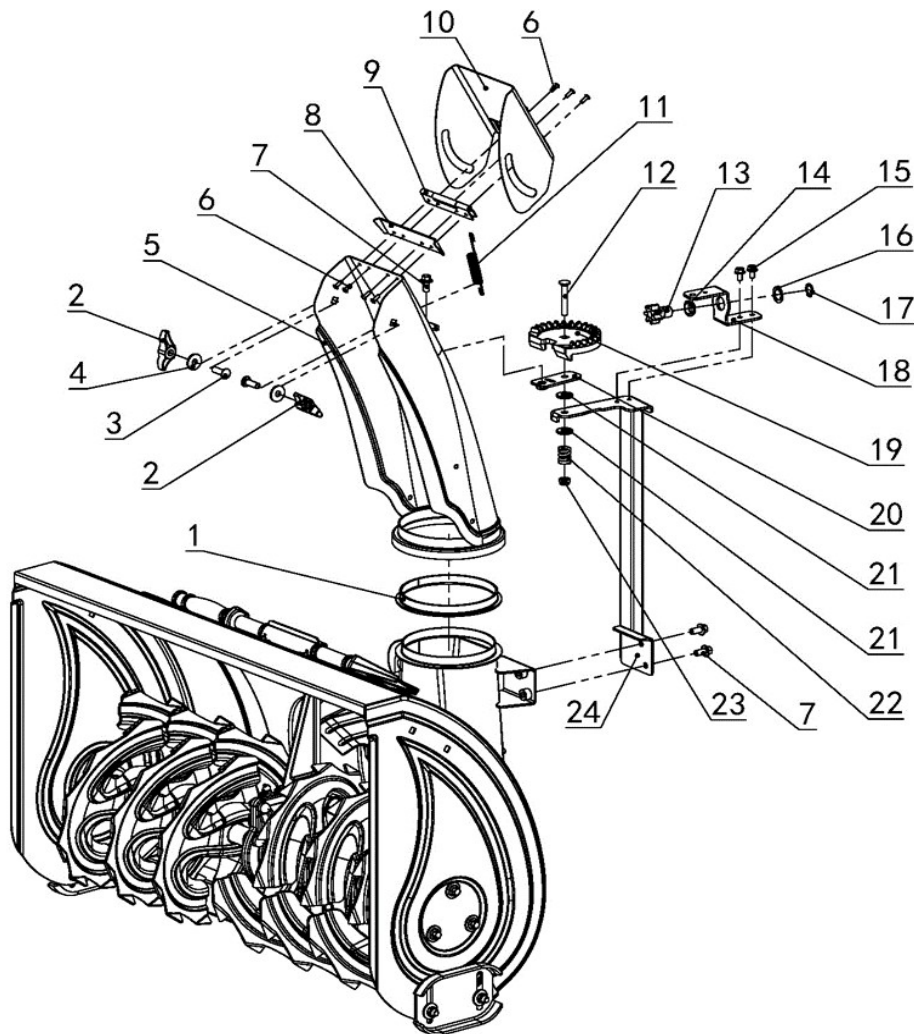

**Notes:**

# DR<sup>®</sup> SNOW BLOWER

---



## 2-Year Limited Warranty

### Terms and Conditions

The DR<sup>®</sup> SNOW BLOWER is warranted for two (2) years against defects in materials or workmanship when put to ordinary and normal consumer use; ninety (90) days for any other use.

For the purposes of all the above warranties, "ordinary and normal consumer use" refers to non-commercial residential use and does not include misuse, accidents or damage due to inadequate maintenance.

DR Power Equipment certifies that the DR<sup>®</sup> SNOW BLOWER is fit for ordinary purposes for which a product of this type is used. DR Power Equipment however, limits the implied warranties of merchantability and fitness in duration to a period of two (2) years in consumer use, ninety (90) days for any other use.

The 2-Year Limited Warranty on the DR<sup>®</sup> SNOW BLOWER starts on the date the machine ships from our factory. The 2-Year Limited Warranty is applicable only to the original owner.

The warranty holder is responsible for the performance of the required maintenance as defined by the manufacturer's owner's manuals. The warranty holder is responsible for replacement of normally wearing parts such as the Belts, Spark Plug, and Shear Bolts. Accessories to the machine are not covered by this warranty.

During the warranty period, the warranty holder is responsible for the machine transportation charges, if required. During the warranty period, warranty parts will be shipped by standard method at no charge to the warranty holder. Expedited shipping of warranty parts is the responsibility of the warranty holder.

SOME STATES DO NOT ALLOW LIMITATIONS ON THE LENGTH OF IMPLIED WARRANTIES, SO THE ABOVE LIMITATIONS MAY NOT APPLY TO YOU.

DR Power Equipment shall not be liable under any circumstances for any **incidental or consequential damages or expenses** of any kind, including, but not limited to, cost of equipment rentals, loss of profit, or cost of hiring services to perform tasks normally performed by the DR<sup>®</sup> SNOW BLOWER.

SOME STATES DO NOT ALLOW THE EXCLUSION OR LIMITATION OF INCIDENTAL OR CONSEQUENTIAL DAMAGES, SO THE ABOVE LIMITATIONS MAY NOT APPLY TO YOU.

THIS WARRANTY GIVES YOU SPECIFIC LEGAL RIGHTS, AND YOU ALSO HAVE OTHER RIGHTS, WHICH VARY FROM STATE TO STATE.

## Daily Checklist for the DR SNOW BLOWER

To help maintain your DR SNOW BLOWER for optimum performance, we recommend you follow this checklist each time you use your SNOW BLOWER.

---

### WARNING

Before performing any maintenance procedure or inspection, stop the engine, wait five minutes to allow all parts to cool, disconnect the spark plug wire, keeping it away from the spark plug.

---

- Check the Engine Oil and Gas Tank level.
- Check that Engine is clean of debris.
- Check the general condition of the SNOW BLOWER, e.g.; nuts, bolts, welds, etc.
- Check Belts for wear and damage.
- Check Tire wear.
- Check the Auger and Shear Bolts for wear and damage.
- Check the Frame for wear and damage.
- Clean inside of Auger Housing with the supplied Shovel.

## End of Season and Storage

---

### WARNING

Before performing any maintenance procedure or inspection, stop the engine, wait five (5) minutes to allow all parts to cool. Disconnect the spark plug wire, keeping it away from the spark plug.

---

- Change the Engine Oil.
- Check the Auger and Shear Bolts for wear and damage.
- If your DR SNOW BLOWER will be idle for more than 30 days, we recommend using a Gas Stabilizer. This will prevent sediment from gumming up the Carburetor. If there is dirt or moisture in the gas or tank, remove it by draining the tank. Completely fill the tank with fresh, unleaded gas and add the appropriate amount of stabilizer or gasoline additive. Run the Engine for a short time to allow the additive to circulate.
- Clean the exterior of the unit to remove all dirt, grease, and any other foreign material. To prevent rust, touch up painted surfaces that have been scratched or chipped.
- Be sure all nuts, bolts, and screws are securely fastened.
- Inspect moving parts and the Belts for damage and wear; replace if necessary.
- Remove the Spark Plug and pour about 1 ounce of motor oil into the Cylinder hole. Replace the Plug and crank the Engine over a couple of times using the Pull Cord, or the Electric Starter. This will coat the piston and seat the valves to prevent moisture buildup.
- If possible, store the SNOW BLOWER in a dry, protected place. If it is necessary to store the SNOW BLOWER outside, cover it with a protective material (especially the Engine).



---

800 HINESBURG ROAD, SOUTH BURLINGTON, VERMONT 05403